

DEPARTMENT OF THE ARMY TECHNICAL MANUAL

DIRECT SUPPORT AND GENERAL SUPPORT MAINTENANCE MANUAL

INCLUDING REPAIR PARTS AND SPECIAL TOOLS LISTS

(INCLUDING DEPOT MAINTENANCE

REPAIR PARTS AND SPECIAL TOOLS)

RIFLE, 7.62-MM, M14, W/E

(1005- 589-1271)

RIFLE, 7.62-MM, M14A1, W/E

(1005-072- 5011)

BIPOD, RIFLE, M2

(1005-711-6202)

HEADQUARTERS, DEPARTMENT OF THE ARMY

AUGUST 1972

WARNING

Clear weapon of ammunition before starting an inspection. Point weapon in a safe direction and examine for presence of live ammunition. Check barrel and chamber for obstruction, e.g., bullet or ruptured cartridge case.

WARNING

Personnel operating vapor degreaser are cautioned not to breathe the toxic fume.

WARNING

Drycleaning solvents and paint thinners are flammable. Do not clean parts near an open flame or in a smoking area. Fire extinguishers should be readily available when these materials are used. Use only in well-ventilated places.

WARNING

Dry cleaning solvents and paint thinners evaporate quickly and have a drying effect on the skin. When used without protective gloves, these chemicals may cause irritation or cracking of the skin. Use a lanolin base cream or liquid on exposed skin.

WARNING

Under no circumstances should a blank cartridge be modified by adding explosives in an attempt to obtain automatic action without the blank firing attachment. The loading of any cartridge with excess explosives is most likely to cause abnormal chamber pressure. The resulting abnormal chamber pressure may cause equipment damage and/or injury to the operator.



DIRECT SUPPORT AND GENERAL SUPPORT

MAINTENANCE MANUAL

INCLUDING REPAIR PARTS AND SPECIAL TOOLS LIST

(INCLUDING DEPOT MAINTENANCE

REPAIR PARTS AND SPECIAL TOOLS)

RIFLE, 7.62-MM: M14, W/E

RIFLE, 7.62-MM: M14A1, W/E

BIPOD, RIFLE: M2

This manual is current as of 27 June 1971

| | | | Paragraph | Page | Illus. fig |
|---------|------|--|-----------|------|---------------|
| CHAPTER | 1. | INTRODUCTION | | | |
| Section | I. | General..... | 1-1—1-3 | 3 | 1-1 |
| | II. | Description and data..... | 1-4—1-5 | 3,4 | 1-2 |
| CHAPTER | 2. | DIRECT SUPPORT AND GENERAL SUPPORT INSTRUCTIONS | | | |
| Section | I. | Repair parts, special tools, and equipment | 2-1 | 5 | |
| | II. | Troubleshooting..... | 2-2—2-3 | 5 | |
| | III. | Preembarkation inspection of materiel in units alerted for overseas movement | 2-4 | 6 | 2-1 |
| | IV. | General maintenance | 2-5—2-8 | 8,9 | |
| | V. | Removal and installation of major components and auxiliaries..... | 2-9—2-10 | 9 | |
| CHAPTER | 3. | REPAIR OF MAGAZINE ASSEMBLY | | | |
| Section | I. | Disassembly and assembly | 3-1—3-4 | 11 | 3-1 |
| | II. | Cleaning, inspection and repair | 3-5—3-7 | 11 | |
| CHAPTER | 4. | REPAIR OF THE FIRING MECHANISM | | | |
| Section | I. | Disassembly and assembly | 4-1—4-4 | 13 | |
| | II. | Cleaning, inspection and repair | 4-5—4-7 | 13 | |
| CHAPTER | 5. | REPAIR OF STOCK AND HAND GUARD ASSEMBLIES | | | |
| Section | I. | Disassembly and assembly | 5-1—5-4 | 15 | |
| | II. | Cleaning, inspection and repair | 5-5—5-7 | 15 | |
| CHAPTER | 6. | REPAIR OF THE OPERATING ROD AND CONNECTOR GROUP | | | |
| Section | I. | Disassembly and assembly | 6-1—6-4 | 17 | |
| | II. | Cleaning, inspection and repair | 6-5—6-7 | 17 | |

* This manual supersedes TM 9-1005-223-35, 1 July 1968 including changes.

| | | | Paragraph | Page | Illus. fig |
|----------|------|---|-------------|-----------|---------------------|
| CHAPTER | 7. | REPAIR OF BLOT ASSEMBLY | | | |
| Section | I. | Disassembly and assembly | 7-1—7-4 | 19 | |
| | II. | Cleaning, inspection and repair | 7-5—7-7 | 19,20 | 7-1,7-2, 7-3 |
| CHAPTER | 8. | REPAIR OF BARREL AND RECEIVER GROUP | | | |
| Section | I. | Disassembly and assembly | 8-1—8-4 | 21 | |
| | II. | Cleaning, inspection and repair | 8-5—8-7 | 21— 24 | 8-1,8-2, 8-3,8-4 |
| CHAPTER | 9. | REPAIR OF RIFLE BIPOD | | | |
| Section | I. | Disassembly and assembly | 9-1—9-4 | 25 | 9-1 |
| | II. | Cleaning, inspection and repair | 9-5—9-7 | 25 | |
| CHAPTER | 10. | MAINTENANCE OF MATERIEL USE IN CON- JUNCTION WITH MAJOR ITEM | | | |
| Section | I. | Introduction | 10-1 | 27 | |
| | II. | Grenade Launcher M76..... | 10-2—10-7 | 27 | 10-1 |
| | III. | Grenade Launcher Sight, M15 | 10-8—10-14 | 28 | 10-2,10-3, 10-4 |
| | IV. | Bayonet-Knife, M6 | 10-15—10-21 | 28-30 | 10-5 |
| CHAPTER | 11. | FINAL INSPECTION | 11-1—11-3 | 33 | |
| APPENDIX | A. | REFERENCES | A-1—A-3 | 35 | |
| APPENDIX | B. | DIRECT SUPPORT AND GENERAL SUPPORT MAINTENANCE REPAIR PARTS AND SPECIAL TOOLS LIST (INCLUDING DEPOT MAINTENANCE REPAIR PARTS AND SPECIAL TOOLS) | | | |
| Section | I. | Introduction | B-1—B-6 | 37—39 | |
| | II. | Repair Parts List | | | |
| | | Major groups and assemblies—Rifle M14 | | 56 | 1 |
| | | Major groups and assemblies—Rifle M14A1 | | 57 | 2 |
| | | Firing mechanism..... | | 58 | 3 |
| | | Stock assembly with butt plate—Rifle M14 | | 59 | 4 |
| | | Shoulder gun stock assembly—Rifle M14A1 | | 60 | 5 |
| | | Operating rod and connector group | | 61 | 6 |
| | | Bolt assembly..... | | 61 | 7 |
| | | Barrel and receiver group..... | | 62 | 8 |
| | | Stabilizer assembly | | 62 | 9 |
| | | Rifle Bipod. M2..... | | 63 | 10 |
| | | Combination tool | | 63 | 11 |
| | | Kit, Winter Trigger | | 63 | 12 |
| | | Tools and Equipment Authorized for Unit Replacement | | 63,64 | 12,13,14 |
| | | Special Tools and Equipment | | 65 | 15 |
| | IV. | Federal Stock Number and Reference Number Index | | 66 | |

CHAPTER 1

INTRODUCTION

Section I. GENERAL

1-1. Scope

These instructions are in accordance with the maintenance allocation chart (TM 9-1005-223-20) and are published for the use of direct support and general support personnel maintaining the 7.62-MM Rifle, M14, M14A1 and Rifle Bipod, M2. They provide information on the maintenance of the equipment, which is beyond the scope of the tools,/equipment, personnel, or supplies normally available to operator and for organizational maintenance.

1-2. Forms and Records

Maintenance forms, records, and reports which are to be used by maintenance personnel at all

maintenance levels are listed in and prescribed by TM 38-750.

1-3. Reporting of Errors

Report of errors, omissions, and recommendations for improving this publication by the individual user is encouraged. Reports should be submitted on DA Form 2028, Recommended Changes to Publications, and forwarded direct to: Commanding General, US Army Weapons Command, ATTN: AMSWE-MAS/SP, Rock Island, Illinois 61201.

Section II. DESCRIPTION AND DATA

1-4. Description.

Refer to TM 9-1005-223-10 and TM 9-1005-223-20 and figures 1-1 and 1-2.

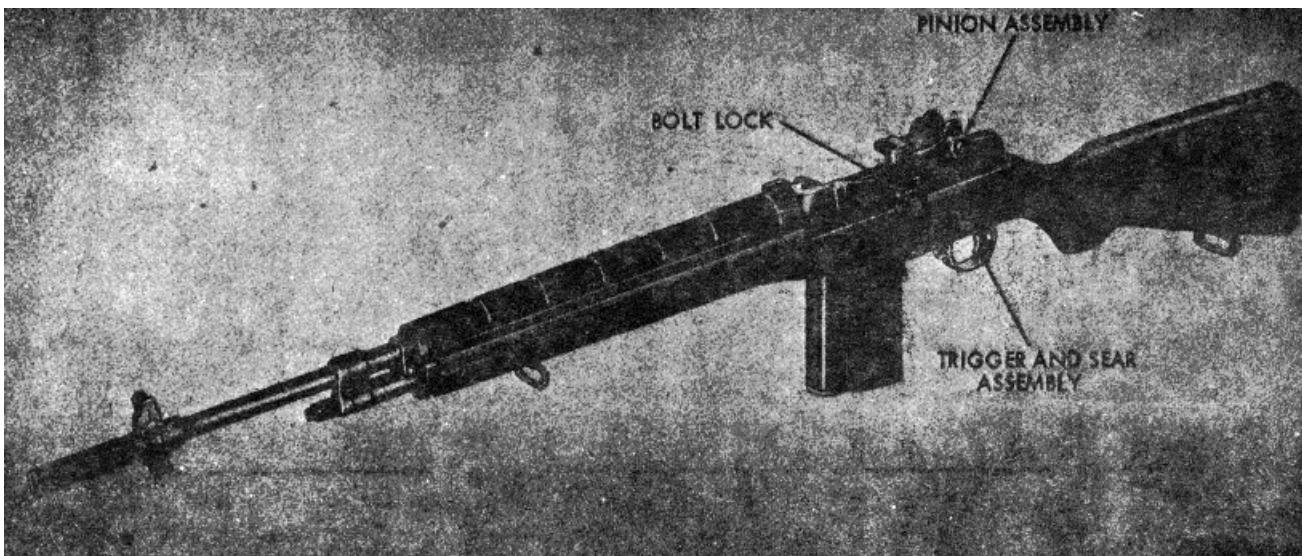

Figure 1-1. 7.62-MM Rifle. M14-left view.

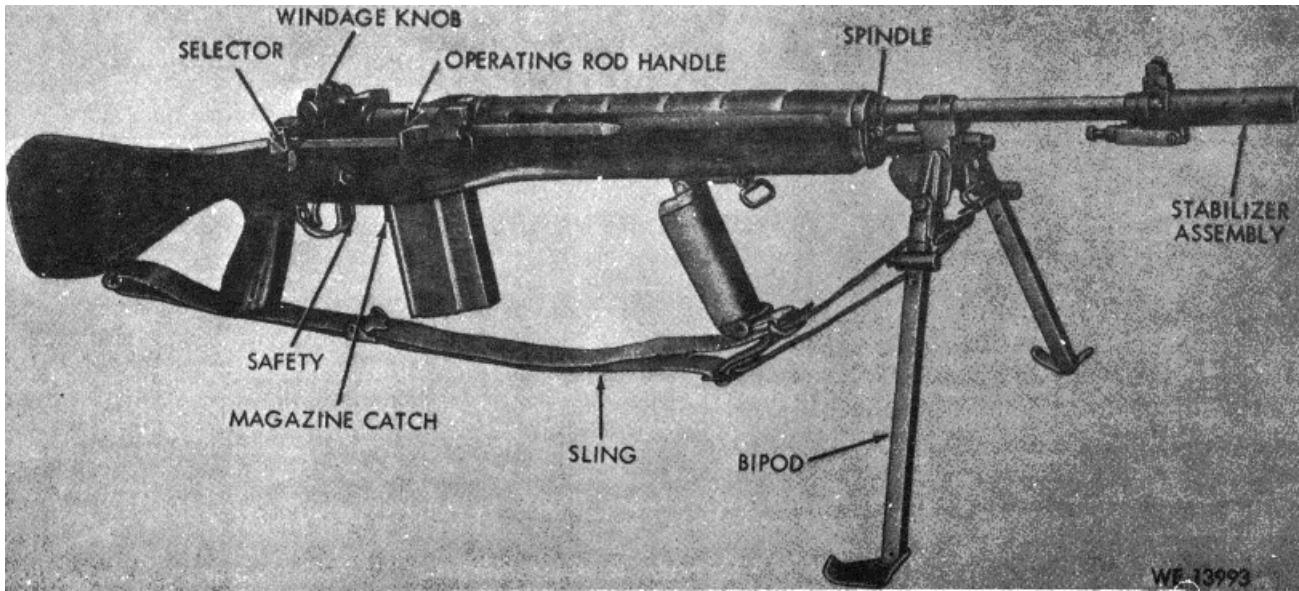

Figure 1-2. 7.62-MM Rifle, M14A1-right view.

- 1-5. **Tabulated Data**
Refer to TM 9-1005-223-20.

**CHAPTER 2
DIRECT SUPPORT AND GENERAL SUPPORT
MAINTENANCE INSTRUCTIONS**

Section I. REPAIR PARTS, SPECIAL TOOLS, AND EQUIPMENT

2-1. Repair Parts, Special Tools, and Equipment

Refer to appendix B.

Section II. TROUBLESHOOTING

2-2. General

This section contains troubleshooting information for locating and correcting malfunctions which may develop in the 7.62-MM Rifle, M14 and M14A1.

2-3. Troubleshooting

a. Table 2-1 is intended as a guide for troubleshooting. The table does not cover all possible malfunctions that may occur. Only the more common malfunctions are listed.

b. Also refer to the troubleshooting tables in TM 9-1005-223-10 and TM 9-4005-223-20.

Table 2-1. Troubleshooting

| Malfunction | Probable Cause | Corrective Action |
|-----------------------------------|--|---|
| RIFLE M14 AND M14A1 | | |
| 1. Magazine difficult to install. | Damage or restricted movement of magazine latch. | Replace magazine latch. |
| 2. Short recoil | a. Under sized or damaged gas piston. b. Gas cylinder oversize. c. Operating rod bent d. Damaged operating rod guide. e. Bolt binding receiver. f. Restricted movement of operating rod. g. Cartridge clip guide pin restricting bolt movement | a. Replace b. Replace c. Replace. d. Replace. e. Clean or repair bolt and/or receiver. f. Repair or replace defective component g. Drive pin up from receiver |
| 3. Bolt fails to close | a. Extractor does not open enough to pass over rim of cartridge. b. Operating rod binding c. Weak or broken operating rod Spring. d. Damaged or blocked ejector e. Damaged or deformed bolt. f. Insufficient headspace. | a. Replace extractor and/or extractor spring b. Replace c. Replace. d. Replace e. Repair or replace bolt assembly f. Replace bolt |
| 4. Failure to feed | a. Short recoil b. Gas cylinder. gas port not aligned with gas port of barrel. | a. See "Short recoil". b. Tighten gas cylinder lock. |
| 5. Failure to extract | a. Excessive headspace. b. Pitted chamber c. Broken extractor. d. Defective ammunition. e. Restricted movement of operating rod. | a. Replace weapon b. Replace weapon c. Replace extractor d. Use cleaning rod to remove cartridge. Clean chamber and ammunition. e. Rep air or replace defective components. |

Table 2-1. Troubleshooting-Continued

| Malfunction | Probable Cause | Corrective Acton |
|--|--|--|
| 6. Failure to eject | a. Weak, missing, or frozen ejector spring. b. Damaged or blocked ejector. c. Restricted movement of operating rod. | a. Replace ejector. b. Replace ejector. c. Repair or replace component. |
| 7. Failure of bolt to open after fire | a. Gas cylinder plug missing, gas piston seized or improperly installed in cylinder. b. Restricted movement of operating rod. | a. Install gas cylinder plug. Repair or install gas piston properly. b. Repair or replace components. |
| 8. Failure to fire | a. Lower tang on hammer strikes stud on trigger. b. Inadequate firing pin protrusion. c. Hammer spring housing damaged. | a. Install hammer properly. b. Replace firing pin. c. Replace. |
| 9. Failure to hold bolt rearward | a. Damaged or deformed bolt lock. b. Bolt lock movement restricted. c. Short recoil. | a. Repair or replace. b. Replace spring. c. See "Short recoil". |
| 10. Bipod fails to stay on rifle | a. Jaw, securing bolt, loose. b. Jaw securing bolt. stripped. | a. Align and tighten. b. Replace defective components. |
| 11. Legs fail to stay in up or down position | c. Plunger worn or spring damaged. a. Replace b. Yoke does not retain plunger in position. | a. Replace. b. Replace. |
| 12. Leg difficult to extend or retract | a. Plunger worn or spring damaged. b. Leg damaged. | a. Replace spring plunger. b. Repair or replace. |

Section III. PREEMBARKATION INSPECTION OF MATERIEL IN UNITS ALERTED FOR OVERSEAS MOVEMENT

2-4. General

a. *Inspection Data.* In addition to inspection data included under this section, refer to TB 9-1000-247-35 for general inspection criteria for preembarkation inspection for overseas shipment.

WARNING

Clear weapon of ammunition before starting an inspection. Point weapon in a safe direction and examine for presence of live ammunition. Check barrel and chamber for obstruction, e.g., bullet or ruptured cartridge case.

The equipment must be thoroughly cleaned of greasy foulings, dirt, and other foreign particles that might interfere with normal operation.

b. *Inspection of Parts.*

(1) Check screw heads and threads for visual damage.

(2) Check to see that the materiel is free of burs. particularly on moving surfaces.

(3) Check parts for bends, cracks, breaks, distortion and mutilation. Parts must not show visual indications of excessive wear.

(4) Check springs for weakness, breaks, or deformity.

(5) Check lock and safety devices for good operation.

(6) Check weapon for missing parts, proper assembly and operation.

(7) Plungers, latches, swivels, catches and similar parts must be checked for operation. These components must be properly assembled to the major item and not be subjected to loss.

(8) Check the bayonet and bipod for overall general appearance, fit and positive retention on rifle. Check also for missing parts and other visual damage.

(9) Check to see that the exterior of weapon is free of rust, dents, cracks, dryness and other objectionable defects.

(10) Check sight mechanism for proper installation, functioning and visual damage.

(11) Inspect firing pin tang and striker for good general appearance and condition. Check firing pin protrusion. It must not exceed 0.060 inch when firing pin is in the fired position.

(12) Inspect barrel for pitting, scoring, ring wear and stripping of lands.

(13) Check trigger pull with trigger pull measuring fixture. When using the 4-1/2 pound Height. the trigger pull should not release the hammer. When using the 7-1/2 pound weight, the trigger should release the hammer (fig 2-1). Repair any weapon that fails to pass the trigger pull test. (See chapter 4)



Figure 2-1. Trigger pull testing

(a) *Trigger pull too light.* This condition is caused by worn lugs on the trigger or worn hooks on the hammer spring. Examine components for wear or damage and, if necessary, replace with new parts.

(b) *Trigger pull excessive.* This condition is caused by:

1. Burs or irregular machined grooves on lugs of trigger or sear.
2. Defective hammer spring.
3. Obstruction or foreign material in the hammer spring housing that prevents proper seating of the hammer spring.
4. A damaged hammer spring plunger restricting movement of the hammer spring. Examine parts for defects. Remove burs with fine stone. Replace defective parts.

c. *Creep in Trigger.* This condition is caused by slightly rough contacting surfaces of the trigger lug or sear. Rough surfaces may be removed with a fine stone. Stone to a polish only. Make certain to maintain proper level and angularity.

Section IV. GENERAL MAINTENANCE

2-5. General

a. Information and instructions/contained herein are provided for personnel Performing direct support and general support maintenance on the materiel. Refer to TM 9-1005-223-20 for data on maintenance supplies and materials.

b. In subsequent chapters of this manual, the main assemblies(groups) of the rifle are disassembled, inspected, cleaned, replaced or repaired and assembled. Refer to pertinent chapters of this manual for removal/installation of components. The illustrations in this manual are numbered in the sequence of disassembly. When assembling, the reverse order of disassembly will be followed, unless otherwise instructed. Subsequent reference to components being worn and requiring replacement is intended to mean that only those items or mechanisms worn to a degree that normal functioning is affected will be replaced.

2-6. Repair Methods

NOTE

The words assemblies, sub-assemblies, and/or group are used interchangeably.

a. *Disassembly and Assembly Procedures.*

(1) In disassembling equipment, remove the major subassemblies and assemblies whenever possible. Subassemblies may then be disassembled, as necessary, into individual parts.

(2) During assembly, subassemblies should be assembled first and then installed to form a complete unit.

(3) Complete disassembly of a unit is not always necessary in order to make a required repair or replacement. Experience and good judgment should be used to minimize disassembly and assembly.

b. *Replacement of Parts.*

(1) When assembling a unit, replace all damaged pins, screws, bolts, washers, and nuts.

(2) Springs should be replaced when damaged or fail to function properly.

(3) If a required new part is not available, reconditioning of the repairable old part is required. However, after reconditioning a part it should be examined carefully to determine its serviceability.

c. *Use of Tools.* Exercise care to use tools that are suitable for a repair job in order to prevent damage to parts and tools.

d. *Finish of Metals.*

(1) Painted surfaces of the rifle, if chipped or cracked, may be repainted. Refer to TM 9-213.

(2) A class A or class B phosphate finish will be used on ferrous metal unless otherwise specified.

(3) It will not be necessary to refinish parts that already have a good quality finish.

(4) All parts will be free from rust, fungus, and corrosion.

e. *Repair of Damaged Machined and Polished Surfaces.*

(1) Smooth rough spots, scores, burs, galling, and gouges from damaged machined and polished surfaces so that each part will efficiently perform its normal function.

(2) The finish of each repaired part is to approximate that of the original finish. In performing any of these operations, critical dimensions must not be altered.

f. *Removal of Rust or Corrosion.* Remove oxidation with a cloth moistened with cleaning solvent (SD) or rifle bore cleaning compound (RBC). If this method fails, use crocus cloth or fine abrasive cloth. Vapor blast or sand blast equipment may also be used. In performing any of these operations, critical dimensions must not be altered.

2-7. Cleaning

a. *General.* Refer to paragraphs b through d, below.

b. *Cleaning of Material Received from Storage.*

(1) Material received in maintenance shops from storage will be cleaned by one of the methods described in (a) through (c) whichever is applicable or available.

CAUTION

Degreasing compound and degreasing temperatures can damage rubber and plastic parts. Do not attempt to degrease rubber or plastic parts which do not require degreasing.

(a) *Dip-tank method.* Disassemble parts and place them in a perforated metal basket. Submerge and agitate parts in a tank containing dry cleaning solvent or mineral spirits paint thinner. Repeat, using a second tank with dry cleaning solvent or paint thinner. The extent of treatment in each tank will depend on ease with which the preservatives are dissolved.

(b) *Vapor-degreaser method.* Tanks containing a heated solution of trichlorethylene or perchlorethylene (type II) are used mostly for degreasing items that are very greasy or oily and are not rapidly cleaned by the dip-tank method. Place parts in a perforated metal basket and submerge just below the vapor in the tank. Keep parts there until all greasy substance melts and runs off parts in the basket.

WARNING

Personnel operating vapor degreaser are cautioned not to breathe the toxic fume.

(c) *Steam method.* Place parts in a perforated metal basket and steam treat until clean. This method is less efficient than the vapor-degreaser method. Therefore, it may require additional cleaning of parts to remove all traces of greasy substance, particularly from recesses.

1. If sometime is to elapse before the start of repair operations, apply a light grade of preservative oil to all polished metal surfaces to prevent the formation of rust.

2. Remove all rust spots from highly finished surfaces with a light application of crocus cloth. Use grade 2/0 abrasive cloth on ordinary machined finished surfaces.

(d) *Cleaning after repair.*

1. After repair operations and prior to assembly, remove shop dirt and other foreign matter from all metal surfaces. This can be done by the dip-tank method, the vapor-degreaser method, or by cleaning with cloths soaked in dry-cleaning solvent or rifle bore cleaning compound.

2. In the dip-tank method, agitation for approximately one minute in each tank is sufficient. In the vapor-degreaser method, treatment for about two-to-three minutes is sufficient.

(e) *Cleaning after shop inspection.* Dip parts in a tank containing dry cleaning solvent. Remove parts and dry thoroughly with a clean cloth. Then apply a light coat of general purpose lubricating oil (PL special).

2-8. Cleaning and Preservation

Refer to TM 9-247.

Section V. REMOVAL AND INSTALLATION OF MAJOR COMPONENTS AND AUXILIARIES

2-9. Removal

Refer to pertinent chapters in this manual and TM 9-1005-223-20.

2-10. Installation

a. Refer to pertinent chapters in this manual and TM 9-1005-223-20.

b. During repair operations, when cleaning parts or components with dry cleaning solvents or mineral spirits paint thinner, observe the following safety precautions.

WARNING

Dry cleaning solvents and paint thinners are flammable. Do not clean parts near an open flame or in a smoking area. Fire extinguishers should be readily available when these materials are used. Use only in well-ventilated places.

WARNING

Dry cleaning solvents and paint thinners evaporate quickly and have a drying effect on the skin. When used without protective gloves, these chemicals may cause irritation or cracking of the skin. Use a lanolin base cream or liquid on exposed skin.

CAUTION

Do not permit rubber gaskets or other types of synthetically fabricated components to come in contact with solvents or paint thinners.

CHAPTER 3

REPAIR OF MAGAZINE ASSEMBLY

Section I. DISASSEMBLY AND ASSEMBLY

3-1. General

This chapter contains disassembly, assembly, cleaning, inspection and repair instructions for the magazine assembly.

3-2. Description

The magazine assembly consists of a tube, spring, base, follower and stop assembly. The magazine holds 20 rounds of 7.62-mm ammunition.

3-3. General Repair Instructions

Refer to paragraphs 2-5 through 2-8.

3-4. Disassembly and Assembly

Refer to figure 3-1.

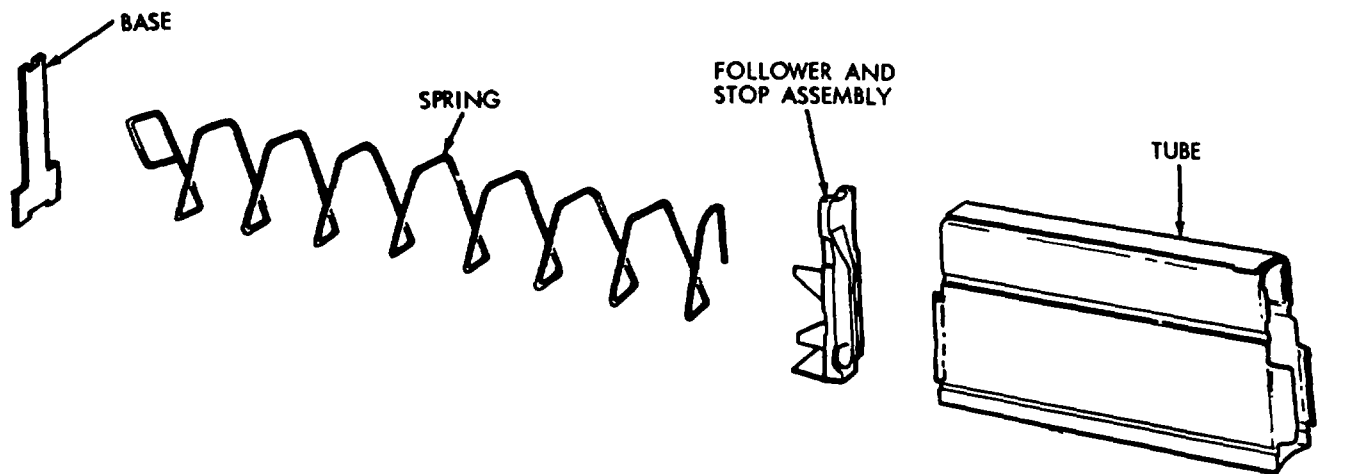

WE17110

Figure 3-1. Magazine exploded view.

Section II. CLEANING, INSPECTION AND REPAIR

3-5. Cleaning

Refer to paragraph 2-7.

3-6. Inspection

a. Inspect tube, base, follower and stop assembly for burs, bends, nicks and dents.

b. Inspect the spring for burs, rust, breaks and distortion.

3-7. Repair

Repair consists of replacing damaged or missing parts.

CHAPTER 4

REPAIR OF THE FIRING MECHANISM

REPAIR OF STOCK AND HAND GUARD ASSEMBLIES

Section I. DISASSEMBLY AND ASSEMBLY

4-1. General

This chapter contains disassembly, assembly, cleaning, inspection and repair instructions for the firing mechanism.

4-2. Description

The firing mechanism consists primarily of a hammer, hammer spring housing, hammer spring, trigger and sear assembly, guard assembly, safety,

safety spring, trigger and latch housing assembly, magazine latch, spring and pin. The firing mechanism initiates firing or causes the weapon to cycle.

4-3. General Repair Instructions

Refer to paragraphs 2-5 through 2-8.

4-4. Disassembly/Assembly

Refer to figure 3.

Section II. CLEANING, INSPECTION AND REPAIR

4-5. Cleaning

Refer to paragraph 2-7.

4-6. Inspection

a. *Hammer.* Inspect hammer for burs, hole wear, chips, or cracks. Check hammer for sharp corners and smooth surfaces where contact is made with trigger lugs and sear.

b. *Hammer Spring.* Check spring for breaks, burs, weakness or mutilation.

c. *Trigger and Sear Assembly.* Check trigger and sear assembly for wear and for other visual damage. Check sear pin to make sure that it holds mating parts snugly.

d. *Guard Assembly.* Check guard assembly for burs, bends, cracks or mutilation. Check to make sure that it does not interfere with trigger movement and locking action.

e. *Safety.* Check safety for burs, cracks or mutilation. Check for binding action and excess play.

f. *Safety Spring.* Check spring for breaks, burs, and distortion.

g. *Trigger Housing.* Check trigger housing for rust, corrosion, hole wear, cracks, and for other visual damage.

h. *Machine Latch, Spring and Pin.* Check pins for burs or mutilation.

i. *Latch.* Inspect latch for wear, missing parts and for other visual damage. Check to make sure that the latch makes positive contact with locking plate, welded on top rear of magazine. Check to make sure that latch exhibits acceptable locking action.

4-7. Repair

a. Repair consists of replacing damaged, missing parts, or the complete firing mechanism.

b. Check trigger pull with trigger pull measuring fixture fig 2-1). When using the 4-1/2 lb weights (min) the trigger should not release the hammer. When using the 7-1/2 lb weights, the trigger should release the hammer.

CHAPTER 5

REPAIR OF STOCK AND HAND GUARD ASSEMBLIES

Section I. DISASSEMBLY AND ASSEMBLY

5-1. General

This chapter contains disassembly, assembly, cleaning, inspection and repair instructions for the stock and hand guard assemblies.

5-2. Description

The stock and hand guard assemblies serve as a housing for the barrel and receiver group.

5-3. General Repair Instructions

Refer to TM 9-1005-301-30.

5-4. Disassembly/Assembly

Refer to figures 4 and 5.

Section II. CLEANING, INSPECTION AND REPAIR

5-5. Cleaning

Refer to TM 9-1005-223-20.

5-6. Inspection

Inspect stock and hand guard assemblies for cracks, deep scratches, and for other visual damage. Check fit of action in stock. Check butt plate (M14 Rifle) for rust, burs, and for other visual damage. Check the cushioned butt plate (M14A1 Rifle) for mutilation, wear,

decomposition, and for other visual damage. Check to make sure that screws are in place and firmly holding components together.

5-7. Repair

Repairable stock and hand guard assemblies will be repaired in accordance with instructions contained in TM 9-1005-301-30.

CHAPTER 6

REPAIR OF THE OPERATING ROD
AND CONNECTOR GROUP

Section I. DISASSEMBLY AND ASSEMBLY**6-1. General**

This chapter contains disassembly, assembly, cleaning, inspection and repair instructions for the operating rod and connector group.

6-2. Description

The operating rod and connector group work in conjunction with the firing mechanism and bolt assembly. The group consists primarily of a connector assembly, plunger, rod, compression and operating rod springs, body, guide and pins. One end of the rod acts as a front latch for the magazine.

During a firing cycle, the group moves to the rear and returns to the forward position, causing bolt activity to chamber ammunition for firing. The rapid rear-to-front movement of the group causes ejection of spent cartridge cases and chambering of a serviceable round of ammunition.

6-3. General Repair Instruction

Refer to paragraphs 2-5 through 2-8.

6-4. Disassembly/Assembly

Refer to figure 6.

Section II. CLEANING INSPECTION AND REPAIR**6-5. Cleaning**

Refer to paragraph 2-7.

6-6. Inspection

a. Inspect connector assembly for cracks, breaks, bends, and missing parts. Check hold on rear of connector body to make certain it fits lug or sear release. Inspect front portion of body for engagement with connector lock.

b. Check operating rod guide for burs, cracks, and protective coating.

c. Inspect operating rod spring for breaks, tension, and for other visual damage.

d. Check operating rod and connector group for missing parts, such as plunger, spring and pin. Check apertures in connector and guide for wear, cracks, and for other visual damage.

6-7. Repair

Repair consists of replacing damaged, worn or missing parts. If necessary, remove burs from metal parts with a fine grain stone.

CHAPTER 7

REPAIR OF BOLT ASSEMBLY

Section I. DISASSEMBLY AND ASSEMBLY

7-1. General

This chapter contains disassembly, assembly, cleaning, inspection and repair instructions for the bolt assembly.

7-2. Description

The bolt assembly, consists primarily of an extractor, ejector, plunger, firing pin spring and roller assembly. The bolt assembly serves to seal gas

chamber pressure; to feed ammunition into the chamber of weapon; to detonate the primer to fire the propellant in the body of the cartridge and to extract spent cartridges.

7-3. General Repair Instructions

Refer to paragraphs 2-5 through 2-8.

7-4. Disassembly/Assembly

Refer to figure 7 and TM 9-1005-223-20.

Section II. CLEANING, INSPECTION AND REPAIR

7-5. Cleaning

Refer to paragraph 2-7.

7-6. Inspection

a. Inspect bolt assembly for proper operation and assembly.

b. Inspect firing pin protrusion with gage (fig 7-1) to determine the serviceability of the firing pin. Refer to chapter 11 for serviceability standards.

c. Check the firing pin hole diameter for wear, using firing pin gage (fig 7-2). Refer to table 11-1 for maximum wear limits for serviceability.

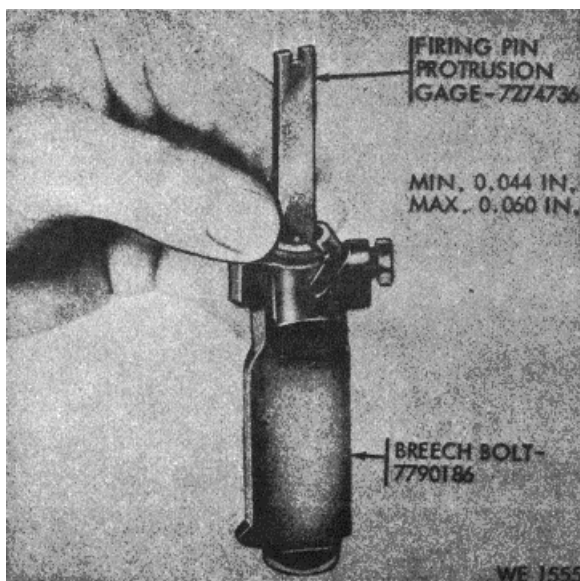

Figure 7-1. Gaging firing pin protrusion.

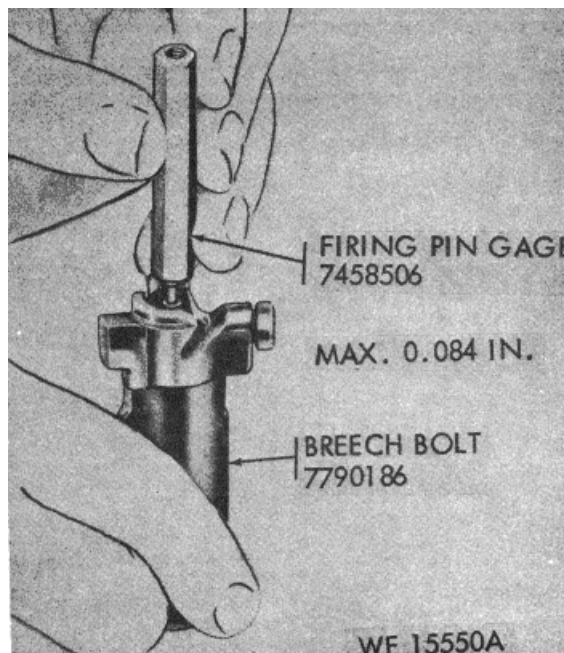

Figure 7-2. Checking diameter of firing pin hole.

- d. Check bolt roller for retention and movement.
- e. Inspect for weak, broken and distorted springs.
- f. Inspect all parts for burs, pits, cracks and mutilation.
- g. Inspect the bolt assembly while installed in the rifle for movement, extraction, feeding, and ejection action.
- h. Check bolt in receiver in conjunction with headspace gage (fig 7-3). Insert gage into chamber. Position it so cartridge ejector enters the clearance cut on base of gage.

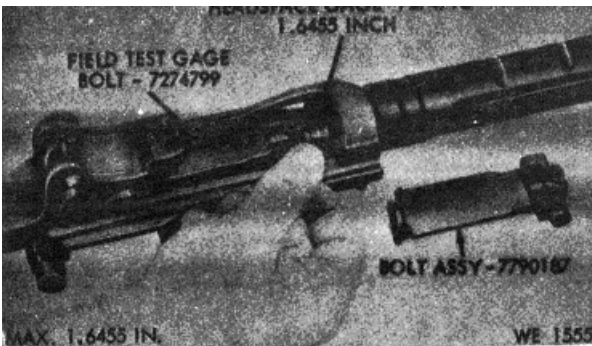

Figure 7-3. Gaging headspace.

NOTE

In making headspace test, the bolt should never be forced. It should be felt, using only a minimum finger tip pressure.

- i. Move bolt forward. The bolt should not close.
- j. If the bolt closes, test rifle with field test bolt, as follows:
 - (1) Remove the bolt assembly.
 - (2) Insert field test gage bolt (fig 7-3) into receiver.
 - (3) Insert headspace gage into face of field test bolt.
 - (4) Move the bolt forward. If the field test gage bolt does not close, the bolt is unserviceable. If the field test gage bolt does close on the headspace gage, the rifle is unserviceable.

7-7. Repair

- a. Repair consists of replacing missing and defective parts.
- b. Replace a rifle determined to be unserviceable.

CHAPTER 8

REPAIR OF BARREL AND RECEIVER GROUP

Section I. DISASSEMBLY AND ASSEMBLY

8-1. General

This chapter contains disassembly, assembly, cleaning, inspection and repair instructions for the barrel and receiver group.

8-2. Description

The barrel and receiver group consists primarily of a barrel, receiver, front and rear sights, automatic-semiautomatic firing selector, gas cylinder, flash suppressor and stabilizer assembly. It is housed in the removable stock and hand guard assemblies. When the firing mechanism, the

operating rod, and connector group and bolt assembly are assembled to the barrel and receiver group, a cycle of operation is possible. With a magazine containing serviceable ammunition installed in the weapon, only a squeeze of the trigger is necessary to initiate the firing cycle.

8-3. General Repair Instructions

Refer to paragraphs 2-5 through 2-8.

8-4. Disassembly/Assembly

Refer to figures 8 and 9.

Section II. CLEANING, INSPECTION AND REPAIR

8-5. Cleaning

Refer to paragraph 2-7

8-6. Inspection

a. Barrel and Receiver. Use breech bore gage (fig 8-1) to check wear. Wear must not exceed 0.310 inch for serviceability.

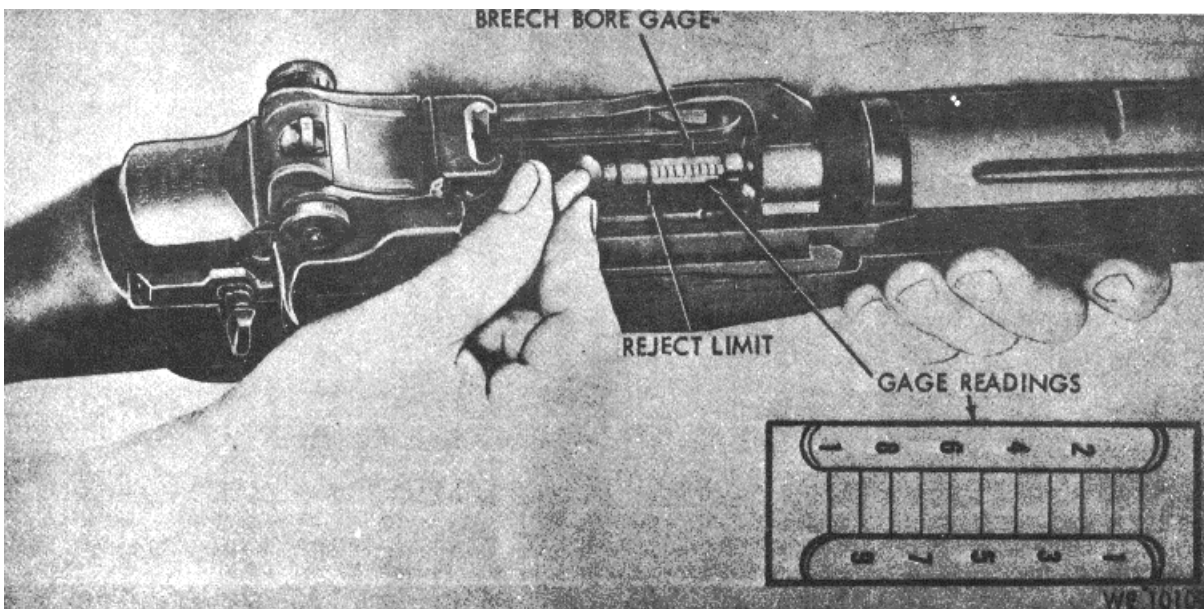

Figure 8-1. Gaging of breechbore.

b. *Gas Cylinder.* Use Not-Go Plug Gage (fig 8-2) to check piston hole in gas cylinder. Hole must not exceed 0.5009 inch for serviceability.

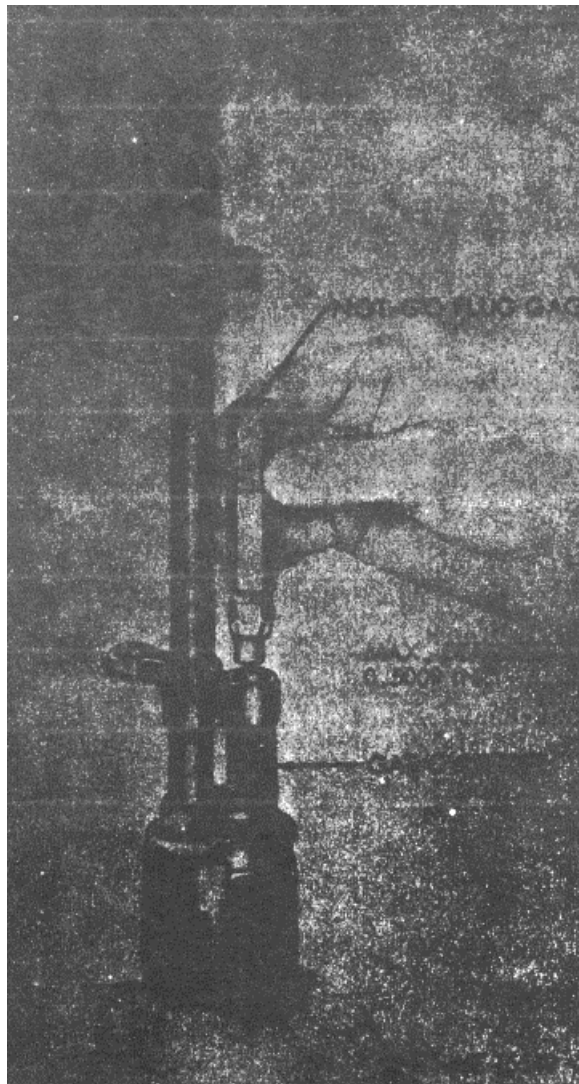

Figure 8-2. Checking diameter piston bole with Not-Go plug gage.

c. *Flash Suppressor.* Use alignment tool (fig 8-3) to check alignment of flash suppressor with

barrel bore. Alignment tool must enter into flash suppressor and barrel of bore for serviceability.

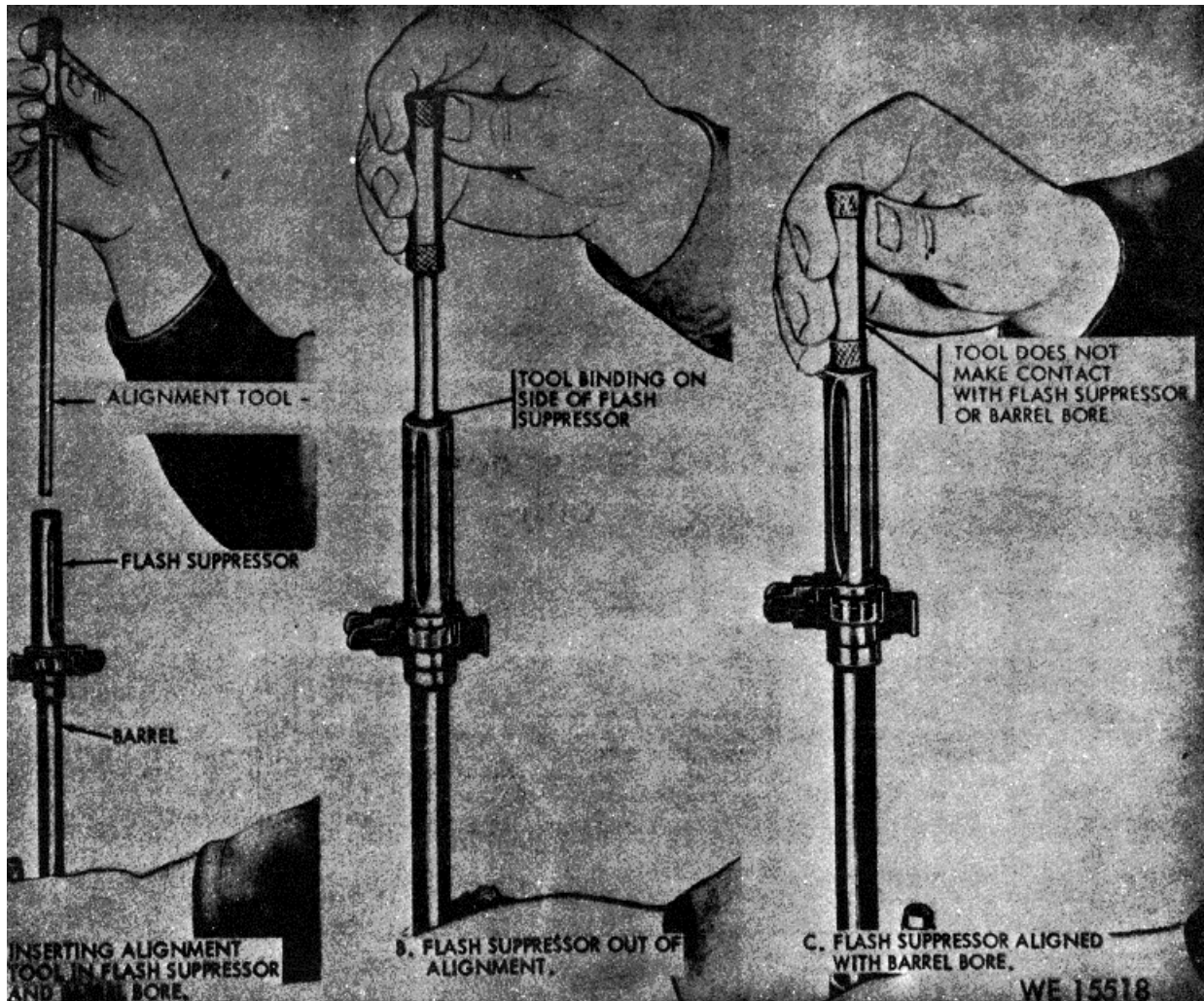

Figure 8-3. Checking alignment of flash suppresser with alignment tool.

NOTE

Use NOT-GO piston snap gage (fig. 8-41) to measure the diameter of

the gas piston for wear. Diameter of gas piston must be not less than 0.4968 inch.

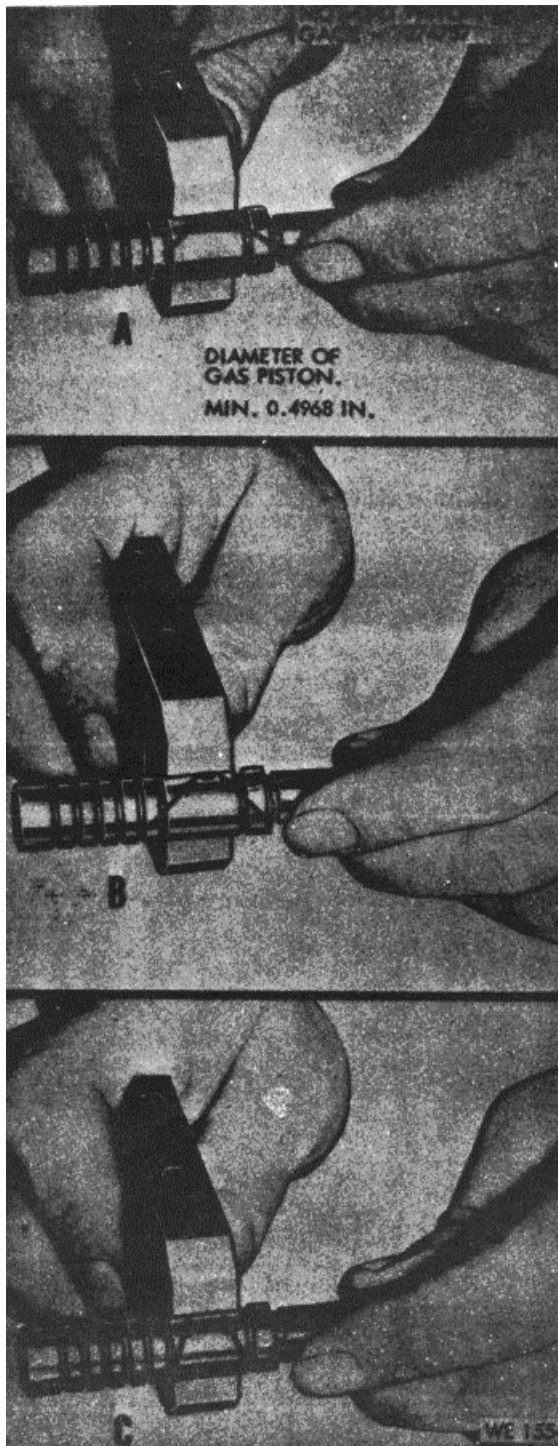

Figure 8-4. Checking diameter of gas piston.

d. *Headspace Gage.*

- (1) Remove operating rod assembly.
- (2) Clean barrel chamber, bolt and receiver.
- (3) Insert headspace gage (fig 7-3) into chamber. Position it so cartridge ejector enters the clearance cut on the base of the headspace gage.
- (4) Move bolt forward. If the bolt does close, test rifle with field test bolt as below:
 - (a) Remove bolt assembly.
 - (b) Insert field test gage bolt into the receiver.
 - (c) Insert headspace gage into face of field test bolt.
 - (d) Move the bolt forward.
 - (e) Replace the bolt if the field test gage bolt does not close. Declare rifle unserviceable if the field test gage bolt closes on the headspace gage in the receiver. Maximum headspace shall not exceed 1.6455 inches.

8-7. Repair

Repair consists of replacing damaged, worn, missing parts, or the entire barrel and receiver group.

CHAPTER 9

REPAIR OF RIFLE BIPOD

Section I. DISASSEMBLY AND ASSEMBLY

9-1. General

This chapter contains disassembly, assembly, cleaning, inspection and repair instructions for the Rifle Bipod, M2.

9-2. Description

This bipod (fig 9-1) is a folding type, portable mount for the rifle. It consists primarily of adjustable leg assemblies, plungers, buttons, a gun sling swivel, yoke assemblies, left-and-right hand jaw assemblies, and a self-locking bolt. When utilized, it is assembled to the

gas cylinder of the rifle by yoke assemblies and self-locking bolt. The female section of each leg may be moved up or down on the shaft assembly. A plunger on each leg extension assembly rests in a slot when release to retain legs of bipod at the desired height setting.

9-3. General Repair Instructions

Refer to paragraph 2-5.

9-4. Disassembly and Assembly

Refer to figure 10.

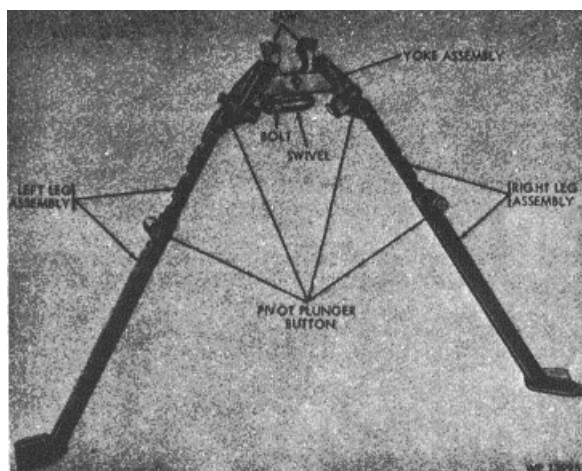

Figure 9-1. Bipod, M2

Section II. CLEANING, INSPECTION AND REPAIR

9-5. Cleaning

Refer to paragraph 2-7.

9-6. Inspection

- a. Inspect pins for wear.
- b. Inspect pivot plunger buttons and plungers for burs, cracks, and holding stability.
- c. Inspect spring for breaks, weakness and kinks.
- d. Inspect self-locking bolt for head and thread damage.

e. Inspect recesses in jaws and yoke assembly for burs and cracks.

f. Pull out plunger on leg extensions and move legs up and down shafts. Release plungers and check each leg for positive locking action.

g. Check for missing, torn and defective parts.

9-7. Repair

Repair consists of replacing missing or damaged parts.

CHAPTER 10 MAINTENANCE OF MATERIEL USED IN CONJUNCTION WITH MAJOR ITEM

Section I. INTRODUCTION

10-1. General

This chapter contains repair and maintenance instructions for the Grenade Launcher, M76, Grenade

Sight, M15, and Bayonet Knife, M6 for direct support and general support maintenance as allocated in the MAC.

Section II. GRENADE LAUNCHER, M76

10-2. Description

The grenade launcher, M76, (fig 10-1) is used to launch grenades.

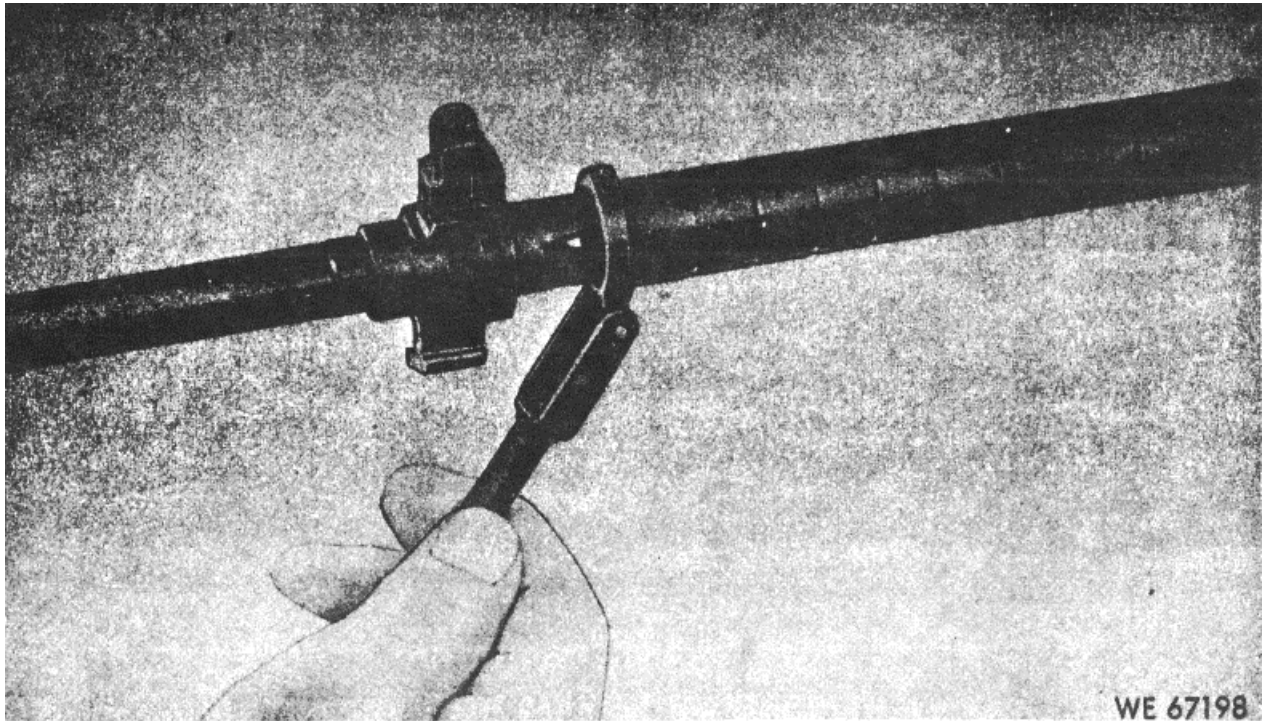

Figure 10-1. Grenade Launcher, M76.

10-3. General Repair Instructions

Refer to paragraphs 2-5 through 2-8.

10-4. Disassembly/Assembly

None.

10-5. Cleaning

Refer to paragraph 2-7.

10-6. Inspection

Inspect for broken, chipped latch, missing parts and spring damage.

10-7. Repair

None. Replace unserviceable grenade launcher.

Section III. GRENADE LAUNCHER SIGHT, M15

10-8. General

Refer to paragraph 10-1.

10-9. Description

The Grenade Launcher Sight, M15 (fig 20-2) is used in connection with the Grenade Launcher, M76 as an aiming device. It is assembled to the stock of the weapon.

10-10. General Repair Instructions

a. Refer to paragraphs 2-5 through 2-8.

b. To prepare a stock for installation of the grenade sight mounting plate (fig 10-2), drill two holes (fig 10-3) on the left side of the stock. Use improvised template (fig 10-4) for marking the exactness of holes. Drill the holes with drill No. 29 (0.1360) inch.

10-11. Disassembly/Assembly

Refer to figure 10-2.

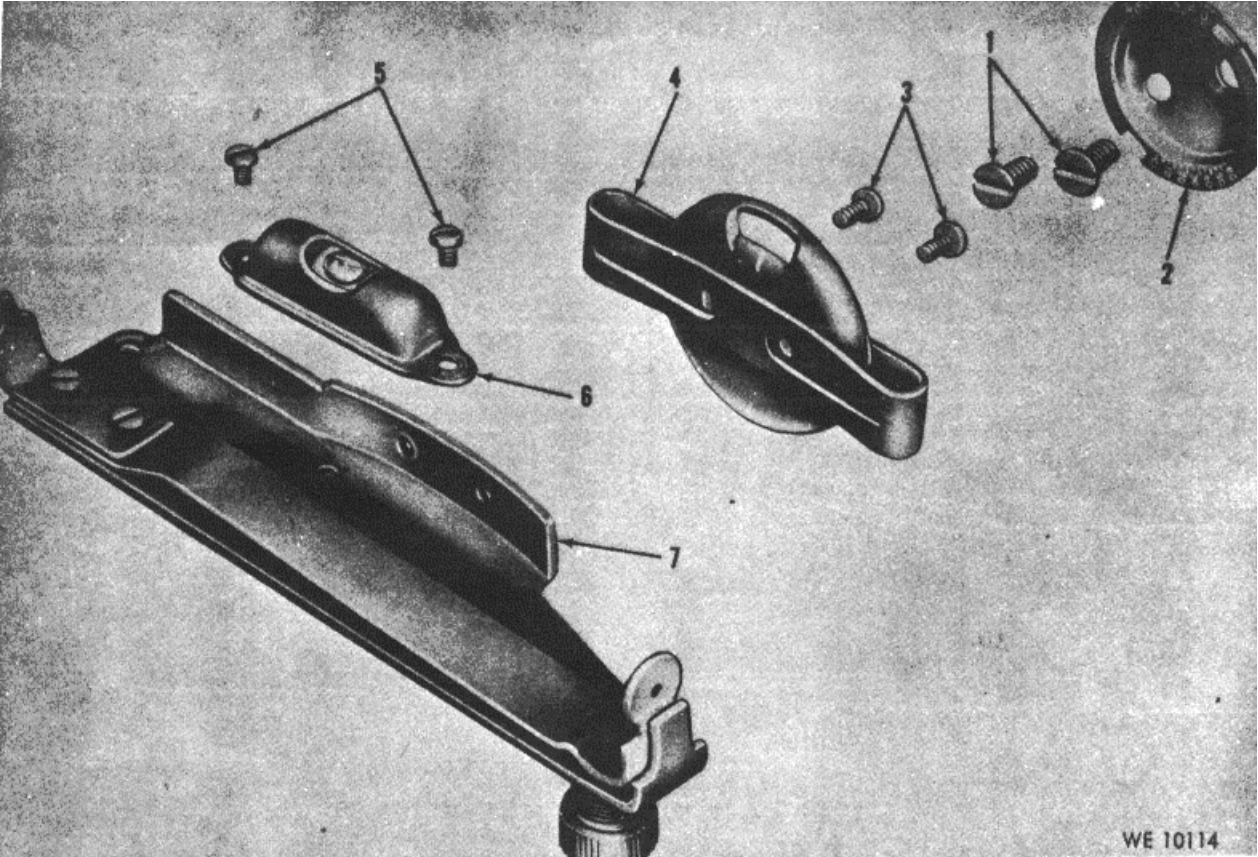

Figure 10-2. Grenade launcher sight-exploded view.

- 1. Tapping screw
- 2. Plate
- 3. Screw
- 4. Bracket and spring assembly
- 5. Screw
- 6. Level assembly
- 7. Body

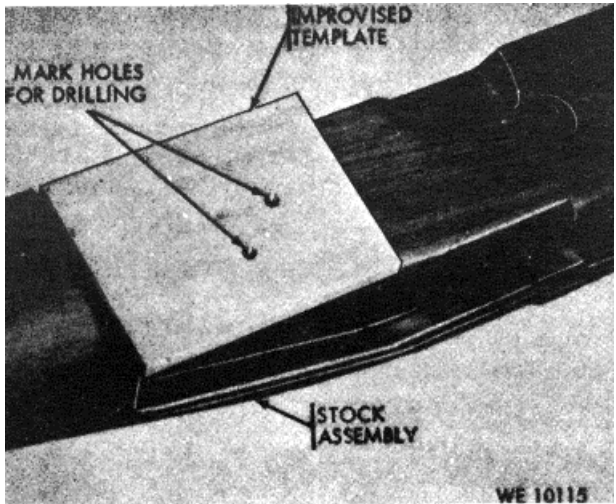
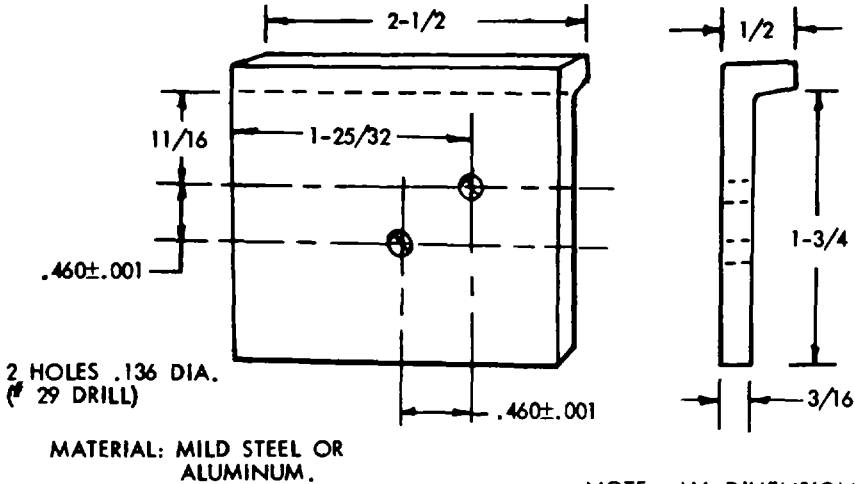

Figure 10-3. Using template to drill holes in stock assembly.



NOTE: ALL DIMENSIONS SHOWN ARE IN INCHES

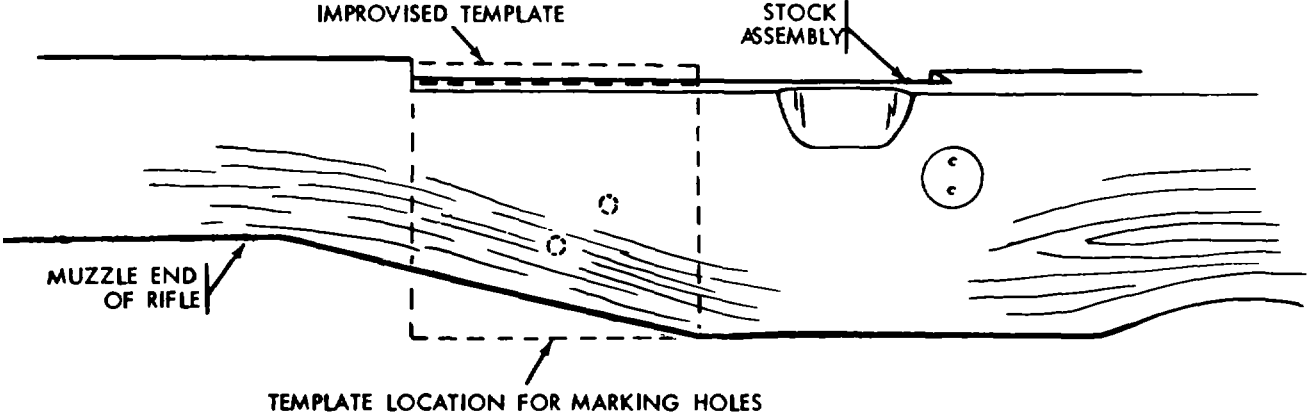

Figure 10-4. Showing location of hole drilled in stock assembly.

10-12. Cleaning

Refer to paragraph 2-7.

10-13. Inspection

a. Inspect for foreign matter, worn, missing, and damaged parts.

b. Inspect marking on mounting plate for legibility.

10-14. Repair

Repair consists of replacing damaged mounting plate, the lever, and attaching hardware. (See TM 9-1005-234-14P.)

Section IV. BAYONET KNIFE, M6

10-15. General

Refer to paragraph 10-1.

10-16. Description

The bayonet-knife is installed to the front end of the rifle barrel. It is used offensively against an enemy at close range.

10-17. General Repair Instructions

a. Refer to paragraphs 2-5 through 2-8 and b through d, below.

b. Remove nicks or burs from blade with a fine grain stone.

c. Tighten or replace loose or missing rivets.

d. Replace worn pin and screws showing thread damage.

10-18. Disassembly/Assembly

Refer to figure 10-5.

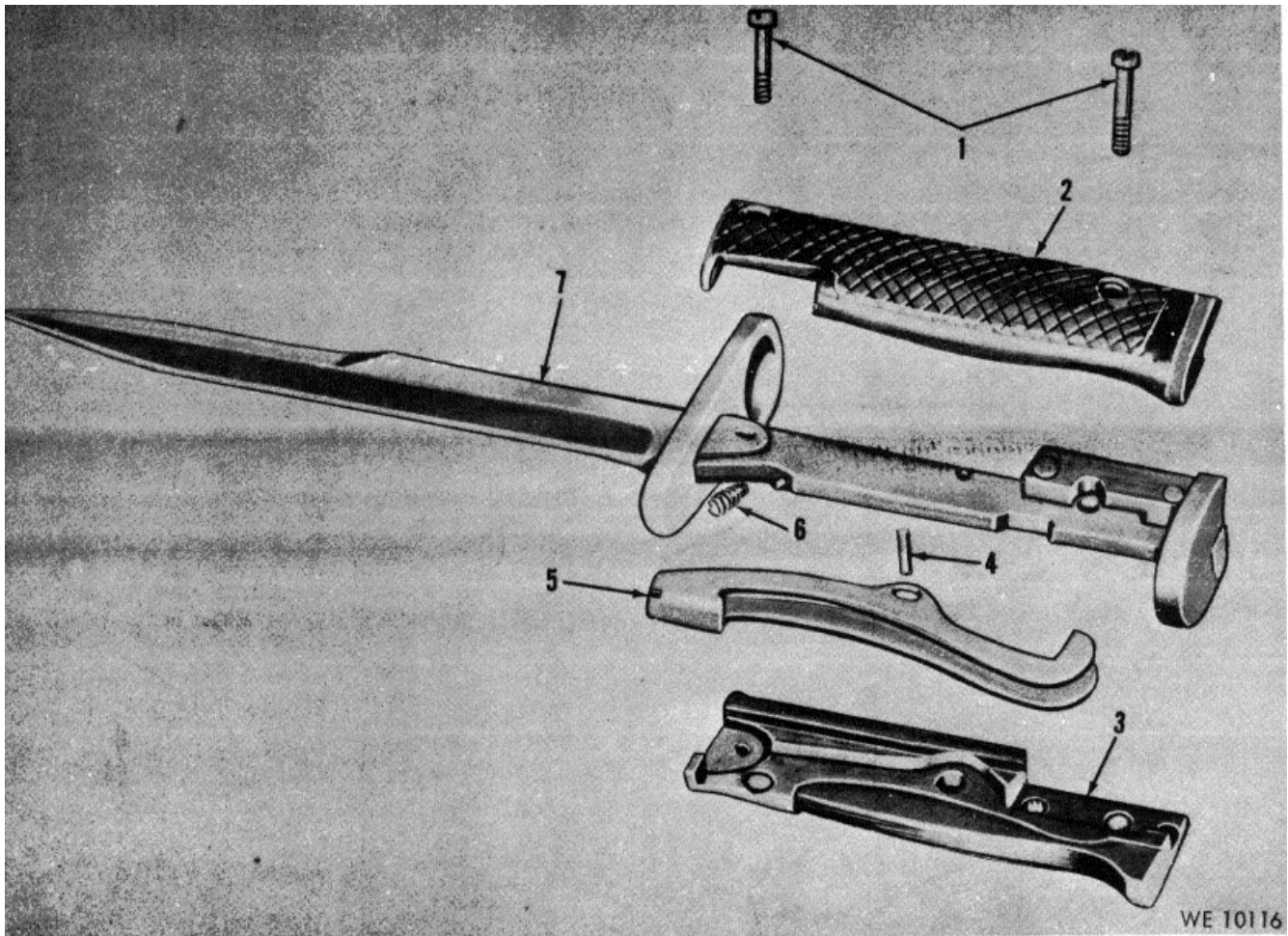

- 1. Screw
- 2. Grip
- 3. Grip
- 4. Pin

- 5. Lever
- 6. Spring
- 7. Blade assembly

Figure 10-5 Bayonet-Knife. M6-exploded view

10-19. Cleaning

Refer to paragraph 2-7.

10-20. Inspection

Inspect bayonet-knife for loose, missing, or damaged parts. Inspect screws for head and thread

damage. Check blade for burs, nicks, scratches, sharpness, and for straightness.

10-21. Repair

Repair consists of replacing worn, missing, or damaged parts. (See TM 9-1005-237-15P.)

CHAPTER 11 FINAL INSPECTION

11-1. General

a. Make certain that the equipment meets the limits as indicated in table 11-1 below for serviceability.

Table 11-1. Repair Standards for M4 and M1A1 Rifles

| Item inspection point and point of measurement | Wear limit |
|--|---------------|
| Barrel and Receiver | 0.310 in. max |
| Firing mechanism | 4.5 lb. min |
| Trigger pull | 7.5 lb. max |
| Firing pin protusion | 0.044 in. min |
| | 0.060 in. max |
| Firing pin hole in face of bolt | 0.084 in. max |
| Breech bore | 0.310 in. max |
| Diameter of piston hole in gas cylinder piston | 0.5009 in.max |
| Diameter of gas piston (around orifice | 0.4968 in.max |
| Gaging headspace with field test gage bolt | 1.6455 in.max |

b. Function fire rifle after repair, when possible, to be sure that it operates properly.

c. Visually check all assemblies after firing weapon for normal operation, damage and for missing or loose components.

d. Clean and lubricate rifle after each firing.

(1) On rifle not equipped with selector, ten rounds of serviceable ammunition will be fired.

(2) On rifle equipped with a SELECTOR, 20 rounds of serviceable ammunition will be fired (five rounds are to be fired semi-automatically, and 15 rounds are to be fired automatically, in bursts of approximately five rounds).

WARNING

Under no circumstances should a blank cartridge be modified by adding explosives in an attempt to obtain automatic action without the blank firing attachment. The loading of any cartridge with excess explosives is most likely to cause abnormal chamber pressure. The resulting abnormal chamber pressure may cause equipment damage and/or injury to the operator.

e. After firing, inspect all assemblies of the weapon with emphasis on the bore of the flash suppresser for evidence of gilding metal from ammunition.

11-2. Visual

The overall physical appearance of a reconditioned weapon will approximate that of a new one.

a. Exposed metal surfaces will be free of rust and possess a dull, rust-resistant finish. It will be free of burs and deep scratches.

b. The barrel must be straight, clean, free of rust, powder fouling, bulges and rings. Fine pitting is permissible. Rifle must be complete with no missing parts. All modifications must be applied.

11-3. Completion of Inspection

Upon completion of inspection and the rifle has been restored to a serviceable condition, it shall be certified that the weapon is acceptable for "return to user" or "return to stock".

APPENDIX A REFERENCES

A-1. Publication Indexes

The following indexes will be consulted frequently for latest changes or revisions of reference given in this appendix and for new publications relating to material covered in this technical manual.

| | |
|--|--------------|
| Index of Administrative Publication | DA Pam 310-1 |
| Index of Blank Forms | DA Pam 310-2 |
| Index of Supply Catalogs and Supply Manuals (Excluding Types 7, 8, and 9) | DA Pam 310-6 |
| Index of Technical Manuals, Technical Bulletins, Supply Manual (Types 7, 8, and 9), Supply Bulletins, and Lubrication Orders | DA Pam 310-4 |
| US Army Equipment Index of Modification Work Orders | DA Pam 310-7 |

A-2. Forms

Recommended, Changes to Publications. DA Form 2028

A-3. Other Publications

The following publications contain information pertinent to this materiel and associated equipment.

| | |
|--|-------------------|
| a. <i>Ammunition</i> | |
| Ammunition: Federal Stock Numbers and Department of Defense Codes | TB 9-AMM 5 |
| Small Arms Ammunition | TM 9-1305-200 |
| b. <i>General</i> | |
| Accident Reporting and Records | AR 385-40 |
| The Army Maintenance Management Systems (TAMMS) | TM 38-750 |
| c. <i>Maintenance and Repair</i> | |
| Cleaning of Ordnance Materiel | TM 9-208-1 |
| Direct Support Maintenance Manual: Repair of Wooden, Fiber Glass/Plastic or Plastic Components of Small Arms Weapons | TM 9-1005-301-30 |
| Inspection and Certification of Gages-Small Arms | TB 750-242-2 |
| Materials Used for Cleaning, Preserving, Abrading and Cementing Ordnance Materials; and Related Materials Including Chemicals | TM 9-247 |
| Operator's Manual, Rifle, 7.62-MM, M14, Rifle, 7.62-MM, M14A1 and Rifle Bipod, M2 | TM 9-1005-223-10 |
| Operator, Organizational, DS and GS Maintenance Repair Parts and Special Tool Lists for Launchers, Grenade, M-7A3 and M76 | TM 9-1005-234-14P |
| Organizational Maintenance Manual, Including Repair Parts, and Special Tools List, Rifle -7.62-MM, M14, Rifle, 7.62-MM, M14A1 and Rifle Bipod, M2 | TM 9-1005-223-20 |
| Organizational, DS, G5 and Depot Maintenance Repair Parts and Special Tools List: Bayonet-Knife, M4, M5, M5A1, M6 and M7 with Bayonet-Knife Scabbard M8A1 | TM 9-1005-237-15P |
| Painting Instructions For Field Use | TM 9-213 |
| d. <i>Shipment and Storage</i> | |
| Arms Adopted/other Selected Items and List of Reportable Items | SB 700-20 |
| Preservation-Packaging, Packing and Marking of Items of Supply | AR 700-15 |
| Requisitioning, Receipt, and Issue System | AR 725-50 |
| Standards for Overseas Shipment or Domestic Issue of Small Arms, Aircraft - Armament, Towed Howitzers, Mortars, Recoilless Rifles, Rocket Launchers, and Associated Fire Control Equipment | TB 9-1000-247-35 |
| Storage of Army Supplies and Equipment Covered and Open Storage | SB 38-8-1 |

**APPENDIX B
DIRECT SUPPORT AND GENERAL SUPPORT MAINTENANCE
REPAIR PARTS AND SPECIAL TOOLS LIST
(INCLUDING DEPOT MAINTENANCE REPAIR PARTS AND SPECIAL TOOLS)**

Section I. INTRODUCTION

B-1. Scope

This manual lists repair parts, special tools, and equipment required for the performance of direct support, general support, and depot maintenance of the M14 and M14A1 Rifles.

B-2. General

This Repair Parts and Special Tools List is divided into the following sections:

a. *Repair Parts List - Section II.* A list of repair parts authorized at the direct support, general support, and depot levels for the performance of maintenance. The list also includes parts which must be removed for the replacement of the authorized parts. Parts lists are composed of functional groups in ascending numerical sequence, with parts in each group listed in figure and item number sequence.

b. *Special Tools List Section III.* A list of special tools, test, and support equipment authorized for the performance of maintenance at the direct support, general support, and depot levels.

c. *Federal Stock Number and Reference Number Index -Section IV.* A list in ascending numerical sequence, of all Federal stock numbers appearing in the listings, followed by a list, in alphabetic sequence, of all reference numbers appearing in the listings. Federal stock number and reference numbers are cross-referenced to each illustration figure and item number appearance.

B-3. Explanation of Columns

The following provides an explanation of columns in the tabular listings.

a. *Source, Maintenance, and Recoverability Codes (SMR).*

(1) *Source Code.* Indicates the source for the listed items. Source codes are:

| Code | Explanation |
|-------------|---|
| 1 | Repair parts, special tools, and test equipment supplied from the GSA/DSA, or Army supply system, and authorized for use at indicated maintenance categories. |
| P2 | Repair parts, special tools, and test equipment which are procured and stocked for insurance purposes because the combat or military essentiality of the end item dictates that a minimum quantity be available in the supply system. |
| P9 | Assigned to items which are NSA design controlled: unique repair parts, special tools, |

| Code | Explanation |
|-------------|---|
| | test, measuring and diagnostic equipment, which are stocked and supplied by the Army COMSEC Logistic System and which are not subject to the provisions of AR 380-41. |
| P10 | Assigned to items which are NSA design controlled: special tools, test, measuring and diagnostic equipment for COMSEC support which are accountable under the provisions of AR 380-41, and which are stocked and supplied by the Army COMSEC Logistic System. |
| M | Repair parts, special tools and test equipment which are not procured or stocked as such in the supply system but are to be manufactured at indicated maintenance levels |
| A | Assemblies which are not procured or stocked as such but are made up of two or more units. Such component units carry individual stock numbers and descriptions are procured and stocked separately, and can be assembled to form the required assembly at indicated maintenance categories. |
| X | Parts and assemblies that are not procured or stocked because the failure rate is normally below that of the applicable end item or component. The failure of such part or assembly should result in retirement of the end item from the supply system. |
| X1 | Repair parts which are not procured or stocked. The requirement for such items will be filled by the next higher assembly or component. |
| X2 | Repair parts, special tools and test equipment which are not stocked and have no foreseen mortality. The indicated maintenance category requiring such repair parts will attempt to obtain the parts through cannibalization or salvage. The item may be requisitioned. With exception data from the end item manager for immediate use |
| G | Major assemblies that are procured with PEMA funds for initial issue only as exchange assemblies at DS and GS level. These assemblies will not be stocked above DS and GS level or returned to depot supply level. |

NOTE

Cannibalization or salvage may be used as a source of supply for any items source coded above, except those coded X1 and aircraft support items as restricted by A-R 700-42.

(2) *Maintenance Code.* Indicates the lowest category of maintenance authorized to install the repair part and/or use the special tool or test equipment for each application. Capabilities of higher maintenance

categories are considered equal or better. Maintenance codes are:

| Code | Explanation |
|------|-----------------------------|
| C | Crew/operator |
| O | Organizational maintenance |
| F | Direct support maintenance |
| H | General support maintenance |
| D | Depot maintenance |

(3) *Recoverability Code.* Indicates whether unserviceable items should be returned for recovery or salvage. Items not coded are non-recoverable. Recoverability codes are:

| Code | Explanation |
|------|---|
| R | Repair parts (assembled and components), special tools and test equipment which are considered economically repairable at direct and general support maintenance levels. When the item is no longer economically repairable, it is normally disposed of at the GS level. When supply considerations dictate, some of these repair parts may be listed for automatic return to supply for depot level repair as set forth in AR 71 01. When so listed, they will be replaced by supply on an exchange basis. |
| S | Repair parts, special tools and test equipment, and assemblies which are economically repairable at DS and GS activities and which normally are furnished by supply on an exchange basis. When items are determined by a GSU to be uneconomically repairable, they will be evacuated to a depot for evaluation and analysis before final disposition. |
| T | High dollar value recoverable repair parts, special tools and test equipment which are subject to special handling and are issued on an exchange basis. Such items will be repaired or overhauled at depot maintenance activities only. No repair may be accomplished at lower levels. |
| U | Repair parts, special tools and test equipment specifically selected for salvage by reclamation units because of precious metal content, critical materials, high dollar value, or reusable casings or castings. |

b. *Federal Stock Number.* Indicates the Federal stock number assigned to the item and will be used for requisitioning purposes.

c. *Description.* Indicates the Federal item name and a minimum description required to identify the item. The last line indicates the reference number followed by the applicable Federal Supply code for manufacturer (FSCM) in parentheses. The FSCM is used as an element in item identification to designate manufacturer or distributor or Government agency, etc., and is identified in SB 708-42. Items that are included in kits and sets are listed below the name of the kit or set with quantity of each item in the kit or set indicated in front of the item name.

d. *Unit of Measure(U/M).* Indicates the standard or basic quantity by which the listed item is

used in performing the actual maintenance function. This measure is expressed by a two character alphabetical abbreviation, e.g., ea, in, pr, etc., and is the basis used to indicate quantities and allowances in subsequent columns. When the unit of measure differs from the unit of issue, the lowest unit of issue that will satisfy the required units of measure will be requisitioned.

e. *Quantity Incorporated in Unit.* Indicates the quantity of the item used in the breakout shown on the illustration figure, which is prepared for a functional group, subfunctional group, or assembly. A "V" appearing in this column in lieu of a quantity indicates that no specific quantity is applicable, e.g., shims, spacers, etc.

f. *30-Day DS/GS Maintenance Allowances.*

NOTE

Allowances in GS column are for GS Maintenance only.

The allowance columns are divided into three subcolumns. Items authorized for use are identified with an asterisk in the allowance column opposite the first appearance of each item. Subsequent appearances of the same item will have the letters "REF" in the applicable allowance columns.

g. *1-Year Allowances Per 100 Equipments /Contingency Planning Purposes.* This column indicates opposite the first appearance of each item the authorization for distribution and contingency planning purposes. The range of items indicates the authorization of all items required to provide for adequate support of 100 equipments for one year. Subsequent appearances of the same item will have the letters "REF" in this column.

h. *Depot Maintenance Allowance Per 100 Equipments.* Items authorized for use are identified with an asterisk. Subsequent appearances of the same item will have the letters "REF" in this column.

i. *Illustration.* This column is divided as follows:

(1) *Figure Number.* Indicates the figure number of the illustration in which the item is shown.

(2) *Item Number.* Indicates the callout number used to reference the item on the illustration.

B-4. Special Information

a. Usable on codes are included in Column 3. Uncoded items are applicable to all models. Identifications of the usable on codes used in this publication are:

| Code | Used On |
|------|--------------------|
| A | M14 |
| B | M14A1 |
| C | M14A1 and M2 Bipod |

b. Detailed assembly instructions for items

source coded "A" are found in this manual. Assembly components are listed immediately following the item to be assembled.

c. Action change codes indicated in the left-hand margin of the listing page denote the following:

- N - Indicates an added item.
- C - Indicates a change in data.
- R - Indicates a change in FSN only

B-5. How to Locate Repair Parts

a. When Federal stock number or reference number is unknown:

(1) *First.* Using the table of contents, determine the functional group within which the repair part belongs. This is necessary since illustrations are prepared for functional groups, and listings are divided into the same groups.

(2) *Second.* Find the illustration covering the functional group to which the repair part belongs.

(3) *Third.* Identify the repair part on the illustration and note the illustration figure and item number of the repair part.

(4) *Fourth.* Using the Repair Parts Listing, find the functional group to which the repair part belongs and locate the illustration figure and item number noted on the illustration.

b. When Federal stock number or reference number is known:

(1) *First.* Using the index of Federal Stock Numbers and Reference Numbers find the pertinent Federal stock number or reference number. This index is in ascending FSN sequence followed by a list of reference numbers in ascending alphameric sequence, cross-referenced to the illustration figure number and item number.

(2) *Second.* Using the Repair Parts Listing, find the functional group of the repair part and the illustration figure number and item number referenced in the Index of Federal Stock Numbers and Reference Numbers.

B-6. Abbreviations

| Abbreviations | Explanation |
|----------------------|-------------------------------|
| ck-hd | Countersunk head |
| cres..... | corrosion resistant steel |
| fil-hd..... | fillister head |
| fi..... | flat |
| hv-duty..... | heavy duty |
| NC | National coarse thread |
| NF..... | American National fine thread |
| phos-ctd..... | phosphate coated |
| S | Steel |
| thd | thread |
| UNF | Unified fine thread |
| VCI | volatile corrosion inhibitor |
| w/..... | with |

Section II. REPAIR PARTS LIST

| (1) SMR CODE | (2) FEDERAL STOCK NUMBER | (3) DESCRIPTION REFERENCE NUMBER & MFR. CODE USABLE ON CODE | | (4) UNIT OF MEAS | (5) QTY INC IN UNIT | (6) 30 DAY DS MAINT ALLOWANCE | | | (7) 30DAY GS MAINT ALLOWANCE | | | (8) 1-YR ALW PER 100 EQUIP CNTGCY | (9) DEPOT MAINT ALW PER 100 EQUIP | (10) ILLUSTRATION | |
|--------------------|-----------------------------------|--|--|---------------------------|---------------------------------|-------------------------------------|-------|--------|------------------------------------|-------|--------|--|--|----------------------|-------------|
| | | | | | | (a) | (b) | (c) | (a) | (b) | (c) | | | (a) | (b) |
| | | | | | | 1-20 | 21-50 | 51-100 | 1-20 | 21-50 | 51-100 | | | FIGURE NO. | ITEM NO/ |
| P C | 1005-628-9048 | MAJOR GROUPS AND ASSEMBLIES — RIFLE M14 | | EA | 1 | * | * | * | * | * | * | * | * | 1 | 1 |
| A F | | MAGAZINE, CARTRIDGE 20 CARTRIDGE CAPACITY 7790183 (19204) | | EA | 1 | .. | .. | .. | .. | .. | .. | .. | .. | 1 | 2 |
| X1 F | | FIRING MECHANISM: 7790195 (19204) | | EA | 1 | .. | .. | .. | .. | .. | .. | .. | .. | 1 | 3 |
| P O | 1005-856-2108 | STOCK ASSEMBLY: W/BUTT PLATE 11686428 (19204) | | EA | 1 | * | * | * | * | * | * | * | * | 1 | 4 |
| A F | | GUARD ASSEMBLY, HAND, FIBER GLASS: 7791286 (19207) | | EA | 1 | .. | .. | .. | .. | .. | .. | .. | .. | 1 | 5 |
| A F | | OPERATING ROD AND CONNECTOR GROUP BOLT ASSEMBLY: 7790187 (19204) | | EA | 1 | .. | .. | .. | .. | .. | .. | .. | .. | 1 | 6 |
| A F | | BARREL AND RECEIVER GROUP | | EA | 1 | .. | .. | .. | .. | .. | .. | .. | .. | 1 | 7 |
| P O | 1005-072-5376 | MAJOR GROUPS AND ASSEMBLIES-RIFLE M14A1 | | EA | 1 | * | * | * | * | * | * | * | * | 2 | 1 |
| A F | | SLING, SMALL ARMS: 11010038 (19204) | | EA | 1 | .. | .. | .. | .. | .. | .. | .. | .. | 2 | 2 |
| P C | 1005-628-9048 | BIPOD, RIFLE: M2 7790688 (19204) | | EA | 1 | REF | REF | REF | REF | REF | REF | REF | REF | 2 | 3 |
| A F | | MAGAZINE, CARTRIDGE: 20 CARTRIDGE CAPACITY 7790183 (19204) | | EA | 1 | .. | .. | .. | .. | .. | .. | .. | .. | 2 | 4 |
| XI F | | FIRING MECHANISM: 7790195 (19204) | | EA | 1 | .. | .. | .. | .. | .. | .. | .. | .. | 2 | 5 |
| P O | 1005-856-2108 | STOCK ASSEMBLY, GUN, SHOULDER: 11686528 (19204) | | EA | 1 | REF | REF | REF | REF | REF | REF | REF | REF | 2 | 6 |
| A F | | GUARD ASSEMBLY, HAND, FIBER GLASS. 7791286 (19204) | | EA | 1 | .. | .. | .. | .. | .. | .. | .. | .. | 2 | 7 |
| A F | | OPERATING ROD AND CONNECTOR GROUP BOLT ASSEMBLY 7790187 (19204) | | EA | 1 | .. | .. | .. | .. | .. | .. | .. | .. | 2 | 8 |
| P F | 1005-930-0806 | STABILIZER ASSEMBLY: MUZZLE, RIFLE 11686521 (19204) | | EA | 1 | * | * | * | * | * | * | * | * | 2 | 9 |
| A F | | BARREL AND RECEIVER GROUP | | EA | 1 | .. | .. | .. | .. | .. | .. | .. | .. | 2 | 10 |
| R P O | 5315-819-4501 | FIRING MECHANISM PIN, TRIGGER: 7791367 (19204) | | EA | 1 | * | * | * | * | * | * | * | * | 3 | 1 |

Section II. REPAIR PARTS LIST (Continued)

| (1) SMR CODE | (2) FEDERAL STOCK NUMBER | (3) DESCRIPTION REFERENCE NUMBER & MFR. CODE USABLE ON CODE | | (4) UNIT OF MEAS | (5) QTY INC IN UNIT | (6) 30 DAY DS MAINT ALLOWANCE | | | (7) 30DAY GS MAINT ALLOWANCE | | | (8) 1-YR ALW PER 100 EQUIP CNTGCY | (9) DEPOT MAINT ALW PER 100 EQUIP | (10) ILLUSTRATION | |
|--------------------|-----------------------------------|--|--|---------------------------|---------------------------------|-------------------------------------|-------|--------|------------------------------------|-------|--------|--|--|----------------------|-------------|
| | | | | | | (a) | (b) | (c) | (a) | (b) | (c) | | | (a) | (b) |
| | | | | | | 1-20 | 21-50 | 51-100 | 1-20 | 21-50 | 51-100 | | | FIGURE NO. | ITEM NO/ |
| P O | 1005-587-8419 | TRIGGER AND SEAR ASSEMBLY: 7267090 (19204) | | EA | 1 | * | * | * | * | * | * | * | * | 3 | 2 |
| P F | 1005-600-8883 | HOUSING, HAMMER SPRING: FIRING MECHANISM 6008883 (19204) | | EA | 1 | * | * | * | * | * | * | * | * | 3 | 3 |
| P O | 1005-600-8887 | SPRING, HELICAL, COMPRESSION: S, 0.063 STK DIA, 0.361 FREE OD, 2.150 FREE O/A LG, 20 COILS HAMMER 6008887 119204) | | EA | 1 | * | * | * | * | * | * | * | * | 3 | 4 |
| P F | 1005-600-8880 | PLUNGER, HAMMER SPRING: 6008880 (19204) | | EA | 1 | * | * | * | * | * | * | * | * | 3 | 5 |
| P O | 5315-501-3668 | PIN, STRAIGHT, HEADED: FL-FIL-HD, S, PHOS- CTD, 0.187 MAX DIA, 3/4 UNDER HD, HAMMER 5013668 (19204) | | EA | 1 | * | * | * | * | * | * | * | * | 3 | 6 |
| P F | 1005-554-6008 | HAMMER: FIRING 5546008 (19204) | | EA | 1 | * | * | * | * | * | * | * | * | 3 | 7 |
| P O | 1005-554-6015 | SAFETY, SMALL ARMS: CATCH TYPE HOLDING DEVICE, 0.197 DIA 5546015 (19204) | | EA | 1 | * | * | * | * | * | * | * | * | 3 | 8 |
| P O | 1005-587-8414 | SPRING, SAFETY: 7267080 (19204) | | EA | 1 | * | * | * | * | * | * | * | * | 3 | 9 |
| P F | 1005-587-6988 | GUARD, TRIGGER: FIRING MECHANISM 7790990 (19204) | | EA | 1 | * | * | * | * | * | * | * | * | 3 | 10 |
| P F | 1005-628-9055 | HOUSING, TRIGGER: 7790196 (19204) | | EA | 1 | * | * | * | * | * | * | * | * | 3 | 11 |
| R P F | 5315-994-4242 | PIN, SPRING, TUBULAR COILED: S, 0.010 STK SIZE, 0.121 OD, 0.640 LG 7791418 (19204) | | EA | 1 | * | * | * | * | * | * | * | * | 3 | 12 |
| P F | 1005-587-8389 | LATCH, MAGAZINE: HOUSING ASSY, TRIGGER 7267032 (19204) | | EA | 1 | * | * | * | * | * | * | * | * | 3 | 13 |
| R P F | 5360-587-8395 | SPRING, MAGAZINE LATCH: 7267041 (19204) | | EA | 1 | * | * | * | * | * | * | * | * | 3 | 14 |
| X1 F | | HOUSING, TRIGGER: 7267030 (19204) | | EA | 1 | .. | .. | .. | .. | .. | .. | .. | .. | 3 | 15 |
| P F R | 1005-999-1871 | STOCK ASSEMBLY WITH BUTT PLATE-RIFLE M14 STOCK SUBASSEMBLY, GUN, SHOULDER: 5010348 (19204) | | EA | 1 | * | * | * | * | * | * | * | * | 4 | 1 |

Section II. REPAIR PARTS LIST (Continued)

| (1) SMR CODE | (2) FEDERAL STOCK NUMBER | (3) DESCRIPTION REFERENCE NUMBER & MFR. CODE USABLE ON CODE | | (4) UNIT OF MEAS | (5) QTY INC IN UNIT | (6) 30 DAY DS MAINT ALLOWANCE | | | (7) 30DAY GS MAINT ALLOWANCE | | | (8) 1-YR ALW PER 100 EQUIP CNTGCY | (9) DEPOT MAINT ALW PER 100 EQUIP | (10) ILLUSTRATION | |
|--------------------|-----------------------------------|---|---|---------------------------|---------------------------------|-------------------------------------|-------|--------|------------------------------------|-------|--------|--|--|----------------------|-------------|
| | | | | | | (a) | (b) | (c) | (a) | (b) | (c) | | | (a) | (b) |
| | | | | | | 1-20 | 21-50 | 51-100 | 1-20 | 21-50 | 51-100 | | | FIGURE NO. | ITEM NO/ |
| P F | 5305-999-1875 | SCREW, SHOULDER STOCK SSSY, GUN, SHOULDER 7791267 (19204) | A | EA | 1 | * | * | * | * | * | * | * | * | 4 | 2 |
| P F | 5340-999-1864 | RETAINER, NUT AND BOLT STOCK ASSY, GUN, SHOULDER 11010414 (19204) | A | EA | 1 | * | * | * | * | * | * | * | * | 4 | 3 |
| P F | 5310-999-1891 | NUT, PLAIN, SQUARE STOCK ASSY, GUN, SHOULDER 7791339 (19204) | A | EA | 1 | * | * | * | * | * | * | * | * | 4 | 4 |
| P F | 5305-600-8881 | SCREW, MACHINE: FIL-CK-HD, SLOT DRIVE, S, PHOS-CTD, NO. 12 (0.216)-28NF-2A, 3.140 MAX LG: 6008881 (19204) | A | EA | 1 | * | * | * | * | * | * | * | * | 4 | 5 |
| P F | 1005-600-8889 | SWIVEL-BUTT STOCK 6008889 (19204) | A | EA | 1 | * | * | * | * | * | * | * | * | 4 | 6 |
| P F | 1005-690-4067 | PLATE ASSEMBLY, BUTT, HINGED: W/SHOULDER REST 7790686 (19204) | A | EA | 1 | * | * | * | * | * | * | * | * | 4 | 7 |
| C P D | 5315-981-1254 | PIN, SPRING: 7790695 (19204) | A | EA | 2 | .. | .. | .. | .. | .. | .. | .. | * | 4 | 8 |
| P D | 1005-981-1255 | PLATE, SHOULDER REST: 7790697 (19204) | A | EA | 1 | .. | .. | .. | .. | .. | .. | .. | * | 4 | 9 |
| C P D | 3110-100-6151 | BALL, BEARING: MS 19059-88 (96906) | A | HD | 1 | .. | .. | .. | .. | .. | .. | .. | * | 4 | 10 |
| P D | 1005-501-3747 | SPRING, HELICAL, COMPRESSION: PLATE ASSY: 5013747 (19204) | A | EA | 1 | .. | .. | .. | .. | .. | .. | .. | * | 4 | 11 |
| P D | 5315-597-5086 | PIN, SPRING: S, PHOS-CTD, 1/16 DIA, 3/8 LG MS 16562-98 (96906) | A | HD | 1 | .. | .. | .. | .. | .. | .. | .. | * | 4 | 12 |
| P D | 1005-981-1252 | CATCH, BUTT PLATE. 7790693 (19204) | A | EA | 1 | .. | .. | .. | .. | .. | .. | .. | * | 4 | 13 |
| P D | 1005-981-1256 | SPRING, HELICAL, COMPRESSION: 7790699 (19204) | A | EA | 1 | .. | .. | .. | .. | .. | .. | .. | * | 4 | 14 |
| X1 F | | PIN, STRAIGHT, HEADLESS: S, 0.126 DIA X 1.00 LG, BUTT, PLATE CAP 5152865 (19204) | A | EA | 1 | .. | .. | .. | .. | .. | .. | .. | .. | 4 | 15 |
| X1 F | | PLUNGER, BUTT PLATE: 7790698 (19204) | A | EA | 1 | .. | .. | .. | .. | .. | .. | .. | .. | 4 | 16 |
| X1 F | | CAP: BUTT PLATE 7790692 (19204) | A | EA | 1 | .. | .. | .. | .. | .. | .. | .. | .. | 4 | 17 |
| X1 F | | PLATE ASSEMBLY: (WELDMENT) 7790700 (19204) | A | EA | 1 | .. | .. | .. | .. | .. | .. | .. | .. | 4 | 18 |

Section II. REPAIR PARTS LIST (Continued)

| (1) SMR CODE | (2) FEDERAL STOCK NUMBER | (3) DESCRIPTION REFERENCE NUMBER & MFR. CODE USABLE ON CODE | | (4) UNIT OF MEAS | (5) QTY INC IN UNIT | (6) 30 DAY DS MAINT ALLOWANCE | | | (7) 30DAY GS MAINT ALLOWANCE | | | (8) 1-YR ALW PER 100 EQUIP CNTGCY | (9) DEPOT MAINT ALW PER 100 EQUIP | (10) ILLUSTRATION | |
|--------------------|-----------------------------------|---|---|---------------------------|---------------------------------|-------------------------------------|-------|--------|------------------------------------|-------|--------|--|--|----------------------|-------------|
| | | | | | | (a) | (b) | (c) | (a) | (b) | (c) | | | (a) | (b) |
| | | | | | | 1-20 | 21-50 | 51-100 | 1-20 | 21-50 | 51-100 | | | FIGURE NO. | ITEM NO/ |
| X1 F | | STOCK ASSEMBLY: W/O BUTT PLATE 11686427 (19204) | A | EA | 1 | .. | .. | .. | .. | .. | .. | .. | .. | 4 | 19 |
| P O | 1005-072-5386 | SHOULDER GUN STOCK ASSEMBLY-RIFLE, M14A1 PLUG, RECOIL PAD: STOCK ASSY, RIFLE 77916741 (19204) | B | EA | 2 | * | * | * | * | * | * | * | * | 5 | 1 |
| R P F | 5305-072-5388 | SCREW, MACHINE: RECOIL PAD, STOCK ASSY, RIFLE 7791676 (19204) | B | EA | 1 | * | * | * | * | * | * | * | * | 5 | 2 |
| R P F | 5340-072-5379 | BUSHING, SWIVEL: STOCK ASSY, RIFLE 11010047 (19204) | B | EA | 1 | * | * | * | * | * | * | * | * | 5 | 3 |
| P F | 1005-072-5378 | SWIVEL, GUN SLING: 11010046 (19204) | C | EA | 1 | * | * | * | * | * | * | * | * | 5 | 4 |
| R P F | 5305-072-5389 | SCREW, RECOIL PAD: STOCK ASSY, RIFLE (WOOD SCREW) 7791677 (19204) | B | EA | 1 | * | * | * | * | * | * | * | * | 5 | 5 |
| P F | 1005-072-5385 | PAD, RECOIL: STOCK ASSY, RIFLE 7791673 (19204) | B | EA | 1 | * | * | * | * | * | * | * | * | 5 | 6 |
| P F | 1005-614-6873 | SCREW, BUTT PLATE, SMALL: 6146873 (19204) | B | EA | 2 | * | * | * | * | * | * | * | * | 5 | 7 |
| P F | 1005-072-5390 | REST ASSEMBLY, SHOULDER: STOCK ASSY, RIFLE 7791678 (192041) | B | EA | 1 | * | * | * | * | * | * | * | * | 5 | 8 |
| R P D | 5315-016-2624 | PIN, REST ASSEMBLY, SHOULDER: 7791682 (19204) | B | EA | 1 | .. | .. | .. | .. | .. | .. | .. | * | 5 | 9 |
| X1 F | | PLATE, SHOULDER REST: 7791683 (19204) | B | EA | 1 | .. | .. | .. | .. | .. | .. | .. | .. | 5 | 10 |
| X1 F | | BRACKET ASSEMBLY: SHOULDER REST 7792062 (19204) | B | EA | 1 | .. | .. | .. | .. | .. | .. | .. | .. | 5 | 11 |
| P F | R 1005-999-4200 | STOCK, GUN, SHOULDER: 59104381 (19204) | B | EA | 1 | * | * | * | * | * | * | * | * | 5 | 12 |
| R P F | 5340-904-9303 | GROMMET, RUBBER: 11686524 (19204) | B | EA | 4 | * | * | * | * | * | * | * | * | 5 | 13 |
| P F | 5305-956-3401 | SCREW, MACHINE: FL-CK-HD, SLOT DRIVE, S, NO. 10-32UNF-2A, 0.400 MIN LG OF THD, 0.625 MAX LG 11686523 (19204) | B | EA | 2 | * | * | * | * | * | * | * | * | 5 | 14 |
| P F | 5310-194-9209 | WASHER, LOCK: S, CD-PLTD, EXT-TEETH, COUNTERSUNK, NOM-SIZE NO. 10, 0.025 THK, 2.354 OD MS 35336-21 (96906) | B | HD | 2 | * | * | * | * | * | * | * | * | 5 | 15 |

Section II. REPAIR PARTS LIST (Continued)

| (1) SMR CODE | (2) FEDERAL STOCK NUMBER | (3) DESCRIPTION REFERENCE NUMBER & MFR. CODE USABLE ON CODE | | (4) UNIT OF MEAS | (5) QTY INC IN UNIT | (6) 30 DAY DS MAINT ALLOWANCE | | | (7) 30DAY GS MAINT ALLOWANCE | | | (8) 1-YR ALW PER 100 EQUIP CNTGCY | (9) DEPOT MAINT ALW PER 100 EQUIP | (10) ILLUSTRATION | |
|--------------------|-----------------------------------|--|---|---------------------------|---------------------------------|-------------------------------------|-------|--------|------------------------------------|-------|--------|--|--|----------------------|-------------|
| | | | | | | (a) | (b) | (c) | (a) | (b) | (c) | | | (a) | (b) |
| | | | | | | 1-20 | 21-50 | 51-100 | 1-20 | 21-50 | 51-100 | | | FIGURE NO. | ITEM NO/ |
| P F | 1005-951-3254 | PLATE, BACKING, HANDGRIP: STOCK ASSY, GUN, SHOULDER 11686522 (19204) | B | EA | 1 | * | * | * | * | * | * | * | * | 5 | 16 |
| P F | 1005-072-5377 | HANDGRIP ASSEMBLY- 11010044 (19204) | B | EA | 1 | * | * | * | * | * | * | * | * | 5 | 17 |
| P D | 5315-836-0643 | PIN, SPRING: S, PHOS-CTD, TUBULAR, COILED, HV-Duty, 3/16 NOM DIA, 7/8 LG MS 39086-205 (96906) | B | EA | 1 | .. | .. | .. | .. | .. | .. | .. | .. | 5 | 18 |
| P D | 1005-016-2623 | GRIP, RIFLE 7791672 (19204) | B | EA | 1 | .. | .. | .. | .. | .. | .. | .. | .. | 5 | 19 |
| P F | 5315-269-4080 | PIN, SPRING: S, PHOS-CTD, 0.187 NOM DIA. 1.750 LG MS 39086-211 (96906) | B | EA | 1 | * | * | * | * | * | * | * | * | 5 | 20 |
| X1 F | | HAND GRIP 11010001 (19204) | B | EA | 1 | .. | .. | .. | .. | .. | .. | .. | .. | 5 | 21 |
| P D | 5315-050-1233 | PIN, SPRINGS, PHOS-CTD, 3/16 DIA, 1/2 LG, 0.202 EXPANDED DIA MS 39086-202 (96906) | B | EA | 1 | .. | .. | .. | .. | .. | .. | .. | * | 5 | 22 |
| P D | 1005-600-8890 | SWIVEL, STOCK: FERRULE 6008890 (19204) | B | EA | 1 | .. | .. | .. | .. | .. | .. | .. | * | 5 | 23 |
| P D | 1005-016-2621 | BLOCK HANDGRIP- HANDGRIP ASSY 110100041 (9204) | B | EA | 1 | .. | .. | .. | .. | .. | .. | .. | * | 5 | 24 |
| X1 F | | STOCK, SUBASSEMBLY, GUN SHOULDER 11686527(19204) | B | EA | 1 | .. | .. | .. | .. | .. | .. | .. | .. | 5 | 25 |
| P F | 1005-678-9824 | OPERATING ROD AND CONNECTOR GROUP CONNECTOR ASSEMBLY 7790424 (19204) | | EA | 1 | * | * | * | * | * | * | * | * | 6 | 1 |
| P O | 5315-051-6891 | PIN, SPRINGS, PHOS-CTD, 5/64 NOM DIA, 3/8 LG MS 16562-107 (96906) | | HD | 3 | * | * | * | * | * | * | * | * | 6 | 2 |
| P D | 1005-678-9826 | PLUNGER, CONNECTOR 7790426 (19204) | | EA | 1 | | | | | | | | * | 6 | 3 |
| P D | 1005-678-9827 | SPRING, HELICAL, COMPRESSION: S, 0.0451 DIA STK, 0 230 OD, 9 COILS, CONNECTOR ASSY 7790427 (19204) | | EA | 1 | .. | .. | .. | .. | .. | .. | .. | * | 6 | 4 |
| X1 F | | BODY CONNECTOR 7790425 (19204) | | EA | 1 | .. | .. | .. | .. | .. | .. | .. | .. | 6 | 5 |
| P F | 1005-587-8386 | GUIDE, OPERATING ROD, SPRING 7267027 (19204) | | EA | 1 | * | * | * | * | * | * | * | * | 6 | 6 |
| P O | 1005-587-8413 | SPRING, OPERATING ROD 7267107 (19204) | | EA | 1 | * | * | * | * | * | * | * | * | 6 | 7 |

Section II. REPAIR PARTS LIST (Continued)

| (1) SMR CODE | (2) FEDERAL STOCK NUMBER | (3) DESCRIPTION REFERENCE NUMBER & MFR. CODE USABLE ON CODE | | (4) UNIT OF MEAS | (5) QTY INC IN UNIT | (6) 30 DAY DS MAINT ALLOWANCE | | | (7) 30DAY GS MAINT ALLOWANCE | | | (8) 1-YR ALW PER 100 EQUIP CNTGCV | (9) DEPOT MAINT ALW PER 100 EQUIP | (10) ILLUSTRATION | |
|--------------------|-----------------------------------|--|--|---------------------------|---------------------------------|-------------------------------------|-------|--------|------------------------------------|-------|--------|--|--|----------------------|-------------|
| | | | | | | (a) | (b) | (c) | (a) | (b) | (c) | | | (a) | (b) |
| | | | | | | 1-20 | 21-50 | 51-100 | 1-20 | 21-50 | 51-100 | | | FIGURE NO. | ITEM NO/ |
| P F | 1005-587-8404 | ROD, OPERATING: 7267064 (19204) | | EA | 1 | * | * | * | * | * | * | * | * | 6 | 8 |
| P O | 1005-953-9504 | BOLT ASSEMBLY EXTRACTOR, SMALL ARMS CARTRIDGE: 7791578 (19204) | | EA | 1 | * | * | * | * | * | * | * | * | 7 | 1 |
| P O | 1005-587-8381 | EJECTOR, CARTRIDGE WITH SPRING: BOLT ASSY 7267015 (19204) | | EA | 1 | * | * | * | * | * | * | * | * | 7 | 2 |
| P O | 1005-600-8618 | PLUNGER, EXTRACTOR SPRING: 6008618 (19204) | | EA | 1 | * | * | * | * | * | * | * | * | 7 | 3 |
| P O | 1005-921-5248 | PIN, FIRING: 11686413 (19204) | | EA | 1 | * | * | * | * | * | * | * | * | 7 | 4 |
| P F | 1005-628-9050 | BOLT, BREECH. 7790186 (19204) | | EA | 1 | * | * | * | * | * | * | * | * | 7 | 5 |
| C P F | 3120-587-8405 | ROLLER, LINEAR-ROTARY Motion: 7267065 (19204) | | EA | 1 | * | * | * | * | * | * | * | * | 7 | 6 |
| P F | 1005-587-8402 | RETAINER, BOLT ROLLER: 7267059 (19204) | | EA | 1 | * | * | * | * | * | * | * | * | 7 | 7 |
| X1 F | | BOLT 7790185 (19204) | | EA | 1 | .. | .. | .. | .. | .. | .. | .. | .. | 7 | 8 |
| P O | 1005-999-3399 | BARREL AND RECEIVER GROUP PINION ASSEMBLY, REAR SIGHT ELEVATING: 11010363 (19204) | | EA | 1 | * | * | * | * | * | * | * | * | 8 | 1 |
| P O | 1005-731-2737 | KNOB: WINDAGE, REAR SIGHT 7312737 (19204) | | EA | 1 | * | * | * | * | * | * | * | * | 8 | 2 |
| P O | 1005-600-8868 | APERTURE SIGHT: 6008868 (19204) | | EA | 1 | * | * | * | * | * | * | * | * | 8 | 3 |
| P F | 1005-600-8872 | COVER, REAR SIGHT: 6008872 (19204) | | EA | 1 | * | * | * | * | * | * | * | * | 8 | 4 |
| P F | 1005-554-6001 | BASE: REAR SIGHT 5546001 (19204) | | EA | 1 | * | * | * | * | * | * | * | * | 8 | 5 |
| P O | 5315-051-6891 | PIN, SPRING: S, PHOS-CTD, 5/64 NOM DIA, 3/8 LG MS 16562-107 (96906) | | HD | 3 | REF | REF | REF | REF | REF | REF | REF | REF | 8 | 6 |
| P O | 1005-587-8420 | LOCK, SELECTOR SHAFT: S, 0.260 ID, 0.028 OD, 0.056 THD 7267172 (19204) | | EA | 1 | * | * | * | * | * | * | * | * | 8 | 7 |
| P O | 1005-587-8408 | SELECTOR: AUTOMATIC AND SEMI-AUTOMATIC FIRING 7267071 (19204) | | EA | 1 | * | * | * | * | * | * | * | * | 8 | 8 |

Section II. REPAIR PARTS LIST (Continued)

| (1) SMR CODE | (2) FEDERAL STOCK NUMBER | (3) DESCRIPTION REFERENCE NUMBER & MFR. CODE USABLE ON CODE | | (4) UNIT OF MEAS | (5) QTY INC IN UNIT | (6) 30 DAY DS MAINT ALLOWANCE | | | (7) 30DAY GS MAINT ALLOWANCE | | | (8) 1-YR ALW PER 100 EQUIP CNTGCY | (9) DEPOT MAINT ALW PER 100 EQUIP | (10) ILLUSTRATION | |
|--------------------|-----------------------------------|--|--|---------------------------|---------------------------------|-------------------------------------|-------|--------|------------------------------------|-------|--------|--|--|----------------------|-------------|
| | | | | | | (a) | (b) | (c) | (a) | (b) | (c) | | | (a) | (b) |
| | | | | | | 1-20 | 21-50 | 51-100 | 1-20 | 21-50 | 51-100 | | | FIGURE NO. | ITEM NO/ |
| P O | 1005-587-8415 | SPRING, SELECTOR: 7267081 (19204) | | EA | 1 | * | * | * | * | * | * | * | * | 8 | 9 |
| P F | 1005-587-8409 | SHAFT, SELECTOR: 7267072 (19204) | | EA | 1 | * | * | * | * | * | * | * | * | 8 | 10 |
| P F | 1005-628-9053 | RELEASE, SEAR: 7790192 (19204) | | EA | 1 | * | * | * | * | * | * | * | * | 8 | 11 |
| P O | 1005-587-8400 | PLUG, GAS CYLINDER: 7267053 (19204) | | EA | 1 | * | * | * | * | * | * | * | * | 8 | 12 |
| P F | 1005-587-8398 | PISTON: GAS CYLINDER 7267047 (19204) | | EA | 1 | * | * | * | * | * | * | * | * | 8 | 13 |
| P O | 5305-042-6426 | SETSCREW: HEX-SOCKET, NON-STD PT, 0.092 MAX DIA, 0.070 LG, S, PHOS-CTD, NO, 6-40 UNF- 3A, 1/4 LG 7790300 (19204) | | EA | 1 | * | * | * | * | * | * | * | * | 8 | 14 |
| R P F | 5310-587-8394 | NUT, PLAIN, ROUND: FLASH SUPPRESSOR 7267039 (19204) | | EA | 1 | * | * | * | * | * | * | * | * | 8 | 15 |
| P F | 1005-545-1573 | SUPPRESSOR, FLASH: RIFLE 7791053 (19204) | | EA | 1 | * | * | * | * | * | * | * | * | 8 | 16 |
| P F | 5305-921-6155 | SCREW, CAP, SOCKET HEAD, HEXAGON: 11010298 (19204) | | EA | 1 | * | * | * | * | * | * | * | * | 8 | 17 |
| P F | 1005-084-8435 | SIGHT, FRONT: 7191445 (19204) | | EA | 1 | * | * | * | * | * | * | * | * | 8 | 18 |
| P F | 1005-628-9051 | LOCK, GAS CYLINDER: 7790188 (19204) | | EA | 1 | * | * | * | * | * | * | * | * | 8 | 19 |
| P F | 1005-790-8766 | CYLINDER, GAS, RIFLE: 7790902 (19204) | | EA | 1 | * | * | * | * | * | * | * | * | 8 | 20 |
| P F | 1005-587-8421 | SPINDLE, VALVE: 7267604 (19204) | | EA | 1 | * | * | * | * | * | * | * | * | 8 | 21 |
| P F | 1005-587-8422 | SPRING, VALVE: 7267605 (19204) | | EA | 1 | * | * | * | * | * | * | * | * | 8 | 22 |
| P F | 1005-587-8375 | BAND, FRONT: 7267001 (19204) | | EA | 1 | * | * | * | * | * | * | * | * | 8 | 23 |
| P F | 5315-923-9440 | PIN, SPRING: CRES, PASS-FIN, 1/8 DIA, 3/4 LG MS 51923-465 (96906) | | EA | 1 | * | * | * | * | * | * | * | * | 8 | 24 |
| P F | 1005-587-8385 | GUIDE, OPERATING ROD: 7267025 (19204) | | EA | 1 | * | * | * | * | * | * | * | * | 8 | 25 |
| P F | 5315-839-0897 | PIN, SPRING: S, PHOS-CTD, 3/32 NOM DIA, 1 LG, 0.022 THK MATERIAL, TUBULAR, SLOT- TED MS 16562-124 496906) | | EA | 1 | * | * | * | * | * | * | * | * | 8 | 26 |

Section II. REPAIR PARTS LIST (Continued)

| (1) SMR CODE | (2) FEDERAL STOCK NUMBER | (3) DESCRIPTION REFERENCE NUMBER & MFR. CODE USABLE ON CODE | | (4) UNIT OF MEAS | (5) QTY INC IN UNIT | (6) 30 DAY DS MAINT ALLOWANCE | | | (7) 30DAY GS MAINT ALLOWANCE | | | (8) 1-YR ALW PER 100 EQUIP CNTGCY | (9) DEPOT MAINT ALW PER 100 EQUIP | (10) ILLUSTRATION | |
|--------------------|-----------------------------------|--|---|---------------------------|---------------------------------|-------------------------------------|-------|--------|------------------------------------|-------|--------|--|--|----------------------|-------------|
| | | | | | | (a) | (b) | (c) | (a) | (b) | (c) | | | (a) | (b) |
| | | | | | | 1-20 | 21-50 | 51-100 | 1-20 | 21-50 | 51-100 | | | FIGURE NO. | ITEM NO/ |
| P F | 1005-587-8390 | LOCK, BOLT 7267034 (19204) | | EA | 1 | * | * | * | * | * | * | * | * | 8 | 27 |
| P F | 1005-587-8411 | SPRING, BOLT LOCK: 7267074 (19204) | | EA | 1 | * | * | * | * | * | * | * | * | 8 | 28 |
| C P F | 5315-587-8396 | PIN, STRAIGHT, HEADLESS: 7267042 (19204) | | EA | 1 | * | * | * | * | * | * | * | * | 8 | 29 |
| C P F | 5315-587-8391 | PIN, STRAIGHT, HEADLESS: 7267035 (19204) | | EA | 1 | * | * | * | * | * | * | * | * | 8 | 30 |
| P F | 5315-051-8636 | PIN, SPRING: S, PHOS-CTD, 3/32 X 9/16 MS 16562-210 (96906) | | EA | 1 | * | * | * | * | * | * | * | * | 8 | 31 |
| P F | 1005-628-9049 | GUIDE, CARTRIDGE CLIP: 7790184 (19204) | | EA | 1 | * | * | * | * | * | * | * | * | 8 | 32 |
| P D | 1005-628-9052 | BARREL, RIFLE: 7790190 (19204) | | EA | 1 | .. | .. | .. | .. | .. | .. | .. | * | 8 | 33 |
| X | | RECEIVER: | | EA | 1 | .. | .. | .. | .. | .. | .. | .. | .. | 8 | 34 |
| | | STABILIZER ASSEMBLY | | | | | | | | | | | | | |
| P F | 5315-929-0862 | PIN, SHOULDER, HEADED: 7791664 (19204) | | EA | 1 | * | * | * | * | * | * | * | * | 9 | 1 |
| P F | 5310-962-0873 | WASHER, FLAT: S, 0.098 ID, 0.315 OD, 0.060 THK 7791668 (19204) | B | EA | 1 | * | * | * | * | * | * | * | * | 9 | 2 |
| P F | 1005-951-3232 | YOKE, ASSEMBLY: STABILIZER ASSY, MUZZLE 11686520 (19204) | B | EA | 1 | * | * | * | * | * | * | * | * | 9 | 3 |
| R P F | 5306-956-3127 | BOLT, EXTERNALLY RELIEVED BODY: S, PHOS-CTD-FIN, 1/4-28UNF-3A, 1.215 LG 11686519 (19204) | B | EA | 1 | * | * | * | * | * | * | * | * | 9 | 4 |
| P F | 5310-953-6340 | NUT, PLAIN, HEXAGON: S, 1/4-28UNF-3B, 0.375 W ACROSS FLATS, 0.270 O/A H 7791663 (19204) | B | EA | 1 | * | * | * | * | * | * | * | * | 9 | 5 |
| X1 F | | YOKE, MUZZLE STABILIZER: 11686517 (19204) | B | EA | 1 | .. | .. | .. | .. | .. | .. | .. | .. | 9 | 6 |
| P D | 1005-951-3056 | STOP, MUZZLE STABILIZER: 11686518 (19204) | B | EA | 1 | .. | .. | .. | .. | .. | .. | .. | .. | 9 | 7 |
| X1 F | | STABILIZER, MUZZLE: 7791667 (19204) | B | EA | 1 | .. | .. | .. | .. | .. | .. | .. | .. | 9 | 8 |
| | | RIFLE BIPOD, M2 | | | | | | | | | | | | | |
| C P F | 5315-282-3642 | PIN, SPRING: S, PHOS-CTD, 1/16 DIA, 1/4, LG MS 16562-96 (96906) | C | EA | 2 | | | | | | | | | 10 | 1 |

Section II. REPAIR PARTS LIST (Continued)

| (1) SMR CODE | (2) FEDERAL STOCK NUMBER | (3) DESCRIPTION REFERENCE NUMBER & MFR. CODE USABLE ON CODE | | (4) UNIT OF MEAS | (5) QTY INC IN UNIT | (6) 30 DAY DS MAINT ALLOWANCE | | | (7) 30DAY GS MAINT ALLOWANCE | | | (8) 1-YR ALW PER 100 EQUIP CNTGCV | (9) DEPOT MAINT ALW PER 100 EQUIP | (10) ILLUSTRATION | |
|--------------------|-----------------------------------|--|---|---------------------------|---------------------------------|-------------------------------------|-------|--------|------------------------------------|-------|--------|--|--|----------------------|-------------|
| | | | | | | (a) | (b) | (c) | (a) | (b) | (c) | | | (a) | (b) |
| | | | | | | 1-20 | 21-50 | 51-100 | 1-20 | 21-50 | 51-100 | | | FIGURE NO. | ITEM NO/ |
| P F | 1005-772-6361 | BUTTON, PLUNGER, PIVOT: S, 0.309 BODY DIA, 0.380 FLANGE DIA, 0300 O/A LG 7790820 (19204) | C | EA | 2 | * | * | * | * | * | * | * | * | 10 | 2 |
| P F | 1005-772-6365 | SPRING, HELICAL, COMPRESSION: S, 0.034 STK DIA, 0.290 FREE OD, 3/8 FREE O/A LG, 3.5 COILS | C | EA | 2 | * | * | * | * | * | * | * | * | 10 | 3 |
| P F | 1005-740-0053 | 7790824 (19204) PLUNGER, PIVOT 0.155 DIA OF SHANK, 0.722 LG OF SHANK, 0.311 DIA OF BODY, 0.375 LG OF BODY, 0.438 DIA OF HEAD, 0.053 LG OF HD, 1.150 O/A LG 7792846(19204) | C | EA | 2 | * | * | * | * | * | * | * | * | 10 | 4 |
| P F | 1005-772-6363 | LEG ASSEMBLY, BIPOD, RIGHT HAND: 7790822 (19204) | C | EA | 1 | * | * | * | * | * | * | * | * | 10 | 5 |
| P D | 5315-514-2358 | PIN, SPRING: S, PHOS-CTD, 1/16 X 7/16 MS 16562-99 (96906) | C | EA | 2 | .. | .. | .. | .. | .. | .. | .. | * | 10 | 6 |
| X1 F | | PLUNGER, LEG EXTENSION- 7790836 (19204) | C | EA | 2 | .. | .. | .. | .. | .. | .. | .. | .. | 10 | 7 |
| P D | 1005-897-6156 | SPRING, HELICAL, COMPRESSIONS, 0.260 O D, 0.198 ID, 0. 0310 DIA OF WIRE, 5.5 COILS 7790838 (19204) | C | EA | 2 | .. | .. | .. | .. | .. | .. | .. | * | 10 | 8 |
| R P H | 5315-839-2327 | PIN, SPRING: S, PHOS-CTD, 1/8 DIA, 3/8 LG MS 39086-88 (96906) | C | EA | 2 | .. | .. | .. | * | * | * | * | * | 10 | 9 |
| X1 F | | SHAFT ASSEMBLY- LEG, RH 7790840 (19204) | C | EA | 1 | .. | .. | .. | .. | .. | .. | .. | .. | 10 | 10 |
| C P F | 5310-934-9748 | NUT, PLAIN, HEXAGON: S, CRES PASS, NO. 4-40NC-2B, 1/4 W ACROSS FLATS, 3/32 THK MS 35649-244 (96906) | C | EA | 2 | * | * | * | * | * | * | * | * | 10 | 11 |
| P F | 5305-978-9342 | SCREW, CAP, SOCKET HEAD: FL-FIL-HD, SOCKET RECESS DR, S, CD-PLTD W/ CHROMATE-FIN, NO. 4-40NC-3A, 1/4 LG MS 16997-9 (96906) | C | EA | 2 | * | * | * | * | * | * | * | * | 10 | 12 |
| X1 F | | EXTENSION ASSEMBLY: LEG, RH 7790839 (19204) | C | EA | 1 | .. | .. | .. | .. | .. | .. | .. | .. | 10 | 13 |
| P F | 1005-772-6362 | LEG ASSEMBLY, BIPOD, LEFT HAND: 7790821 (19204) | C | EA | 1 | * | * | * | * | * | * | * | * | 10 | 14 |
| X1 F | | SHAFT ASSEMBLY: LEG LH 7790837 (19204) | C | EA | 1 | .. | .. | .. | .. | .. | .. | .. | .. | 10 | 15 |
| X1 F | | EXTENSION ASSEMBLY: LEG, LH 7790835 (19204) | C | EA | 1 | .. | .. | .. | .. | .. | .. | .. | .. | 10 | 16 |
| X1 F | | YOKE ASSEMBLY, BIPOD 7791106 (19204) | D | EA | 1 | .. | .. | .. | .. | .. | .. | .. | .. | 10 | 17 |

Section II. REPAIR PARTS LIST (Continued)

| (1) SMR CODE | (2) FEDERAL STOCK NUMBER | (3) DESCRIPTION REFERENCE NUMBER & MFR. CODE USABLE ON CODE | | (4) UNIT OF MEAS | (5) QTY INC IN UNIT | (6) 30 DAY DS MAINT ALLOWANCE | | | (7) 30DAY GS MAINT ALLOWANCE | | | (8) 1-YR ALW PER 100 EQUIP CNTGCY | (9) DEPOT MAINT ALW PER 100 EQUIP | (10) ILLUSTRATION | |
|--------------------|-----------------------------------|--|--|---------------------------|---------------------------------|-------------------------------------|-------|--------|------------------------------------|-------|--------|--|--|----------------------|-------------|
| | | | | | | (a) | (b) | (c) | (a) | (b) | (c) | | | (a) | (b) |
| | | | | | | 1-20 | 21-50 | 51-100 | 1-20 | 21-50 | 51-100 | | | FIGURE NO. | ITEM NO/ |
| P F | 5315-815-1405 | PIN, COTTER: S, PASS-FIN, 1/16 NOM DIA, 3/8 LG MS 24665-151 (96906) | | HD | 1 | * | * | * | * | * | * | * | * | 10 | 18 |
| P F | 5315-474-4115 | PIN, STRAIGHT, HEADED. S, PHOS-CTD, 0.217 DIA, 1.041 EFFECTIVE LG, 1.180 NOM LG, 0.078 COTTER PIN HOLE DIA | | EA | 1 | * | * | * | * | * | * | * | * | 10 | 19 |
| R P F | 5315-072-5383 | PIN, YOKE ASSEMBLY: 7791104 (19204) | | EA | 1 | * | * | * | * | * | * | * | * | 10 | 20 |
| P F | 1005-072-5384 | SWIVEL, GUN SLING: YOKE ASSY, BIPOD 7791669 (19204) | | EA | 1 | * | * | * | * | * | * | * | * | 10 | 21 |
| P F | 1005-474-4116 | JAW, LEFT HAND: YOKE ASSY 7791102 (19204) | | EA | 1 | * | * | * | * | * | * | * | * | 10 | 22 |
| P F | 1005-474-4118 | JAW ASSEMBLY, RIGHT HAND- YOKE ASSY 7791107 (19204) | | EA | 1 | * | * | * | * | * | * | * | * | 10 | 23 |
| P F | 5306-474-4114 | BOLT, SELF-LOCKING: HEX-HD, S, PHOS-CTD, NYLON INSERT IN THD, 5/16-24UNF-3A, 0.750 LG 791103 (19204) | | EA | 1 | * | * | * | * | * | * | * | * | 10 | 24 |
| X1 F | | JAW, RIGHT HAND: 7791101 (19204) | | EA | 1 | .. | .. | .. | .. | .. | .. | .. | .. | 10 | 25 |
| X1 F | | HEAD ASSEMBLY, WELDMENT, BIPOD: 7792847 (19204) | | EA | 1 | .. | .. | .. | .. | .. | .. | .. | .. | 10 | 26 |
| | | COMBINATION TOOL | | | | | | | | | | | | | |
| P O | 5315-597-5086 | PIN SPRING: S, PHOS-CTD, 1/16 DIA, 3/8 LG MS 16562-98 (96906) | | HD | 1 | REF | REF | REF | REF | REF | REF | REF | REF | 11 | 1 |
| P O | 4933-780-1982 | BLADE, SCREWDRIVER: S, PHOS-CTD, 0.220 W, 0.527 LG, 30 DEG BLADE ANGLE 7790786 (19204) | | EA | 1 | * | * | * | * | * | * | * | * | 11 | 2 |
| | | KIT, WINTER TRIGGER | | | | | | | | | | | | | |
| P O | 1005-775-0364 | TRIGGER ASSEMBLY, WINTER: M5 7790808 (19204) | | EA | 1 | * | * | * | * | * | * | * | * | 12 | 1 |
| P O | 5305-990-6435 | SCREW, TAPPING, THREAD FORMING 7791415 (19204) | | EA | 2 | * | * | * | * | * | * | * | * | 12 | 2 |
| P O | 1005-010-5022 | WASHER, HINGE, RETAINING: TRIGGER ASSEMBLY 7791237 (19204) | | EA | 2 | * | * | * | * | * | * | * | * | 12 | 3 |
| X1 F | | LEVER: 7791211 (19204) | | EA | 1 | .. | .. | .. | .. | .. | .. | .. | .. | 12 | 4 |

Section II. REPAIR PARTS LIST (Continued)

| (1) SMR CODE | (2) FEDERAL STOCK NUMBER | (3) DESCRIPTION REFERENCE NUMBER & MFR. CODE USABLE ON CODE | | (4) UNIT OF MEAS | (5) QTY INC IN UNIT | (6) 30 DAY DS MAINT ALLOWANCE | | | (7) 30DAY GS MAINT ALLOWANCE | | | (8) 1-YR ALW PER 100 EQUIP CNTGCV | (9) DEPOT MAINT ALW PER 100 EQUIP | (10) ILLUSTRATION | |
|--------------------|-----------------------------------|---|---|---------------------------|---------------------------------|-------------------------------------|-------|--------|------------------------------------|-------|--------|--|--|----------------------|-------------|
| | | | | | | (a) | (b) | (c) | (a) | (b) | (c) | | | (a) | (b) |
| | | | | | | 1-20 | 21-50 | 51-100 | 1-20 | 21-50 | 51-100 | | | FIGURE NO. | ITEM NO/ |
| P O | 1005-778-0580 | SAFETY, WINTER: 7790903 (19204) | A | EA | 1 | * | * | * | * | * | * | * | * | 12 | 5 |
| R P F | 5315-523-3523 | THE FOLLOWING ITEMS ARE USED FOR REPAIR OF WOODEN STOCK FSN 1005-754-6462 SCREW: STOCK REPAIR, LARGE, 3/32 DIA 5233523 (19204) | | EA | 1 | * | * | * | * | * | * | * | * | | |
| R P F | 5315-719-0954 | SCREW, STOCK REPAIR, SMALL: BR, 1/16 DIA, 2 O/A LG 7190954 (19204) ALTERNATE REPAIR PARTS FOR: 7.62-MM RIFLE, M14 THE FOLLOWING ITEMS ARE AUTHORIZED AND INSTALLED ONLY IN ACCORDANCE WITH DIRECTIVE BY TACTICAL UNIT COMMANDER | | EA | 1 | * | * | * | * | * | * | * | * | | |
| P O | 1005-587-8408 | SELECTOR: AUTOMATIC AND SEMI-AUTOMATIC FIRING 7267071 (19204) | A | EA | 1 | * | * | * | * | * | * | * | * | | |
| P O | 1005-587-8415 | SPRING, SELECTOR: 7267081 (19204) | A | EA | 1 | * | * | * | * | * | * | * | * | | |

Section III. SPECIAL TOOL LIST

| (1) SMR CODE | (2) FEDERAL STOCK NUMBER | (3) DESCRIPTION REFERENCE NUMBER & MFR. CODE USABLE ON CODE | | (4) UNIT OF MEAS | (5) QTY INC IN UNIT | (6) 30 DAY DS MAINT ALLOWANCE | | | (7) 30DAY GS MAINT ALLOWANCE | | | (8) 1-YR ALW PER 100 EQUIP CNTGCV | (9) DEPOT MAINT ALW PER 100 EQUIP | (10) ILLUSTRATION | |
|--|-----------------------------------|--|--|---------------------------|---------------------------------|-------------------------------------|-------|--------|------------------------------------|-------|--------|--|--|----------------------|-------------|
| | | | | | | (a) | (b) | (c) | (a) | (b) | (c) | | | (a) | (b) |
| | | | | | | 1-20 | 21-50 | 51-100 | 1-20 | 21-50 | 51-100 | | | FIGURE NO. | ITEM NO/ |
| <p>TOOLS AND EQUIPMENT AUTHORIZED FOR UNIT REPLACEMENT</p> | | | | | | | | | | | | | | | |
| P O | 1005-288-3565 | SWAB, SMALL ARMS CLEANING: COTTON, 2-1/2 SQ (1000 IN PKG) 5019316 (19204) | | PG | .. | 2 | 4 | 7 | 2 | 4 | 7 | 84 | | | |
| P C | 1005-556-4174 | BRUSH, CLEANING, SMALL ARMS: BORE 5564174 (19204) | | EA | .. | 2 | 4 | 7 | 2 | 4 | 7 | 84 | .. | 13 | 1 |
| P C | 1005-650-4510 | CASE, SMALL ARMS CLEANING ROD: 7267754 (19204) | | EA | .. | 1 | 1 | 2 | 1 | 1 | 2 | 24 | .. | 13 | 7 |
| P C | 1005-654-4058 | SLING, SMALL ARMS: M1 WEBBING 6544058 (19204) | | EA | .. | 1 | 2 | 4 | 1 | 2 | 4 | 48 | .. | 13 | 3 |
| P C | 1005-690-8441 | BRUSH, CLEANING, SMALL ARMS: CHAMBER 7790463 (19204) | | EA | .. | 1 | 2 | 4 | 1 | 2 | 4 | 48 | .. | 13 | 4 |
| P O | 1005-722-8907 | ENVELOPE: FABRIC, 2 BUTTON, 4-7/8 X 3 7228907 (19204) | | EA | .. | * | * | 1 | * | * | 1 | 12 | | | |
| P C | 1005-726-6109 | ROD SECTION, CLEANING, SMALL ARMS: 7266109 (19204) | | EA | .. | 1 | 1 | 2 | 1 | 1 | 2 | 24 | .. | 13 | 5 |
| P C | 1005-726-6110 | SWAB HOLDER SECTION, SMALL ARMS CLEANING ROD: 7266110 (19204) | | EA | .. | 1 | 2 | 4 | 1 | 2 | 4 | 48 | .. | 13 | 6 |
| P C | 1005-791-3377 | CASE, LUBRICANT: 7790995 (19204) | | EA | .. | 1 | 1 | 2 | 1 | 1 | 2 | 24 | .. | 13 | 2 |
| P O | 4933-628-9700 | REFLECTOR, GUN BARREL: 7790138 (19204) | | EA | .. | * | 1 | 1 | * | 1 | 1 | 12 | | | |
| P O | 4933-652-9950 | EXTRACTOR, RUPTURED CARTRIDGE CASE: 7790352 (19204) | | EA | .. | 1 | 1 | 2 | 1 | 1 | 2 | 24 | | | |
| P O | 4933-690-3497 | PLIERS, LOCK NUT, FLASH SUPPRESSOR: 7790493 (19204) | | EA | .. | * | 1 | 1 | * | 1 | 1 | 12 | .. | 13 | 8 |
| P C | 4933-768-2011 | COMBINATION TOOL: 7790769 (19204) | | EA | .. | 1 | 2 | 3 | 1 | 2 | 3 | 36 | .. | 12 | - |
| P O | 4933-856-2561 | ALIGNMENT TOOL: FLASH SUPPRESSOR 7799705 (19204) | | EA | .. | * | 1 | 1 | * | 1 | 1 | 12 | .. | 14 | - |
| <p>SPECIAL TOOLS AND EQUIPMENT THE 15-DAY LEVEL IS NOT APPLICABLE THE FOLLOWING BASIC SMALL ARMS DIRECT AND GENERAL SUPPORT MAINTENANCE TOOL SET IS AUTHORIZED AS REQUIRED, TO ALL MAINTENANCE SUPPORT UNITS WITH A SMALL ARMS REPAIR MISSION</p> | | | | | | | | | | | | | | | |

Section III. SPECIAL TOOL LIST

| (1) SMR CODE | (2) FEDERAL STOCK NUMBER | (3) DESCRIPTION REFERENCE NUMBER & MFR. CODE USABLE ON CODE | | (4) UNIT OF MEAS | (5) QTY INC IN UNIT | (6) 30 DAY DS MAINT ALLOWANCE | | | (7) 30DAY GS MAINT ALLOWANCE | | | (8) 1-YR ALW PER 100 EQUIP CNTGCV | (9) DEPOT MAINT ALW PER 100 EQUIP | (10) ILLUSTRATION | |
|--------------------|-----------------------------------|---|--|---------------------------|---------------------------------|-------------------------------------|-------|--------|------------------------------------|-------|--------|--|--|----------------------|-------------|
| | | | | | | (a) | (b) | (c) | (a) | (b) | (c) | | | (a) | (b) |
| | | | | | | 1-20 | 21-50 | 51-100 | 1-20 | 21-50 | 51-100 | | | FIGURE NO. | ITEM NO/ |
| P F | 4933-775-0366 | TOOL SET, DIRECT AND GENERAL SUPPORT MAINTENANCE, BASIC SMALL ARMS. 8426358 (19204) NOTE: SEE SC 4933-95-CL-E04 FOR COMPONENTS THE FOLLOWING TOOL SETS ARE REQUISITIONED AND ISSUED TO MAINTENANCE UNITS PERFORMING DIRECT AND GENERAL SUPPORT, OR DEPOT MAINTENANCE. THE COMPLETE SETS WILL BE REQUISITIONED AND INDIVIDUAL TOOLS LISTED BELOW MAY ALSO BE REQUISITIONED UNDER THEIR OWN STOCK NUMBER FOR REPLACEMENT | | SE | | * | * | * | * | * | * | | | | |
| P F R | 4933-647-3703 | TOOL SET DIRECT AND GENERAL SUPPORT MAINTENANCE: 7.62-MM RIFLE, M14 SERIES 8421895 (19205) COMPOSED OF: | | SE | .. | * | * | * | * | * | * | | | | |
| P F | 4933-345-6122 | 1-GAGE, FIRING PIN PROTRUSION: CAL. .30, MIN 0.044, MAX 0.060 7274736 (19204) | | EA | .. | * | * | * | * | * | * | 1 | .. | 15 | 1 |
| P F | 4933-563-0436 | 1-PLIERS, RETAINING RING, BOLT ROLLER: 7799723 (19204) | | EA | .. | * | * | * | * | * | * | 1 | .. | 15 | 2 |
| P F | 4933-647-3693 | 1-GAGE, PLUG, NOT-GO: PLAIN CYLINDRICAL, 0.05009 DIA OF PISTON HOLE IN GAS CYLINDER 7274755 (19204) | | EA | .. | | | | | | | 1 | .. | 15 | 3 |
| P F | 4933-647-3695 | 1-GAGE, SNAP, NOT-GO: 0.4968 PISTON DIA 7274757 (19204) | | EA | .. | * | * | * | * | * | * | * | .. | 15 | 4 |
| P F | 4933-647-3697 | 1-GAGE, BREECHBORE, FIELD REJECTION: LIMIT 0.310 7274761 (19204) | | EA | .. | * | * | * | * | * | * | * | .. | 15 | 5 |
| P F | 4933-647-3698 | 1-GAGE, HEADSPACE: FIELD REJECTION LIMIT 1.6455 7274790 (19204) | | EA | .. | * | * | * | * | * | * | * | | 15 | 6 |
| P F | 4933-647-3699 | 1-BOLT, FIELD TEST: GAGE, 0.615 RIGHT LUG, 0.515 LEFT LUG 7274799 (19204) | | EA | .. | * | * | * | * | * | * | * | | 15 | 7 |
| P F | 4933-678-9830 | 1-CASE, GAGES, FIELD MAINTENANCE 7799702 (19204) | | EA | .. | * | * | * | * | * | * | * | | | |
| P F | 4933-856-2561 | 1-ALIGNMENT TOOL: 7799705 (19204) | | EA | .. | * | * | * | * | * | * | * | | | |

Section III. SPECIAL TOOL LIST

| (1) SMR CODE | (2) FEDERAL STOCK NUMBER | (3) DESCRIPTION REFERENCE NUMBER & MFR. CODE USABLE ON CODE | | (4) UNIT OF MEAS | (5) QTY INC IN UNIT | (6) 30 DAY DS MAINT ALLOWANCE | | | (7) 30DAY GS MAINT ALLOWANCE | | | (8) 1-YR ALW PER 100 EQUIP CNTGCY | (9) DEPOT MAINT ALW PER 100 EQUIP | (10) ILLUSTRATION | |
|--------------------|-----------------------------------|---|--|---------------------------|---------------------------------|-------------------------------------|-------|--------|------------------------------------|-------|--------|--|--|----------------------|-------------|
| | | | | | | (a) | (b) | (c) | (a) | (b) | (c) | | | (a) | (b) |
| | | | | | | 1-20 | 21-50 | 51-100 | 1-20 | 21-50 | 51-100 | | | FIGURE NO. | ITEM NO/ |
| P F | 4933-917-1067 | 1-GAGE, PLUG, FIRING PIN HOLE DIAMETER: 7458406 (19204) | | EA | .. | * | * | * | * | * | * | .. | 15 | 8 | |
| P F | 5120-889-2162 | 1-KEY, SOCKET, HEAD SCREW: HEX-TYPE, L- TYPE HANDLE 7/64 W ACROSS FLATS GGG-W-00652 (81348) | | EA | .. | * | * | * | * | * | * | | | | |
| P D R | 4933-930-5598 | TOOL SET, DEPOT MAINTENANCE: FOR 7.62- MM RIFLE, M14 SERIES 8432422 (19204) COMPOSED OF: | | SE | .. | .. | .. | .. | .. | .. | * | * | | | |
| P D | 4933-069-8676 | 1-GAGE, HEADSPACE: 1.6415 7274786 (19204) | | EA | .. | .. | .. | .. | .. | .. | * | * | | | |
| P C | 4933-105-2835 | 1-HANDLE CRANK: HEADSPACE REAMER ASSY 10-013069 (19204) | | EA | .. | .. | .. | .. | .. | .. | * | * | | | |
| P D | 4933-439-6088 | 1-FIXTURE, ASSEMBLING AND DISASSEM- BLING, BOLT AND ROLLER ASSEMBLY 10-016057 (19204) | | EA | .. | .. | .. | .. | .. | .. | * | * | | | |
| P D | 4933-439-6089 | 1-FIXTURE, DISASSEMBLING: BARREL AND RECEIVER ASSY 10-013027 (19204) | | EA | .. | .. | .. | .. | .. | .. | * | * | | | |
| P D | 4933-439-6090 | 1-FIXTURE, ASSEMBLING: FIRING MECHANISM 443448 (19204) | | EA | .. | .. | .. | .. | .. | .. | * | * | | | |
| P D | 4933-450-6725 | 1-ADAPTER, GREASE FITTING: BOLT AND ROLLER ASSY 10-013635 (19204) | | EA | .. | .. | .. | .. | .. | .. | * | * | | | |
| P D | 4933-809-7980 | 3-REAMER ASSEMBLY, HEADSPACE: 24-013863 (19204) | | EA | .. | .. | .. | .. | .. | .. | * | * | | | |
| P D | 4933-916-9188 | 1-GAGE, PLUG, ALIGNMENT: GAS PORT HOLES 11015316 (19204) | | EA | .. | .. | .. | .. | .. | .. | * | * | | | |
| P D | 4933-916-9189 | 1-GAGE PLUG, DROP: STRAIGHTNESS OF BORE 11015416 (19204) | | EA | .. | .. | .. | .. | .. | .. | * | * | | | |
| P D | 4933-916-9193 | 1-GAGE, TARGETING JACK- 6511841 (19204) | | EA | .. | .. | .. | .. | .. | .. | * | * | | | |
| P D | 4933-916-9194 | 1-GAGE, PLUG: GO, RELATIONSHIP OF STORAGE HOLES TO BUTT PLATE 7271641 (19204) | | EA | .. | .. | .. | .. | .. | .. | * | * | | | |
| P D | 4933-916-9196 | 1-GAGE, TORQUE TESTING: 7271792 (19204) | | EA | .. | .. | .. | .. | .. | .. | * | * | | | |

Section III. SPECIAL TOOL LIST

| (1) SMR CODE | (2) FEDERAL STOCK NUMBER | (3) DESCRIPTION REFERENCE NUMBER & MFR. CODE USABLE ON CODE | | (4) UNIT OF MEAS | (5) QTY INC IN UNIT | (6) 30 DAY DS MAINT ALLOWANCE | | | (7) 30DAY GS MAINT ALLOWANCE | | | (8) 1-YR ALW PER 100 EQUIP CNTGCV | (9) DEPOT MAINT ALW PER 100 EQUIP | (10) ILLUSTRATION | |
|--------------------|-----------------------------------|--|--|---------------------------|---------------------------------|-------------------------------------|-------|--------|------------------------------------|-------|--------|--|--|----------------------|-------------|
| | | | | | | (a) | (b) | (c) | (a) | (b) | (c) | | | (a) | (b) |
| | | | | | | 1-20 | 21-50 | 51-100 | 1-20 | 21-50 | 51-100 | | | FIGURE NO. | ITEM NO/ |
| P D | 4933-916-9271 | 1-GAGE, HEADSPACE: 1.6355 7274780 (19204) | | EA | .. | .. | .. | .. | .. | .. | .. | * | * | | |
| P D | 4933-916-9275 | 1-GAGE, HEADSPACE: 1.6375 7274782 (19204) | | EA | .. | .. | .. | .. | .. | .. | .. | * | * | | |
| P D | 4933-916-9341 | 1-GAGE, FLUSH PIN-RECEIVER AND TRIGGER HOUSING CLAMPING SURFACES 7799742 (19204) | | EA | .. | .. | .. | .. | .. | .. | .. | * | * | | |
| P D | 4933-916-9360 | 1-GAGE, LENGTH: OPERATING ROD SPRING 7799743 (19204) | | EA | .. | .. | .. | .. | .. | .. | .. | * | * | | |
| P D | 4933-916-9362 | 1-GAGE, LENGTH: EXTRACTOR ASSEMBLY 7799744 (19204) | | EA | .. | .. | .. | .. | .. | .. | .. | * | * | | |
| P D | 4933-916-9365 | 1-GAGE LENGTH: EJECTOR ASSEMBLY 7799745 (19204) | | EA | .. | .. | .. | .. | .. | .. | .. | * | * | | |
| P D | 4933-916-9444 | 1-GAGE, LENGTH: HAMMER SPRING 7799747 (19204) | | EA | .. | .. | .. | .. | .. | .. | .. | * | * | | |
| P D | 4933-916-9437 | 1-GAGE, LENGTH: APERTURE 7799746 (19204) | | EA | .. | .. | .. | .. | .. | .. | .. | * | * | | |
| P D | 4933-916-9464 | 1-GAGE, STRAIGHTNESS: CONNECTOR ASSEMBLY 7799748 (19204) | | EA | .. | .. | .. | .. | .. | .. | .. | * | * | | |
| P D | 4933-916-9468 | 1-GAGE, ALIGNMENT, BARREL: 7799749 (19204) | | EA | .. | .. | .. | .. | .. | .. | .. | * | * | | |
| P D | 4933-916-9487 | 1-GAGE, LOCATION: SELECTOR SLOT 7799750 (19204) | | EA | .. | .. | .. | .. | .. | .. | .. | * | * | | |
| P D | 4933-916-9527 | 1-GAGE, FLUSH PIN: FIRING PIN INTRUSION 7799751 (19204) | | EA | .. | .. | .. | .. | .. | .. | .. | * | * | | |
| P D | 4933-917-1068 | 1-GAGE, SNAP: ADJUSTMENT 7479462 (19204) | | EA | .. | .. | .. | .. | .. | .. | .. | * | * | | |
| P D | 4933-937-4068 | 1-FIXTURE, ASSEMBLING, BARREL AND RECEIVER: 7799718 (19204) | | EA | .. | .. | .. | .. | .. | .. | .. | * | * | | |
| P D | 4933-937-4069 | 1-CUTTER, FACING: 7799721 (19204) | | EA | .. | .. | .. | .. | .. | .. | .. | * | * | | |
| P D | 5120-156-8735 | 1-WRENCH, OPENED END, FIXED- 10-012952 (19207) | | EA | .. | .. | .. | .. | .. | .. | .. | * | * | | |
| P D | 5220-745-8398 | 1-GAGE, PLUG, PLAIN CYLINDRICAL: NO-GO 0.083 DIA OF FIRING PIN HOLE IN BOLT FACE 7458398 (19204) | | EA | .. | .. | .. | .. | .. | .. | .. | * | * | | |

Section III. SPECIAL TOOL LIST

| (1) SMR CODE | (2) FEDERAL STOCK NUMBER | (3) DESCRIPTION REFERENCE NUMBER & MER. CODE USABLE ON CODE | | (4) UNIT OF MEAS | (5) QTY INC IN UNIT | (6) 30 DAY DS MAINT ALLOWANCE | | | (7) 30DAY GS MAINT ALLOWANCE | | | (8) 1-YR ALW PER 100 EQUIP CNTGCTY | (9) DEPOT MAINT ALW PER 100 EQUIP | (10) ILLUSTRATION | |
|--------------------|-----------------------------------|---|--|---------------------------|---------------------------------|-------------------------------------|-------|--------|------------------------------------|-------|--------|---|--|----------------------|-------------|
| | | | | | | (a) | (b) | (c) | (a) | (b) | (c) | | | (a) | (b) |
| | | | | | | 1-20 | 21-50 | 51-100 | 1-20 | 21-50 | 51-100 | | | FIGURE NO. | ITEM NO/ |
| N P D | 5220-437-1152 | 1-GAGE, PLUG, NOT-GO: FLAT CYLINDRICAL 0.5009 DIA OF PISTON HOLE IN GAS CYLINDER 8440826 (19204) | | EA | .. | .. | .. | .. | .. | .. | .. | * | * | | |
| P F | 8010-145-0042 | MAINTENANCE SUPPLIES ENAMEL: TOUCH-UP, GUN STOCK, WALNUT, NO. 21089 (1 GAL CAN) 30045 OR FED STD 595 | | CN | .. | * | * | * | * | * | * | | | | |
| | | SPECIAL EQUIPMENT THE FOLLOWING INDIVIDUAL ITEMS ARE AUTHORIZED FOR DEPOT REBUILD PROGRAMS ONLY. | | | | | | | | | | | | | |
| P D | 4933-838-5272 | COVER, PROOF FIRING: 7273975 (192041) | | EA | .. | .. | .. | .. | .. | .. | .. | .. | * | | |
| P D | 4933-916-9207 | STAND, FIRING: 7273901 (19204) | | EA | .. | .. | .. | .. | .. | .. | .. | .. | * | | |
| C P D | 6920-240-9349 | TARGET ROLL: 1000 INCH RANGE (500 PER ROLL) 8448435 (19204) | | BX | .. | .. | .. | .. | .. | .. | .. | .. | * | | |
| | | SPECIAL PACKAGING MATERIAL | | | | | | | | | | | | | |
| P D | 1005-336-0211 | BAG, BARRIER, VCI TREATED: 7265933 (19204) | | EA | .. | .. | .. | .. | .. | .. | .. | .. | * | | |
| P D | 1005-441-8807 | PROTECTOR, APERTURE ASSEMBLY: 7791358 (19204) | | EA | .. | .. | .. | .. | .. | .. | .. | .. | * | | |
| R P D | 5340-018-3254 | CAP, REAR SIGHT ELEVATING KNOB: 7791345 (19204) | | EA | .. | .. | .. | .. | .. | .. | .. | .. | * | | |
| P D | 1005-875-9765 | PROTECTOR, HANDLE: 7790231 (19204) | | EA | .. | .. | .. | .. | .. | .. | .. | .. | * | | |
| P D | 1005-875-9766 | PROTECTOR, MUZZLE: PLASTIC 7790232 (19204) | | EA | .. | .. | .. | .. | .. | .. | .. | .. | * | | |
| P D | 1005-336-0212 | TUBE, BORE VCI TREATED: 7266316 (19204) | | EA | .. | .. | .. | .. | .. | .. | .. | .. | * | | |

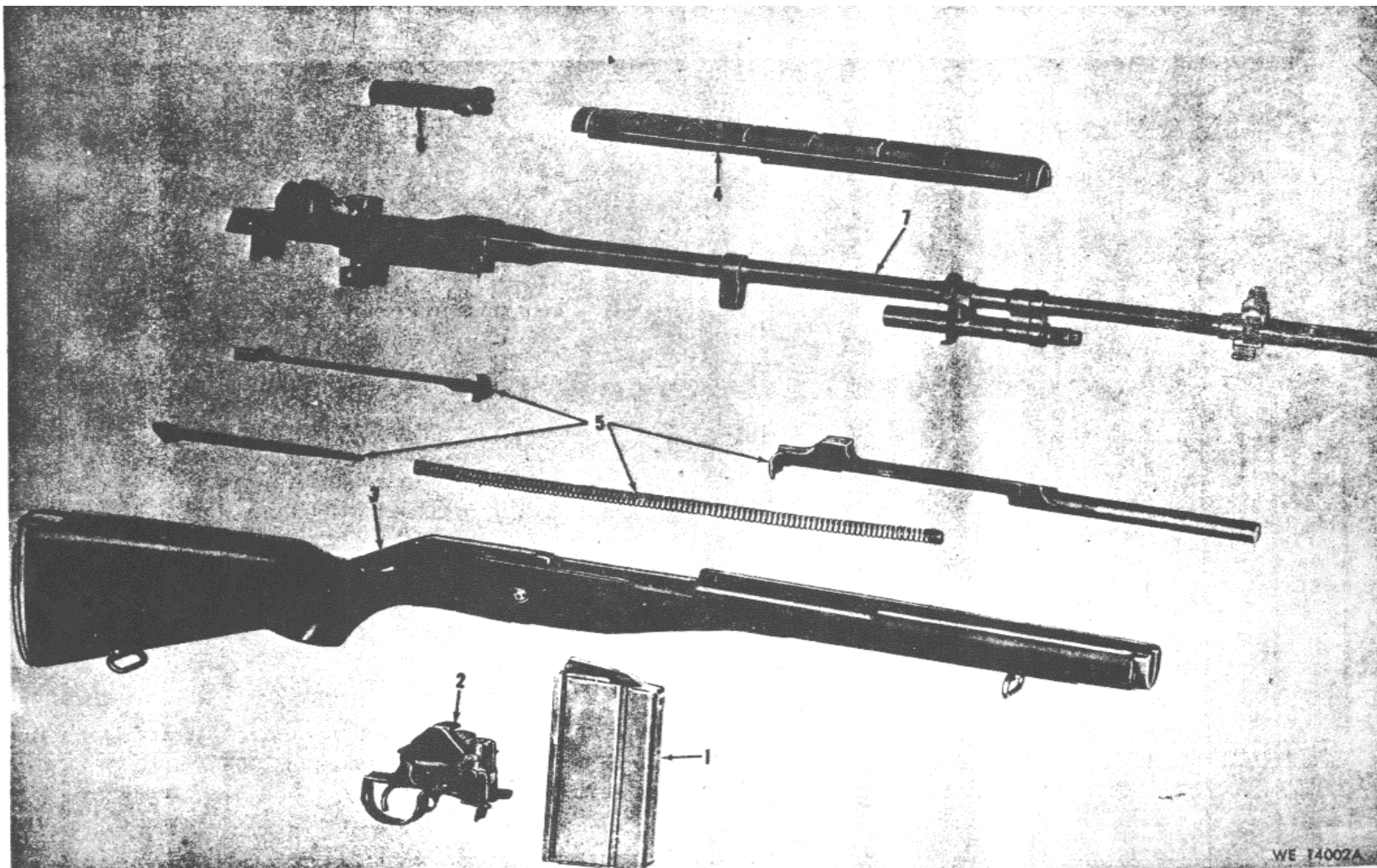

Figure 1. Major groups and assemblies - M14.

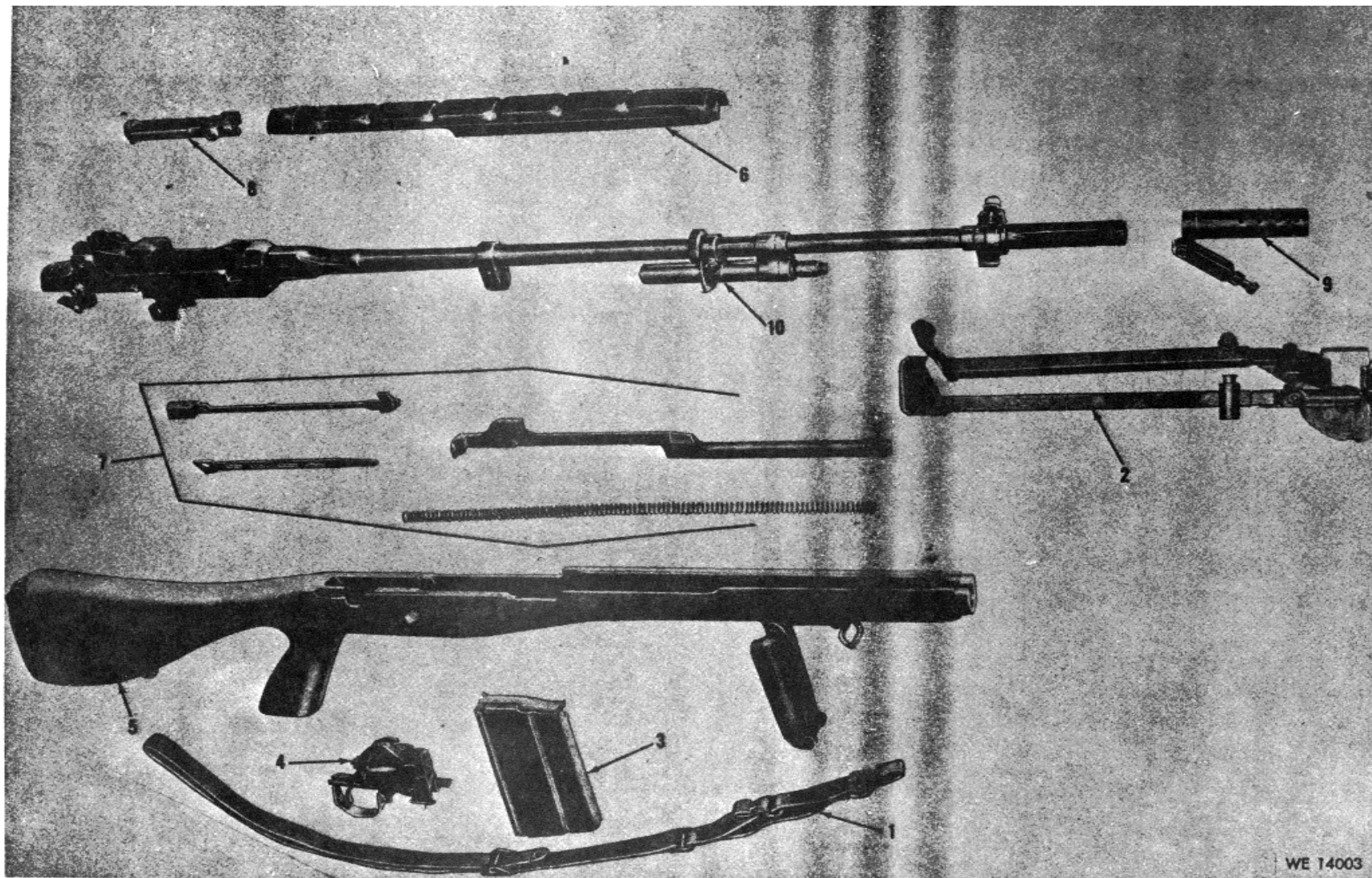

Figure 2. Major groups and assemblies-Rifle, M14A1.

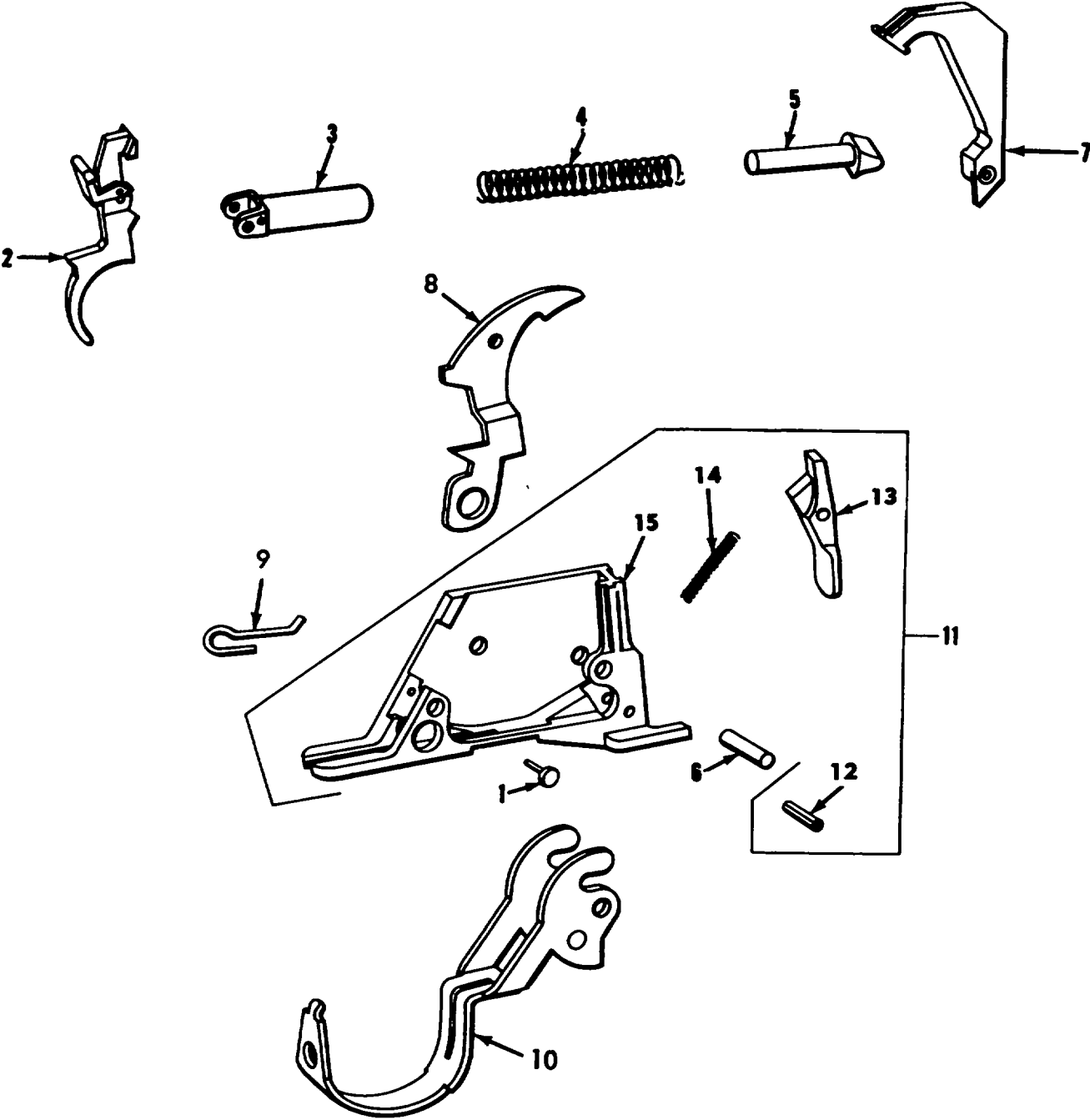
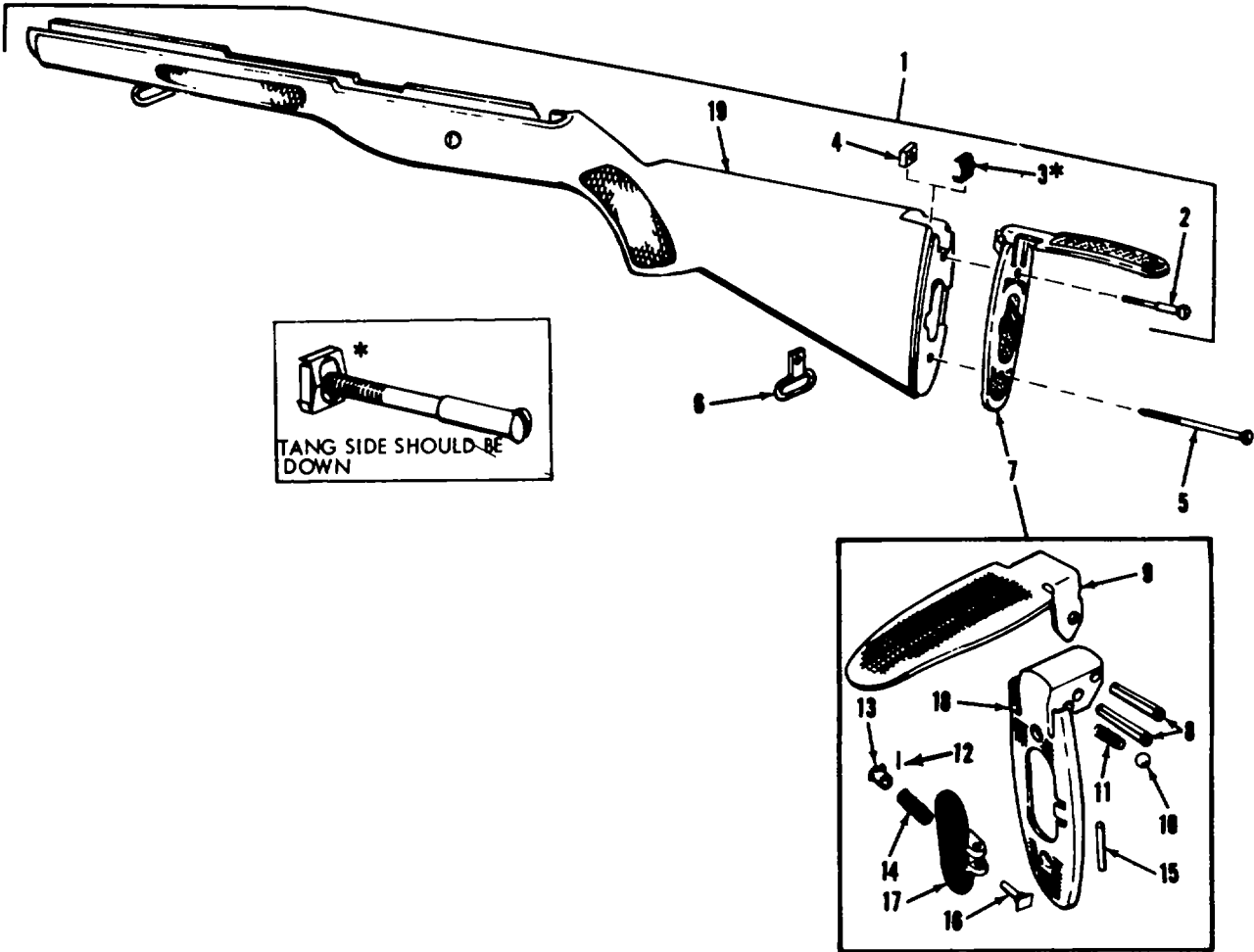

Figure 3. Firing mechanism-exploded view.

WE15520



WE66303

Figure 4. Stock assembly with butt plate, Rifle, M14-exploded view.

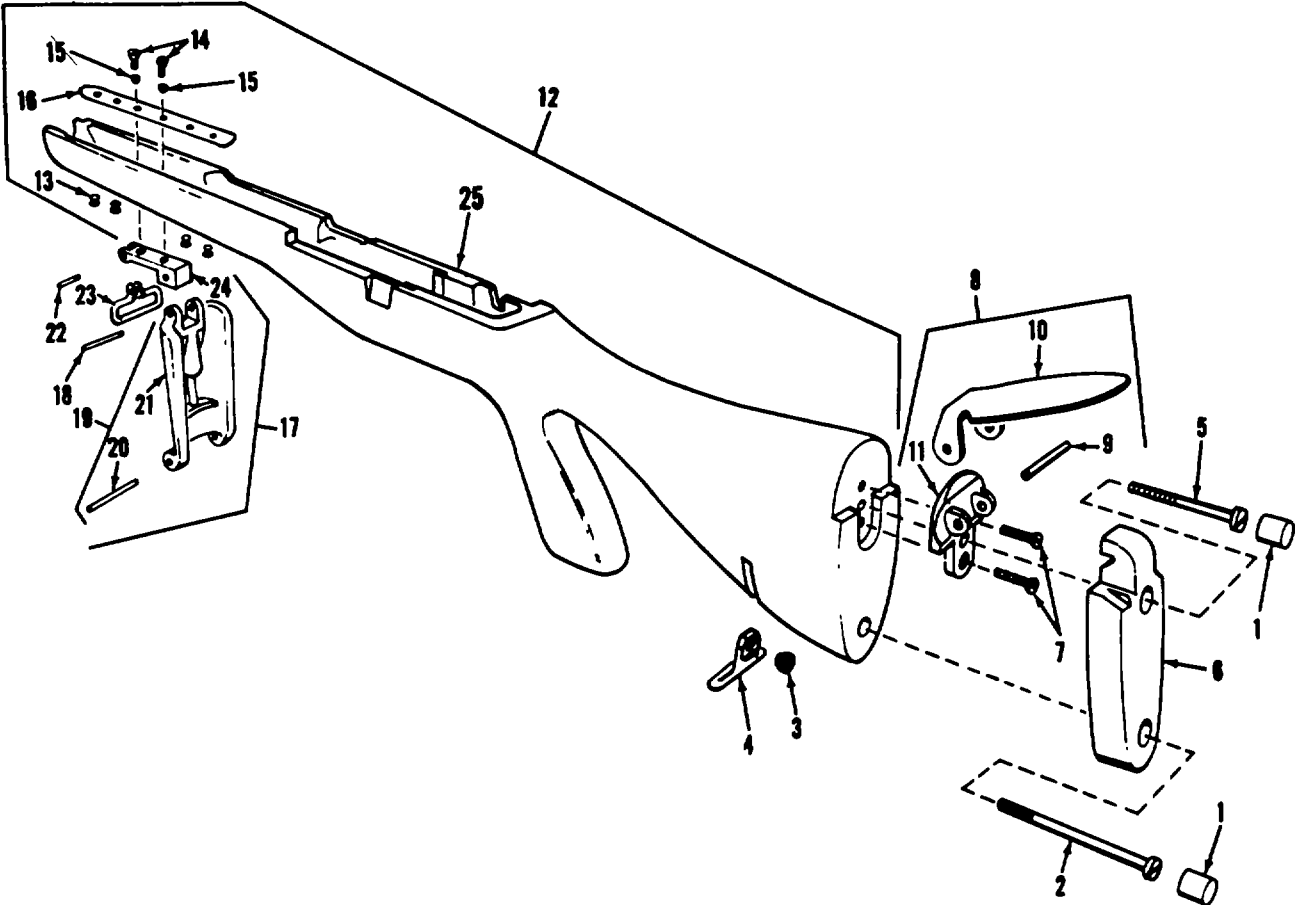

WE15522

Figure 5. Shoulder gun stock assembly. Rifle, M14A1--exploded view.

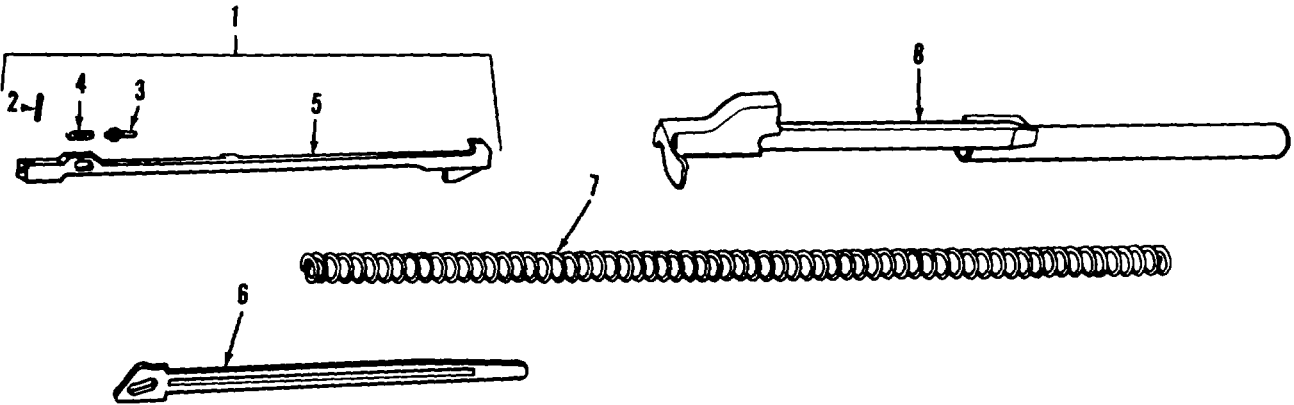

WE15523

Figure 6. Operating rod and connector group--exploded view.

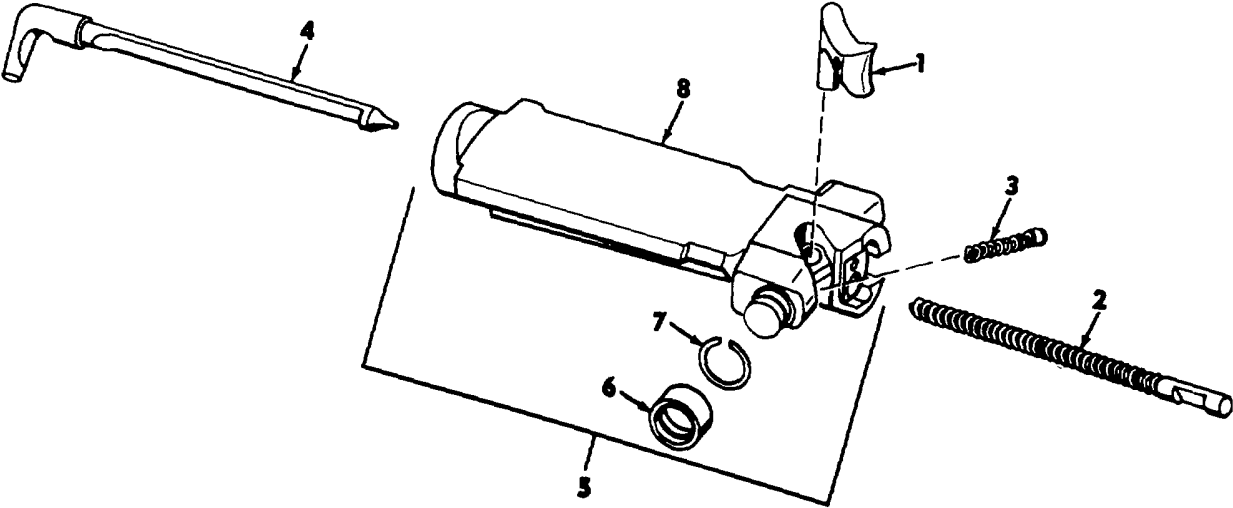

WE15524

Figure 7. Bolt assembly--exploded view.

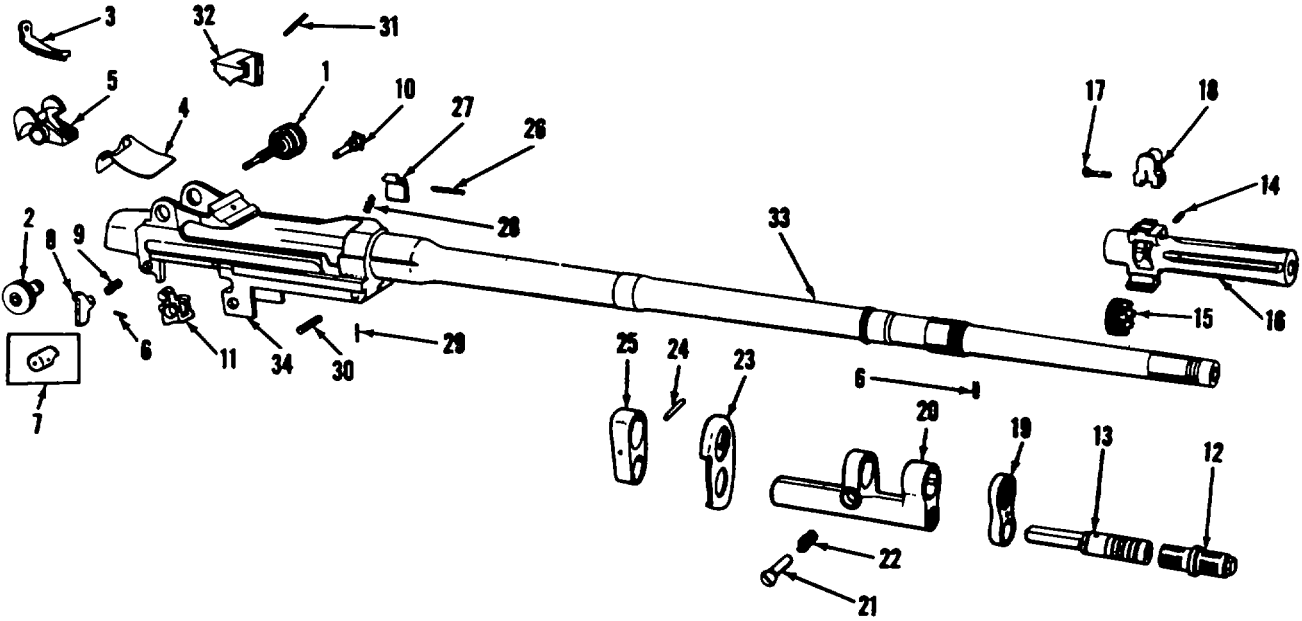

WE16991

Figure 8. Barrel and receiver group-exploded view.

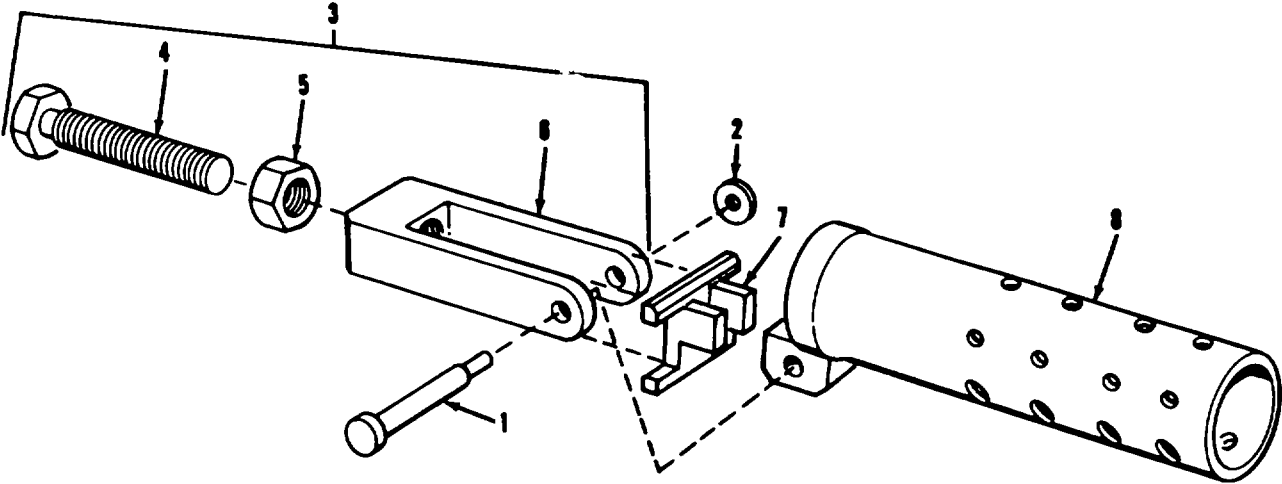

WE18892

Figure 9. Stabilizer assembly- exploded view.

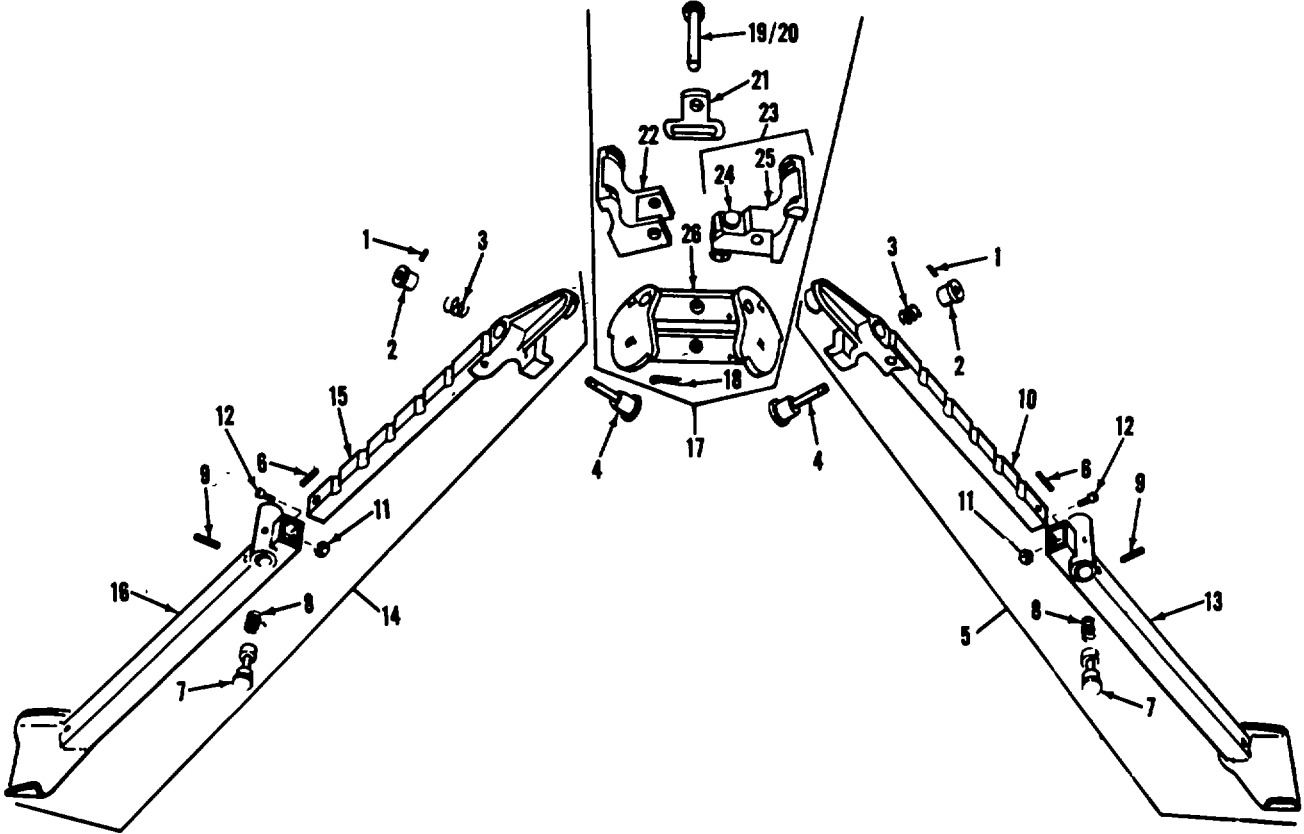

WE15525

Figure 10. Rifle Bipod. M2- exploded view.

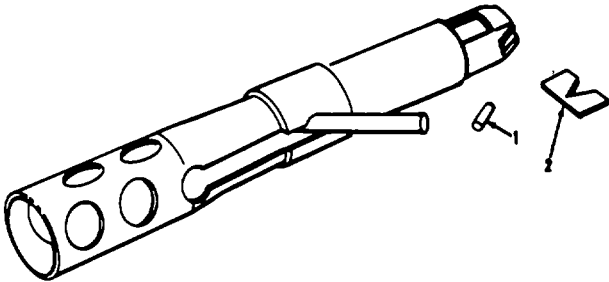

WE69480

Figure 11. Combination tool-exploded view.

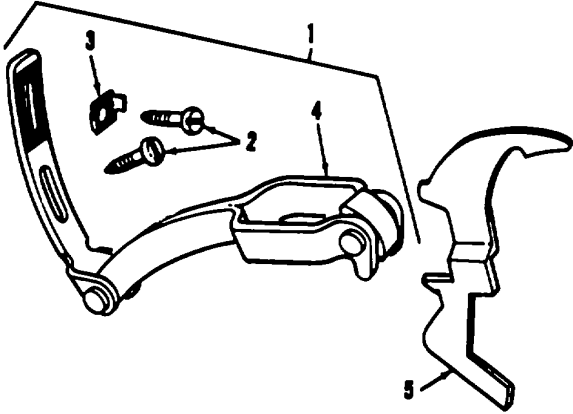

WE14032

Figure 12. Winter trigger kit-exploded view.

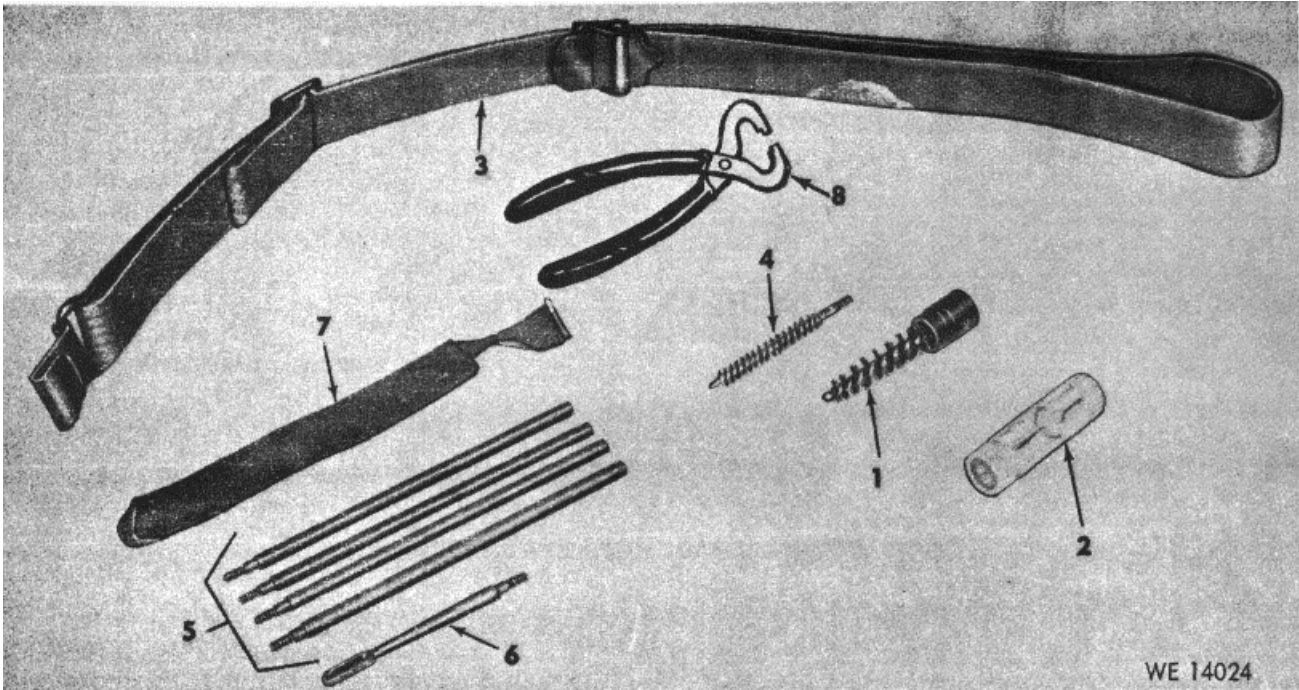

Figure 13. Tools and equipment.

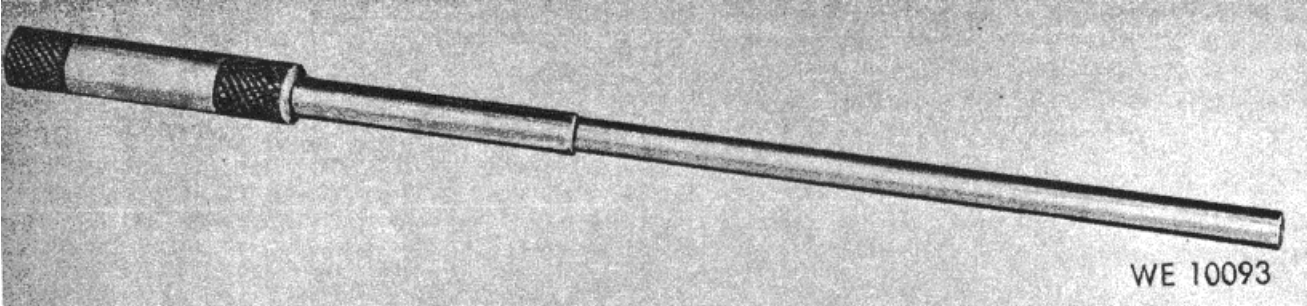

Figure 14 . Flash suppressor alignment tool

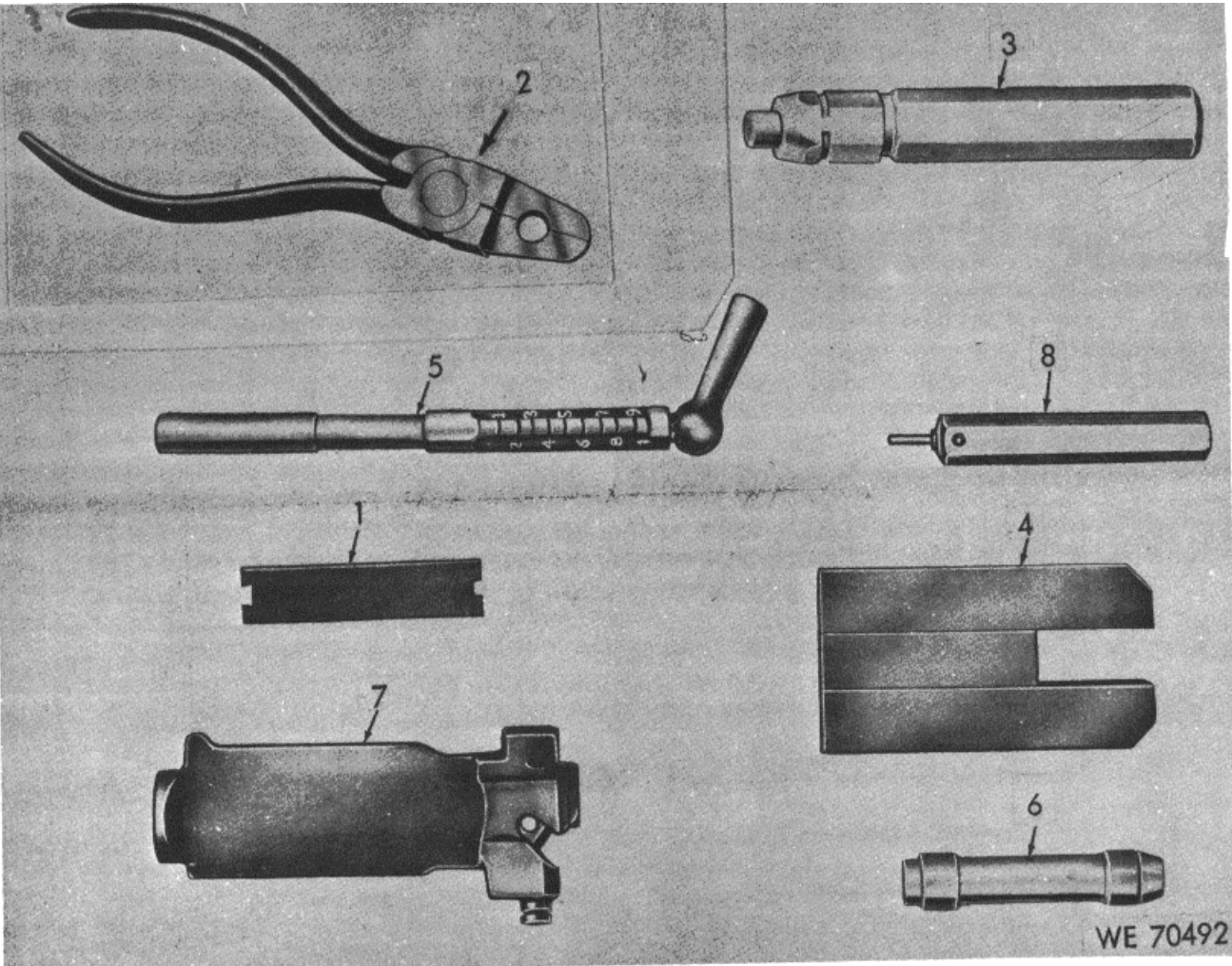

Figure 15. Maintenance Tools.

Section IV. FEDERAL STOCK NUMBER AND REFERENCE NUMBER INDEX

| STOCK NUMBER | FIGURE NO | ITEM NO | STOCK NUMBER | FIGURE NO | ITEM NO |
|---------------|-----------|---------|---------------|-----------|---------|
| 1005-010-5022 | 12 | 3 | 1005-678-9827 | 6 | 4 |
| 1005-016-2621 | 5 | 24 | 1005-690-4067 | 4 | 7 |
| 1005-016-2623 | 5 | 19 | 1005-690-8441 | 13 | 4 |
| 1005-072-5376 | 2 | 1 | 1005-726-6109 | 13 | 5 |
| 1005-072-5377 | 5 | 17 | 1005-726-6110 | 13 | 6 |
| 1005-072-5378 | 5 | 4 | 1005-740-0053 | 10 | 4 |
| 1005-072-5384 | 10 | 21 | 1005-731-2737 | 8 | 2 |
| 1005-072-5385 | 5 | 6 | 1005-772-6361 | 10 | 2 |
| 1005-072-5386 | 5 | 1 | 1005-772-6362 | 10 | 14 |
| 1005-072-5390 | 5 | 8 | 1005-772-6363 | 10 | 5 |
| 1005-084-8435 | 8 | 18 | 1005-772-6365 | 10 | 3 |
| 1005-464-4116 | 10 | 22 | 1005-775-0364 | 12 | 1 |
| 1005-474-4188 | 10 | 23 | 1005-778-0580 | 12 | 5 |
| 1005-501-3747 | 4 | 11 | 1005-790-8766 | 8 | 20 |
| 1005-545-1573 | 8 | 16 | 1005-791-3377 | 13 | 2 |
| 1005-554-6001 | 8 | 5 | 1005-856-2108 | 1 | 4 |
| 1005-554-6008 | 3 | 7 | | 2 | 6 |
| 1005-554-6015 | 3 | 8 | 1005-897-6156 | 10 | 8 |
| 1005-556-4174 | 13 | 1 | 1005-921-5248 | 7 | 4 |
| 1005-587-6988 | 3 | 10 | 1005-930-0806 | 2 | 9 |
| 1005-587-8375 | 8 | 23 | 1005-951-3056 | 9 | 7 |
| 1005-587-8381 | 7 | 2 | 1005-951-3232 | 9 | 3 |
| 1005-587-8385 | 8 | 25 | 1005-951-3254 | 5 | 16 |
| 1005-587-8386 | 6 | 6 | 1005-953-9504 | 7 | 1 |
| 1005-587-8389 | 3 | 13 | 1005-981-1252 | 4 | 13 |
| 1005-587-8390 | 8 | 27 | 1005-981-1255 | 4 | 9 |
| 1005-587-8398 | 8 | 13 | 1005-981-1256 | 4 | 14 |
| 1005-587-8400 | 8 | 12 | 1005-999-1871 | 4 | 1 |
| 1005-587-8402 | 7 | 7 | 1005-999-3399 | 8 | 1 |
| 1005-587-8404 | 6 | 8 | 1005-999-4200 | 5 | 12 |
| 1005-587-8408 | 8 | 8 | 3110-100-6151 | 4 | 10 |
| 1005-587-8409 | 8 | 10 | 3120-587-8405 | 7 | 6 |
| 1005-587-8411 | 8 | 28 | 4933-345-6122 | 15 | 1 |
| 1005-587-8413 | 5 | 7 | 4933-563-0436 | 15 | 2 |
| 1005-587-8414 | 3 | 9 | 4933-647-3693 | 15 | 3 |
| 1005-587-8415 | 8 | 9 | 4933-647-3695 | 15 | 4 |
| 1005-587-8419 | 3 | 2 | 4933-647-3697 | 15 | 5 |
| 1005-587-8420 | 8 | 7 | 4933-647-3698 | 15 | 6 |
| 1005-587-8421 | 8 | 21 | 4933-644-3699 | 15 | 7 |
| 1005-587-8422 | 8 | 22 | 4933-690-3497 | 13 | 8 |
| 1005-600-8618 | 7 | 3 | 4933-768-2011 | 12 | - |
| 1005-600-8868 | 8 | 3 | 4933-780-1082 | 11 | 2 |
| 1005-600-8872 | 8 | 4 | 4933-856-2561 | 14 | - |
| 1005-600-8880 | 3 | 5 | 4933-917-1067 | 15 | 8 |
| 1005-600-8803 | 3 | 3 | 5305-042-6426 | 8 | 14 |
| 1005-600-8887 | 3 | 4 | 5305-072-5388 | 5 | 2 |
| 1005-600-8889 | 4 | 6 | 5305-072-5389 | 5 | 5 |
| 1005-600-8890 | 5 | 23 | 5305-921-6155 | 8 | 17 |
| 1005-614-6873 | 5 | 7 | 5305-956-3401 | 5 | 14 |
| 1005-628-9048 | 1 | 1 | 5305-600-8881 | 4 | 5 |
| | 2 | 3 | 5305-978-9342 | 10 | 12 |
| 1005-628-9049 | 8 | 32 | 5305-990-6435 | 12 | 2 |
| 1005-628-9050 | 7 | 5 | 5305-999-1875 | 4 | 2 |
| 1005-628-9051 | 8 | 19 | 5306-474-4114 | 10 | 24 |
| 1005-628-9052 | 8 | 33 | 5306-956-3127 | 9 | 4 |
| 1005-628-9053 | 8 | 11 | 5310-194-9209 | 5 | 15 |
| 1005-628-9055 | 3 | 11 | 5310-587-8394 | 8 | 15 |
| 1005-650-4510 | 13 | 7 | 5310-934-9748 | 10 | 11 |
| 1005-654-4058 | 13 | 3 | 5310-953-6340 | 9 | 5 |
| 1005-678-9824 | 6 | 1 | 5310-962-0873 | 9 | 2 |
| 1005-678-9826 | 6 | 3 | 5310-999-1891 | 4 | 4 |

| STOCK NUMBER | FIGURE NO | ITEM NO |
|---------------|-----------|---------|
| 5315-016-2624 | 5 | 9 |
| 5315-050-1233 | 5 | 22 |
| 5315-051-6891 | 6 | 2 |
| | 8 | 6 |
| 5315-051-8636 | 8 | 31 |
| 5315-072-5383 | 10 | 20 |
| 5315-269-4080 | 5 | 20 |
| 5315-282-3642 | 10 | 1 |
| 5315-474-4115 | 10 | 19 |
| 5315-501-3668 | 3 | 6 |
| 5315-514-2358 | 10 | 6 |
| 5315-587-8391 | 8 | 30 |
| 5315-587-8396 | 8 | 29 |
| 5315-597-5086 | 4 | 12 |
| | 11 | 1 |

| STOCK NUMBER | FIGURE NO | ITEM NO |
|---------------|-----------|---------|
| 5315-815-1405 | 10 | 18 |
| 5315-819-4501 | 3 | 1 |
| 5315-836-0643 | 5 | 18 |
| 5315-839-0897 | 8 | 26 |
| 5315-839-2327 | 10 | 9 |
| 5315-923-9440 | 8 | 24 |
| 5315-929-0862 | 9 | 1 |
| 5315-981-1254 | 4 | 8 |
| 5315-994-4242 | 3 | 12 |
| 5340-072-5379 | 5 | 3 |
| 5340-904-9303 | 5 | 13 |
| 5340-999-1864 | 4 | 3 |
| 5360-587-8395 | 3 | 14 |

| REFERENCE NUMBER | MFG CODE | FIG NO | ITEM NO |
|------------------|----------|--------|---------|
| MSMS 16562-107 | 96906 | 6 | 2 |
| | | 8 | 6 |
| MS 16562-124 | 96906 | 8 | 26 |
| MS 16562-210 | 96906 | 8 | 31 |
| MS 16562-96 | 96906 | 10 | 1 |
| MS 16562-98 | 96906 | 4 | 12 |
| | | 11 | 1 |
| MS 16562-99 | 96906 | 10 | 6 |
| MS 16997-9 | 96906 | 10 | 12 |
| MS 19059-88 | 96906 | 4 | 10 |
| MS 24665-151 | 96906 | 10 | 18 |
| MS 35336-21 | 96906 | 5 | 15 |
| MS 35649-244 | 96906 | 10 | 11 |
| MS 39086-202 | 96906 | 5 | 22 |
| MS 39086-205 | 96906 | 5 | 18 |
| MS 39086-211 | 96906 | 5 | 20 |
| MS 39086-88 | 96906 | 10 | 9 |
| MS 51923-465 | 96906 | 8 | 24 |
| 11010001 | 19204 | 5 | 21 |
| 11010004 | 19204 | 5 | 24 |
| 11010038 | 19204 | 2 | 1 |
| 11010044 | 19204 | 5 | 17 |
| 11010046 | 19204 | 5 | 4 |
| 11010047 | 19204 | 5 | 3 |
| 11010298 | 19204 | 8 | 17 |
| 11010363 | 19204 | 8 | 1 |
| 11010414 | 19204 | 4 | 3 |
| 11686413 | 19204 | 7 | 4 |
| 11686427 | 19204 | 4 | 19 |
| 11686428 | 19204 | 1 | 3 |
| 1168517 | 19204 | 9 | 6 |
| 11686518 | 19204 | 9 | 7 |
| 11686519 | 19204 | 9 | 4 |
| 11686520 | 19204 | 9 | 3 |
| 11686521 | 19204 | 2 | 9 |
| 11686522 | 19204 | 5 | 16 |
| 11686523 | 19204 | 5 | 14 |
| 11686524 | 19204 | 5 | 13 |
| 11686527 | 19204 | 5 | 25 |
| 11686528 | 19204 | 2 | 5 |
| 5013668 | 19204 | 3 | 6 |
| 5013747 | 19204 | 4 | 11 |

| REFERENCE NUMBER | MFG CODE | FIG NO | ITEM NO |
|------------------|----------|--------|---------|
| 515-2865 | 19204 | 4 | 15 |
| 5546001 | 19204 | 8 | 5 |
| 5546008 | 19204 | 3 | 7 |
| 5546015 | 19204 | 3 | 8 |
| 5564174 | 19204 | 13 | 1 |
| 5910348 | 19204 | 4 | 1 |
| 5910438 | 19204 | 5 | 12 |
| 6008618 | 19204 | 7 | 3 |
| 6008868 | 19204 | 8 | 3 |
| 6008872 | 19204 | 8 | 4 |
| 6008880 | 19204 | 3 | 5 |
| 6008881 | 19204 | 4 | 5 |
| 6008883 | 19204 | 3 | 3 |
| 6009997 | 19204 | 3 | 4 |
| 6008889 | 19204 | 4 | 6 |
| 6008890 | 19204 | 5 | 23 |
| 6146873 | 19204 | 5 | 7 |
| 6544058 | 19204 | 13 | 3 |
| 7266109 | 19204 | 13 | 5 |
| 7266110 | 19204 | 13 | 6 |
| 7267001 | 19204 | 8 | 23 |
| 7267015 | 19204 | 7 | 2 |
| 7267025 | 19204 | 8 | 25 |
| 7267027 | 19204 | 6 | 6 |
| 7267030 | 19204 | 3 | 15 |
| 7267032 | 19204 | 3 | 13 |
| 7267034 | 19204 | 8 | 27 |
| 7267035 | 19204 | 8 | 30 |
| 7267039 | 19204 | 8 | 15 |
| 7267041 | 19204 | 3 | 14 |
| 7267042 | 19204 | 8 | 29 |
| 7267047 | 19204 | 8 | 13 |
| 7267053 | 19204 | 8 | 12 |
| 7267059 | 19204 | 7 | 7 |
| 7267064 | 19204 | 6 | 8 |
| 7267065 | 19204 | 7 | 6 |
| 7267071 | 19204 | 8 | 8 |
| 7267072 | 19204 | 8 | 10 |
| 7267074 | 19204 | 8 | 28 |
| 7267079 | 19204 | 6 | 7 |
| 7267080 | 19204 | 3 | 9 |
| 7267081 | 19204 | 8 | 9 |

| REFERENCE NUMBER | MFG CODE | FIG NO | ITEM NO | REFERENCE NUMBER | MFG CODE | FIG NO | ITEM NO |
|------------------|----------|--------|---------|------------------|----------|--------|---------|
| 7267090 | 19204 | 3 | 2 | 7790824 | 19204 | 10 | 3 |
| 7267172 | 10204 | 8 | 7 | 7790835 | 19204 | 10 | 16 |
| 7267604 | 19204 | 8 | 21 | 7790836 | 19204 | 10 | 7 |
| 7267605 | 19204 | 8 | 22 | 7790837 | 19204 | 10 | 15 |
| 7267754 | 19204 | 13 | 7 | 7790838 | 19204 | 10 | 8 |
| 7274736 | 19204 | 15 | 1 | 7790839 | 19204 | 10 | 13 |
| 7274755 | 10204 | 15 | 3 | 7790840 | 19204 | 10 | 10 |
| 7274757 | 19204 | 15 | 4 | 7790902 | 19204 | 8 | 20 |
| 7274761 | 19204 | 15 | 5 | 7790903 | 19204 | 12 | 5 |
| 7274790 | 19204 | 15 | 6 | 7790990 | 19204 | 3 | 10 |
| 7274799 | 19204 | 15 | 7 | 7790995 | 19204 | 13 | 2 |
| 7312737 | 19204 | 8 | 2 | 7791053 | 19204 | 8 | 16 |
| 7458406 | 19204 | 15 | 8 | 7791101 | 19204 | 10 | 25 |
| 7790183 | 19204 | 1 | 1 | 7791102 | 19204 | 10 | 22 |
| | | 2 | 3 | 7791103 | 19204 | 10 | 24 |
| 7790184 | 19204 | 8 | 32 | 7791104 | 19204 | 10 | 19 |
| 7790185 | | 7 | 8 | 7791106 | 19204 | 10 | 17 |
| 7790186 | 19204 | 7 | 5 | 7791107 | 19204 | 10 | 23 |
| 7790187 | 19204 | 1 | 6 | 7791211 | 19204 | 12 | 4 |
| | | 2 | 8 | 7791237 | 19204 | 12 | 3 |
| 7790188 | 19204 | 8 | 19 | 7791267 | 19204 | 4 | 2 |
| 7790190 | 19204 | 8 | 33 | 7791286 | 19204 | 1 | 4 |
| 7790192 | 19204 | 8 | 11 | | | 2 | 6 |
| 7790195 | 19204 | 1 | 2 | 7791339 | 19204 | 4 | 4 |
| | | 2 | 4 | 7791367 | 19204 | 3 | 1 |
| 7790196 | 19204 | 3 | 11 | 7791415 | 19204 | 12 | 2 |
| 7790300 | 19204 | 8 | 14 | 7791418 | 19204 | 3 | i2 |
| 7790424 | 19204 | 6 | 1 | 7791445 | 19204 | 8 | 18 |
| 7790425 | 19204 | 6 | 5 | 7791578 | 19204 | 7 | 1 |
| 7790426 | 19204 | 6 | 3 | 7791663 | 19204 | 9 | 5 |
| 7790427 | 19204 | 6 | 4 | 7791664 | 19204 | 9 | 1 |
| 7790463 | 19204 | 13 | 4 | 7791667 | 19204 | 9 | 8 |
| 7790493 | 19204 | 13 | 8 | 7791668 | 19204 | 9 | 2 |
| 7790686 | 19204 | 4 | 7 | 7791669 | 19204 | 10 | 20 |
| 7790688 | 19204 | 2 | 2 | 7791670 | 19204 | 10 | 21 |
| 7790692 | 19204 | 4 | 17 | 7791672 | 19204 | 5 | 19 |
| 7790693 | 19204 | 4 | 13 | 7791673 | 19204 | 5 | 6 |
| 7790695 | 19204 | 4 | 8 | 7791674 | 19204 | 5 | 1 |
| 7790697 | 19204 | 4 | 9 | 7791676 | 19204 | 5 | 2 |
| 7790698 | 19204 | 4 | 16 | 7791677 | 19204 | 5 | 5 |
| 7790699 | 19204 | 4 | 14 | 7791678 | 19204 | 5 | 8 |
| 7790700 | 19204 | 4 | 18 | 7791682 | 19204 | 5 | 9 |
| 7790769 | 19204 | 12 | - | 7791683 | 19204 | 5 | 10 |
| 7790786 | 19204 | 11 | 2 | 7792062 | 19204 | 5 | 11 |
| 7790808 | 19204 | 12 | 1 | 7792846 | 19204 | 10 | 4 |
| 7790820 | 19204 | 10 | 2 | 7792847 | 19204 | 10 | 26 |
| 7790821 | 19204 | 10 | 14 | 7799705 | 19204 | 14 | - |
| 7790822 | 19204 | 10 | 5 | 7799723 | 19204 | 15 | 2 |

By Order of the Secretary of the Army:

Official:

VERNE L. BOWERS
Major General, United States Army
The Adjutant General

BRUCE PALMER, JR.
General, U. S. Army
Acting Chief of Staff

Distribution:

To be distributed in accordance with DA Form 12-40 (qty rqr block no. 141) Direct and General Support Maintenance requirements for Rifle, 7.62-MM, M14.

RECOMMENDED CHANGES TO EQUIPMENT TECHNICAL PUBLICATIONS



THEN... JOT DOWN THE DOPE ABOUT IT ON THIS FORM, CAREFULLY TEAR IT OUT, FOLD IT AND DROP IT IN THE MAIL!

SOMETHING WRONG WITH THIS PUBLICATION?

FROM: (PRINT YOUR UNIT'S COMPLETE ADDRESS)

DATE SENT

PUBLICATION NUMBER

PUBLICATION DATE

PUBLICATION TITLE

BE EXACT... PIN-POINT WHERE IT IS

PAGE NO.

PARA-GRAPH

FIGURE NO.

TABLE NO.

IN THIS SPACE TELL WHAT IS WRONG AND WHAT SHOULD BE DONE ABOUT IT:

TEAR ALONG PERFORATED LINE

PRINTED NAME, GRADE OR TITLE, AND TELEPHONE NUMBER

SIGN HERE:

DA FORM 2028-2
1 JUL 79

PREVIOUS EDITIONS ARE OBSOLETE.

P.S.—IF YOUR OUTFIT WANTS TO KNOW ABOUT YOUR RECOMMENDATION MAKE A CARBON COPY OF THIS AND GIVE IT TO YOUR HEADQUARTERS.

PIN: 026381-000